



FF1077SSIM



59.25" x 23.63" x 25.25" (H x W x D)

9.8 cu.ft. frost-free refrigerator-freezer with icemaker in 24" width, with stainless steel doors and black cabinet

Highlights:

Factory installed icemaker provides a steady supply of ice

True frost-free operation saves you maintenance by preventing icy buildup

24" width is ideal for smaller kitchen spaces

Deluxe interior with glass shelves and gallon door storage

Product Features:

Frost-free operation	No-frost system simplifies maintenance
Thin-line design	Limited space is no problem for our thin-line models, designed specifically for those hard-to-fit spots
Large capacity	9.8 cu.ft. interior to meet all your storage needs
Factory installed icemaker	Forget the plastic trays and enjoy the convenience of ready-made ice in your freezer
Adjustable glass shelves	Rearrange your refrigerator space to accommodate all shapes and sizes or remove shelves for a simple clean-up
Door storage	Store tall bottles and condiments right on the door for convenient access
Gallon door storage	Door storage includes a gallon-sized shelf
Fruit and vegetable crisper	Get the longest life and best taste out of produce by storing it in a convenient slide drawer
Full freezer shelf	Spill-proof glass shelf for easier storage in the freezer compartment



SUMMIT APPLIANCE DIVISION FELIX STORCH, INC.

770 Garrison Avenue, Bronx, NY 10474 USA TEL 718-893-3900 FAX 844-478-8799 info@summitappliance.com  www.summitappliance.com



FF1077SSIM Specifications:

Overview	
Height	59.25"
Height to Hinge Cap	59.75"
Width	23.63"
Width with Door Open	24.13"
Depth	25.25"
Depth with door at 90°	47.0"
Capacity	9.8 cu.ft.
Defrost Type	Frost-Free
Door	Stainless Steel
Cabinet	Black
US Electrical Safety	CSA
Canadian Electrical Safety	CSA-C
Energy Usage/Year	411.0kWh/year
Amps	2.5
Voltage/Frequency	115 V AC/60 Hz
Weight	125.0 lbs.
Shipping Weight	160.0 lbs.
Parts & Labor Warranty	1 Year
Compressor Warranty	5 Years
Refrigerator-Freezer	
Door Swing	RHD
Reversible	Yes
Crisper Qty	1
Crisper Finish	Transparent
Crisper Cover	Glass
Refrigerator - Interior Height	34.5"
Refrigerator - Interior Width	18.75"
Refrigerator - Interior Depth	20.75"
Refrigerator - Shelf Type	Glass
Refrigerator - Shelf Qty	2
Refrigerator - Full Door Shelves	1
Refrigerator - Half Door Shelves	2
Freezer - Interior Height	15.5"
Freezer - Interior Width	17.75"

Freezer - Interior Depth	15.5"
Freezer - Shelf Type	Glass
Freezer - Shelf Qty	1
Freezer - Full Door Shelves	2
Adjustable Shelves	Yes
Gallon Door Storage	Yes
Interior Light	Yes
Thermostat Type	Dial
Fan Type	Interior
Refrigerant Type	R600a
Refrigerant Amount	1.69 oz.
High Side PSI	300.0
Low Side PSI	120.0
Level Legs	2
Compressor Step Height	8.88"
Compressor Step Width	18.75"
Compressor Step Depth	7.0"

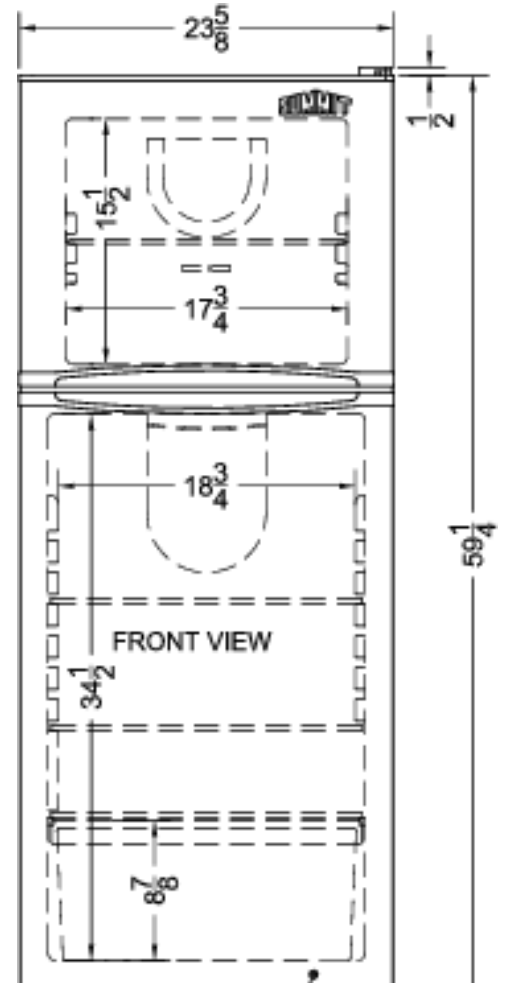
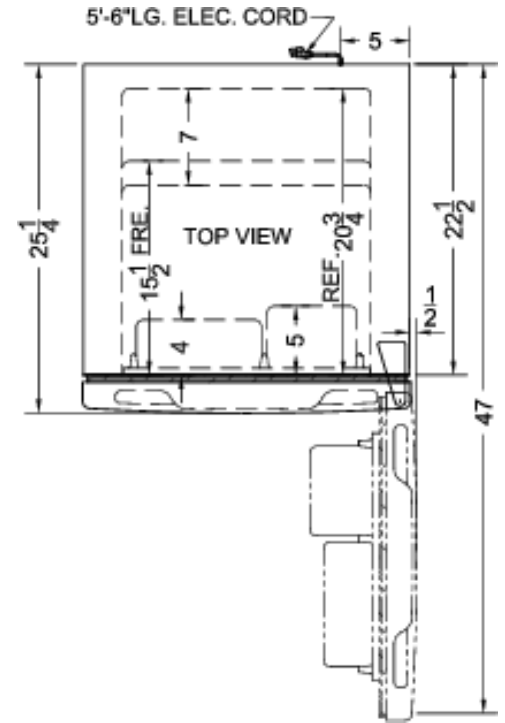

SUMMIT APPLIANCE DIVISION FELIX STORCH, INC.

770 Garrison Avenue, Bronx, NY 10474 USA TEL 718-893-3900 FAX 844-478-8799 info@summitappliance.com www.summitappliance.com