

# Viking Installation Guide



Viking Range Corporation

111 Front Street

Greenwood, Mississippi 38930 USA

(662) 455-1200

For product information,

call 1-888-VIKING1 (845-4641)

or visit the Viking Web site at

[vikingrange.com](http://vikingrange.com)

V27FTW/V30FTW/V36FTW  
Professional Warming Drawer  
Accessory Flush Mount Kit  
For Use with VEWD527/530/536 Series

## Preparing Drawer for Flush Mount Trim

1. Remove drawer from the unit.

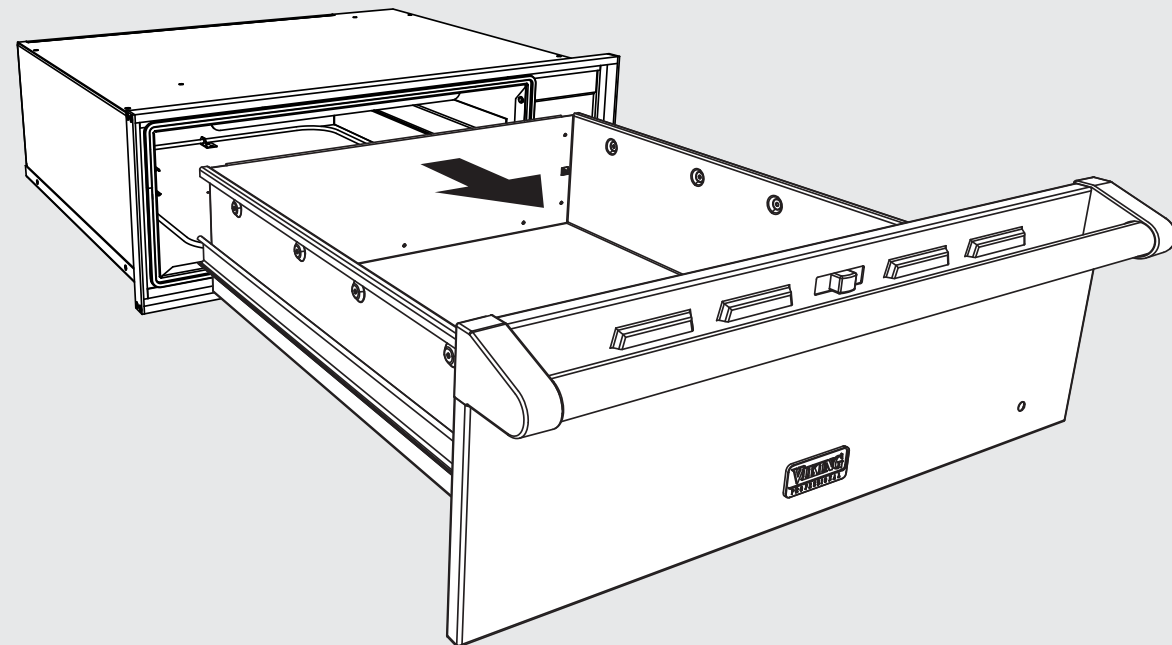

## Preparing Drawer for Flush Mount Trim

2. Remove 6 screws and then remove gasket bracket.

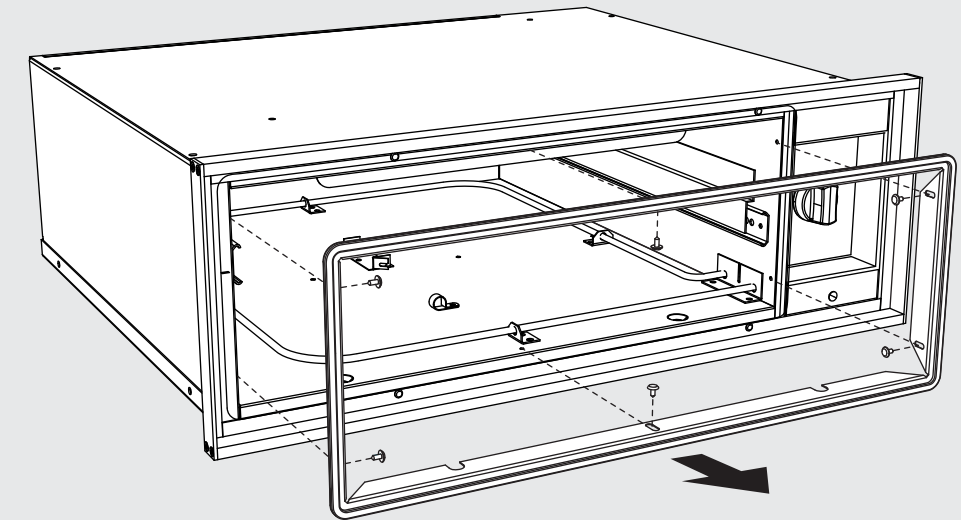

3. Remove 4 screws and then remove standard trim.

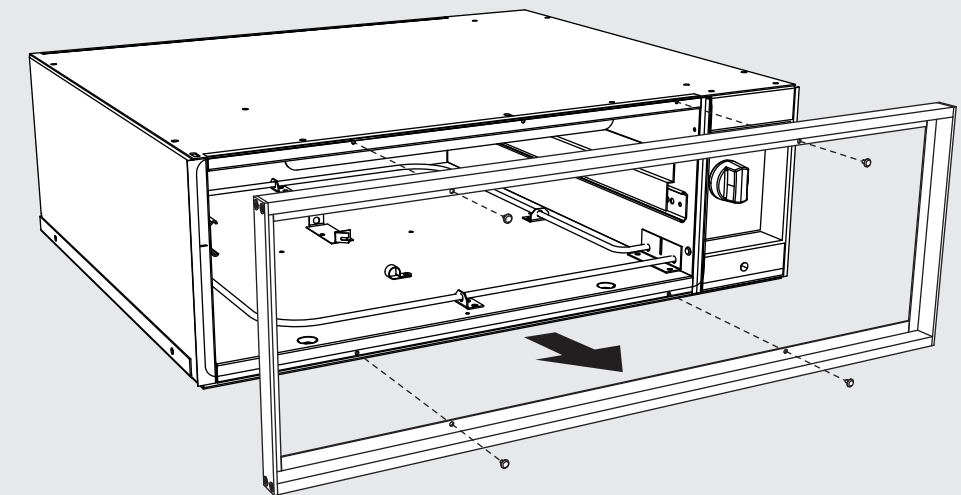

## Installing Flush Mount Trim

4. Place flush trim on unit. Screw in using the same 4 screws and holes that secured the standard trim.

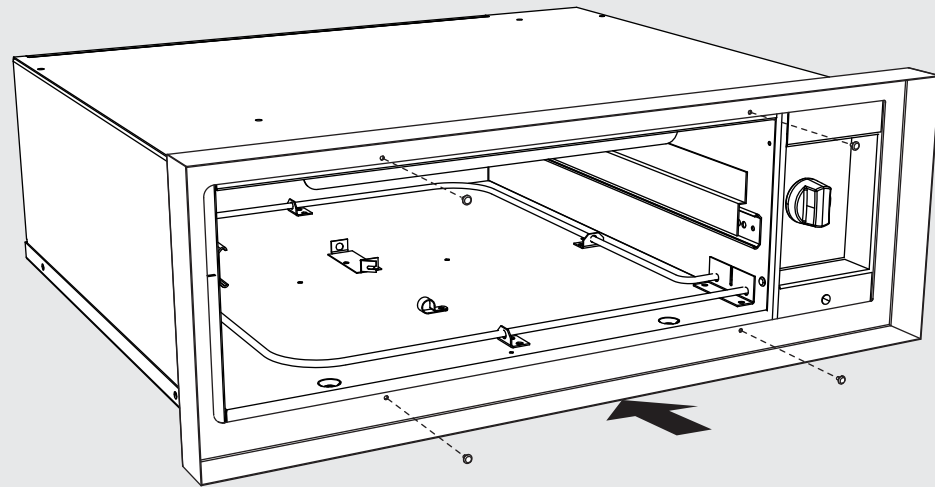

5. Replace gasket bracket on the unit. Screw in using 6 screws.

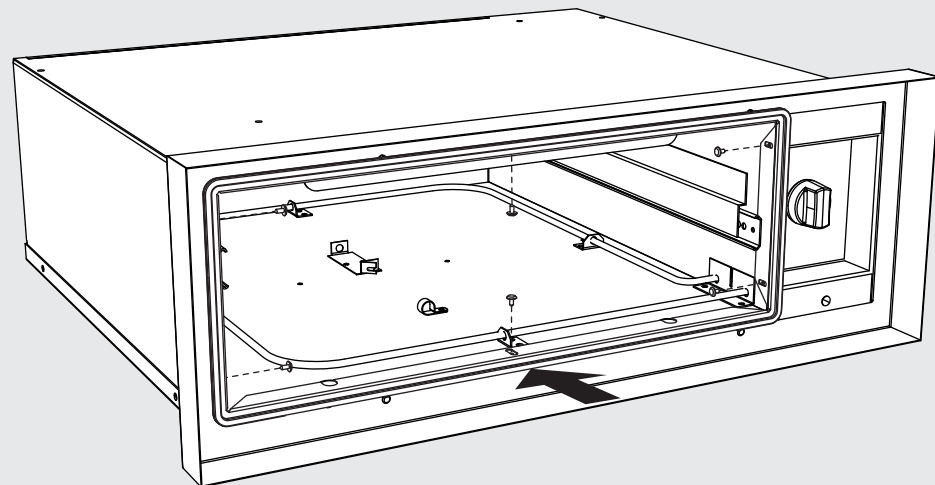

## Finishing Flush Mount Trim Install

6. Re-install drawer into unit.

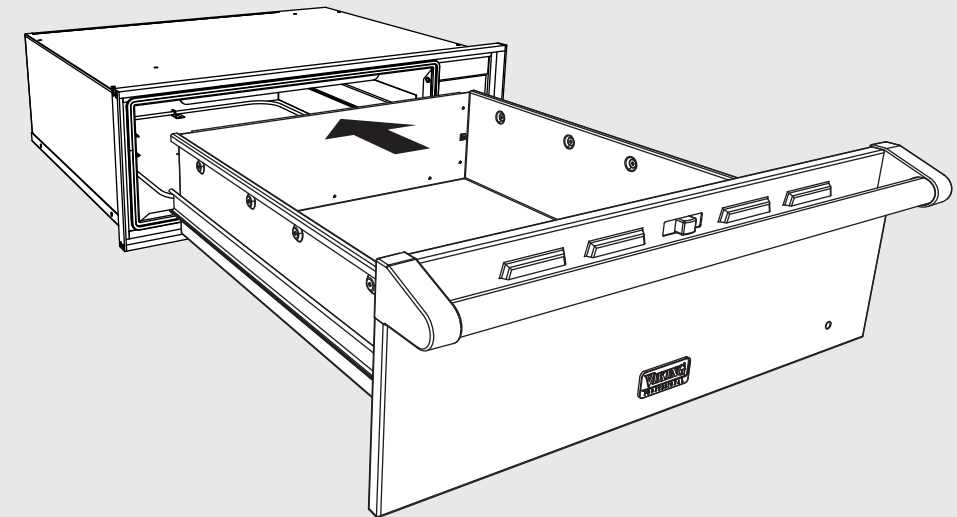

7. Flush trim is properly installed.

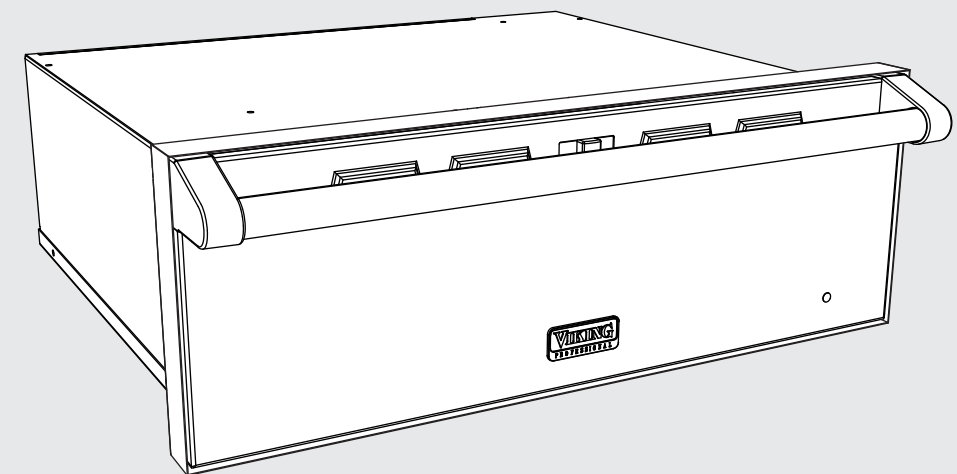

# Preparing the Cutout

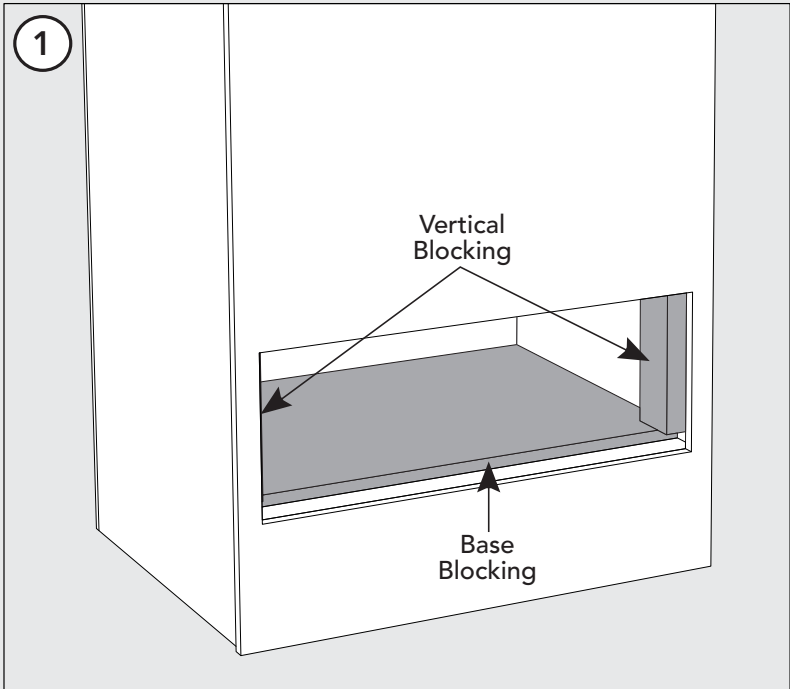

Install the vertical blocking and base blocking into the cutout area.

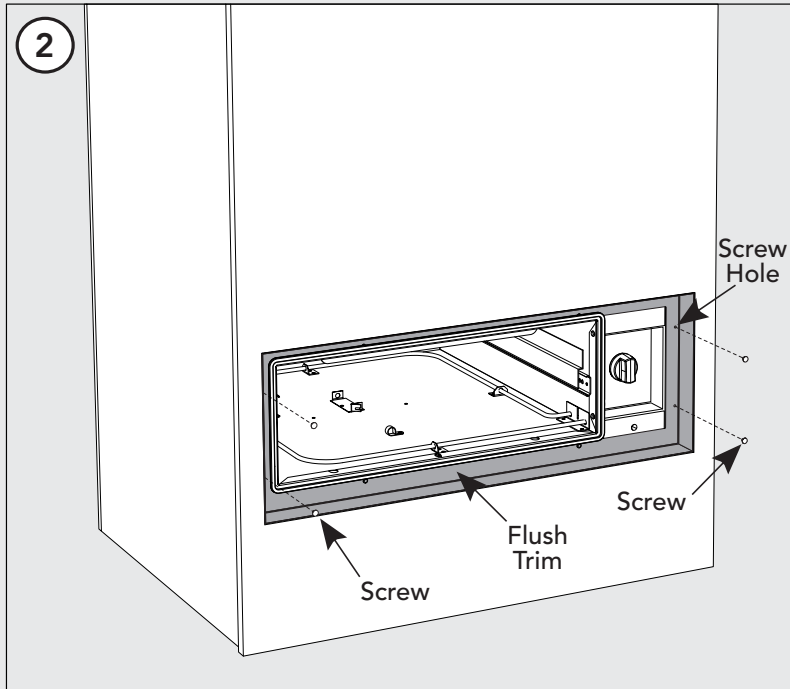

After installing the flush kit on the warming drawer, push the unit into the cutout. The flush kit will rest against the vertical blocking. Screw the flush trim to the vertical blocking with 4 screws as shown above.

# Securing Inside the Cutout (side view)

LEGEND	
	Blocking
	Cabinet Fronts
	Cabinet Cross Section

<b>B</b>	1-7/8" (4.8 cm)
<b>FLUSH CUTOUT HEIGHT</b>	
<b>C</b>	27" - 10-5/8" (27.0 cm) 30" - 10-5/8" (27.0 cm) 36" - 10-5/8" (27.0 cm)
<b>D</b>	3/4" (1.9 cm)
<b>E</b>	3" (7.6 cm)
<b>FLUSH CUTOUT DEPTH</b>	
<b>F</b>	27" - 25-3/4" (65.4 cm) 30" - 25-3/4" (65.4 cm) 36" - 25-3/4" (65.4 cm)

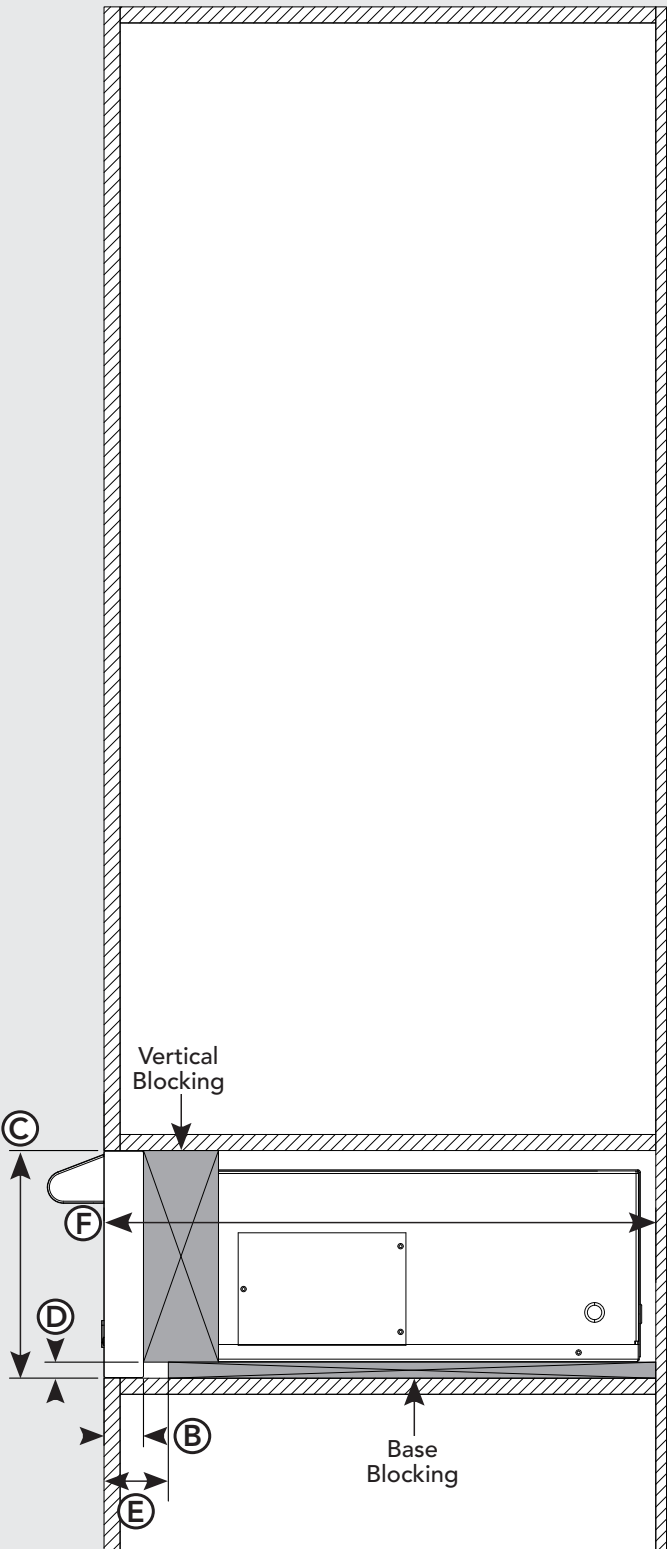

# Securing Inside the Cutout (top view)

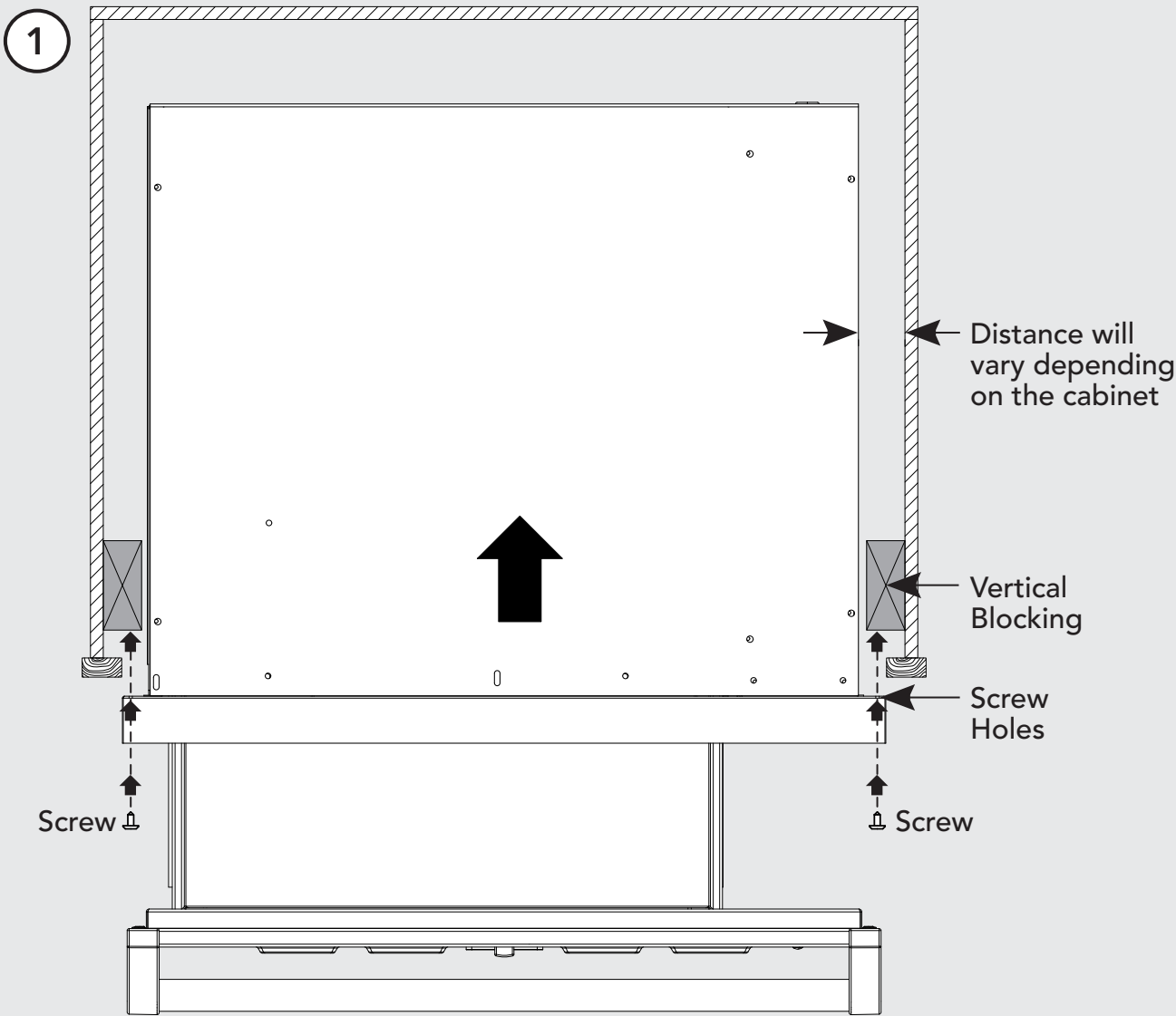

LEGEND	
	Blocking
	Cabinet Fronts
	Cabinet Cross Section

# Securing Inside the Cutout (top view)

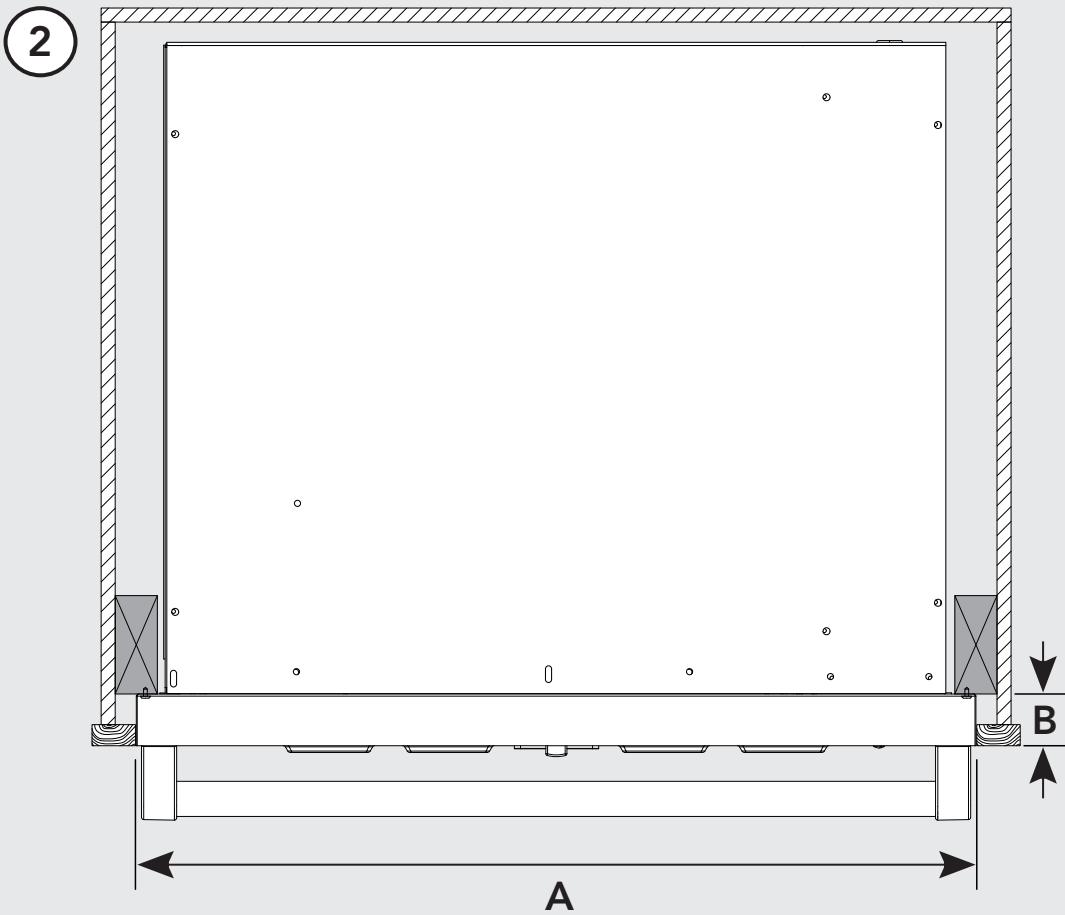

FLUSH CUTOUT WIDTH	
A	27" - 26-15/16" (68.4 cm) 30" - 29-15/16" (68.4 cm) 36" - 35-5/8" (90.5 cm)
B	1-7/8" (4.8 cm)

