

# C60

34.63" x 59.0" x 23.63" (H x W x D)

60" wide all-in-one kitchenette with two cast iron burners, a cycle defrost refrigerator-freezer, sink, and storage cabinets

## Highlights:

- Two easy-to-clean cast iron burners with 110V operation
- Includes SUMMIT CT67 refrigerator-freezer with deluxe interior
- Perfect in small quarters or as a temporary kitchen
- Two large storage cabinets provide plenty of options for dry goods



Two electric burners	Solid cast iron construction lets you boil and fry with no mess on no-spill surfaces
One piece stainless steel countertop	Easy to clean and built to last
Sink and faucet	Stainless steel sink comes ready to wash
110V Operation	Just plug in and cook
Storage compartments	Two large cabinets with center shelves lets you store dry goods behind a door
Refrigerator-freezer included	Includes SUMMIT CT67, a refrigerator-freezer with dual evaporator cooling, adjustable glass shelves, a crisper, and more
Alternate refrigerators and freezers available	Replace the CT67 with any similarly sized SUMMIT refrigerator (such as the FF7), refrigerator-freezer (including the CT66) or all-freezer (including the frost-free SCFF55)
Ships fully assembled	Base model comes in one box. Just slide the refrigerator-freezer into its opening and plug in
100% CFC free	Environmentally friendly design without ozone-damaging chemicals

Specifications:

Height	34.63"
Width	59.0"
Depth	23.63"
Capacity	5.1 cu.ft.
Interior Height 1	19.5"
Interior Width 1	20.5"
Interior Depth 1	17.0"
Interior Height 2	5.0"
Interior Width 2	19.0"
Interior Depth 2	11.5"
Comp Step Height	7.0"
Comp Step Width	20.5"
Comp Step Depth	5.0"
Shipping Weight	320.0 lbs.
Weight	295.0 lbs.
Amps	20.0
Voltage/Frequency	115 V AC/60 Hz
US Electrical Safety	UL
Reversible	Yes
Door Swing	RHD
Crisper Quantity	1
Shelf Quantity	3
Adjustable Shelf	true
Shelf Type	Glass
Crisper Cover Type	Glass
Crisper Finish	Transparent
Full Door Shelf Quantity	3
Defrost Type	Cycle
Number of Burners	2
Burner Temperature Control	Dial
Heating Type	Radiant
Light	true
Thermostat Type	Dial
Condensor Location	Rear of Unit
High Side PSI	285.0
Low Side PSI	70.0
Freon Oz	2.6
Freon Type	R134a
Level Legs Quantity	2
Parts/Labor Warranty	1 Year

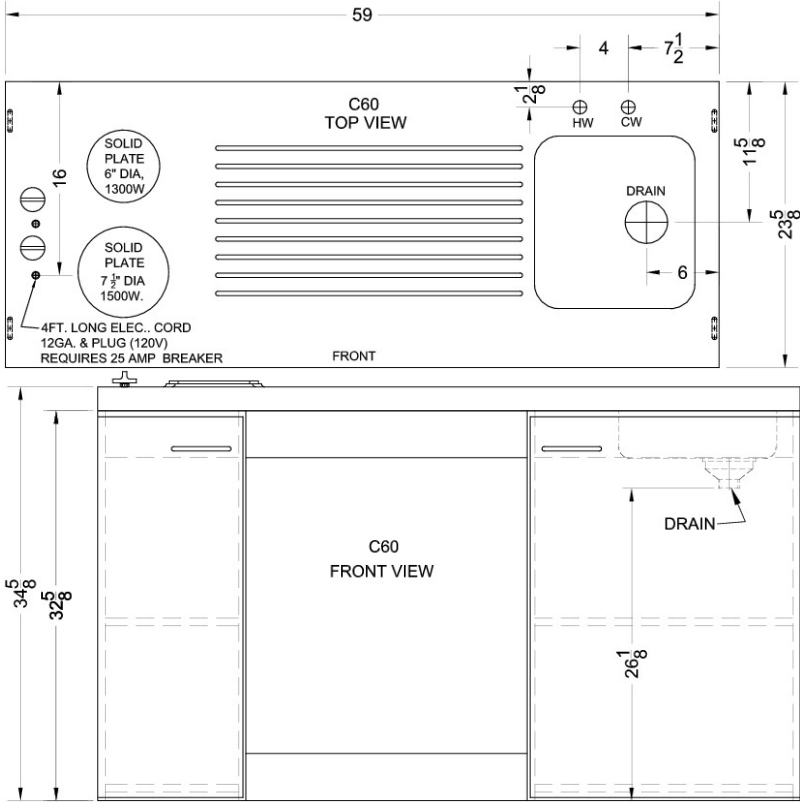

Summit Appliance Division, Felix Storch, Inc.  
770 Garrison Ave • Bronx, NY 10474  
Phone: 718-893-3900 • Fax: 718-842-3093  
Email: [info@summitappliance.com](mailto:info@summitappliance.com)