

Discovery™ iQ Wall Oven

Models: DY0130, DY0230, DYOV130 and DYOV230

Thank you for purchasing the Dacor Discovery™ iQ wall oven. In order for you to get the most from your oven and to take advantage of the Android operating system's capabilities, we want to ensure that your oven has been properly set up and connected to your wireless network.

These steps will help guide you through that process. Since there are many potential screens that might be displayed on your oven after installation, we have described what actions to take based on each screen. Of course, if you have any problems, please contact the Dacor Customer Service Team at (800) 793-0093.

Instructions:



WARNING - This appliance must be installed and grounded according to the included installation instructions prior to use.

STEP 1 When power to the oven is turned on for the first time, the setup program will run. It begins with WiFi setup. If the WiFi setup screen appears on the touch display, skip to step 8 of this guide. If the oven home screen appears, go to step 6 of this guide to restart the setup process. If any other screen appears on the display, go to step 2, on the following page, to restart the setup process.



WiFi Setup Screen - Text in gray area will vary.
Go to step 8.



Oven Home Screen, Double Oven - Go to step 6.



Oven Home Screen, Single Oven - Go to step 6.

Discovery iQ Wall Oven

STEP 2 Select the screen that currently appears on the touch display from the pictures shown. Perform the instructions below the picture to perform the setup restart process.



WiFi keyboard - Touch cancel, go to step 8.

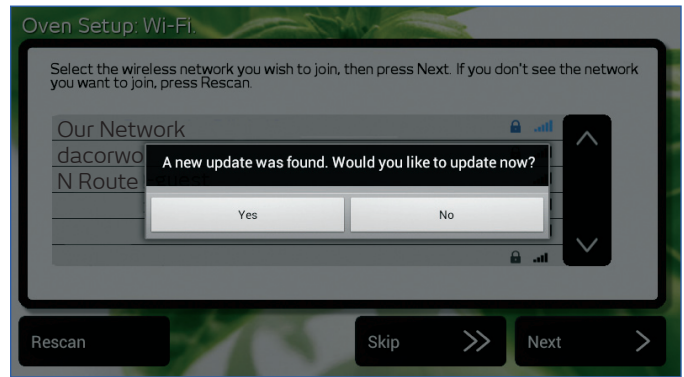

Upgrade Screen - Touch No, go to step 8.

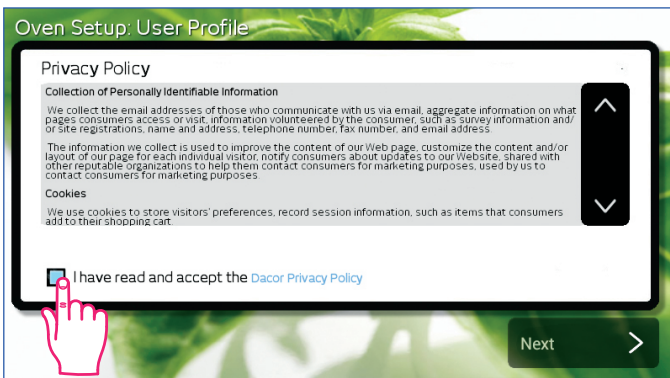

Privacy Policy - Touch box, Next, then go to step 4.

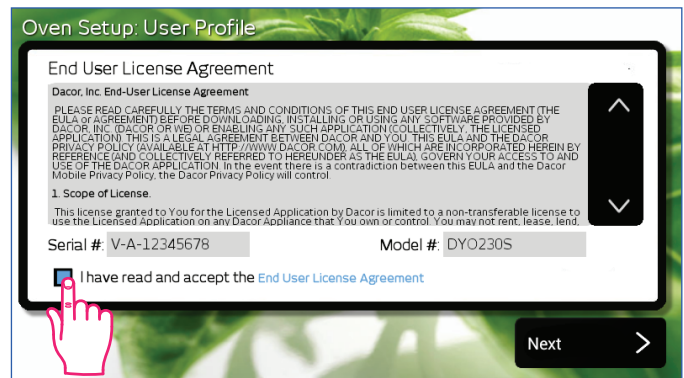

EULA - Touch box, Next, then go to step 5.

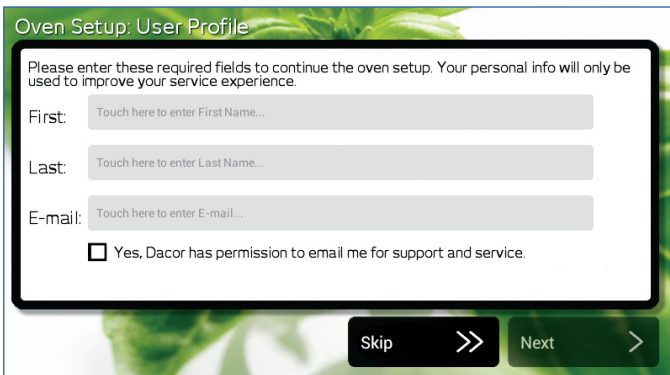

Name Screen - Go to step 5.

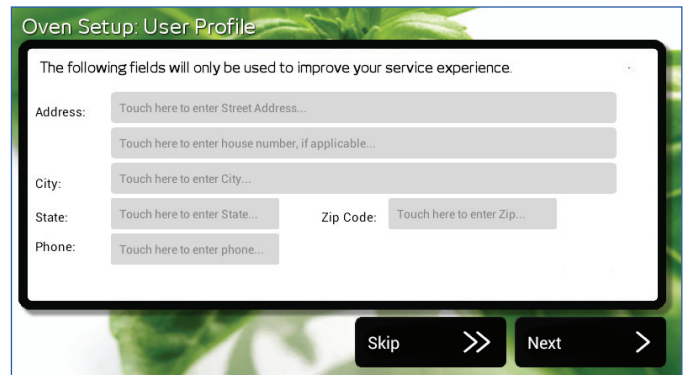

Address Screen - Go to step 5.

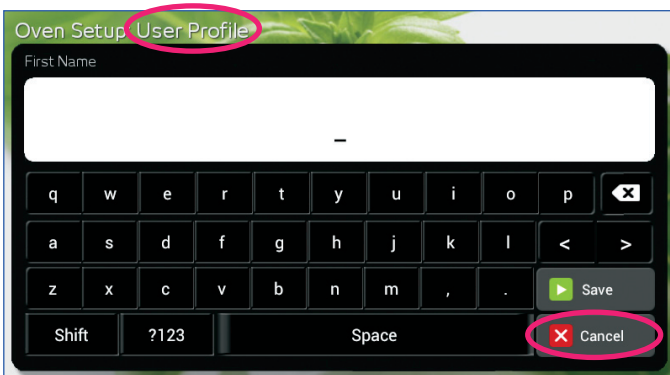

Profile keyboard - Go to step 5.

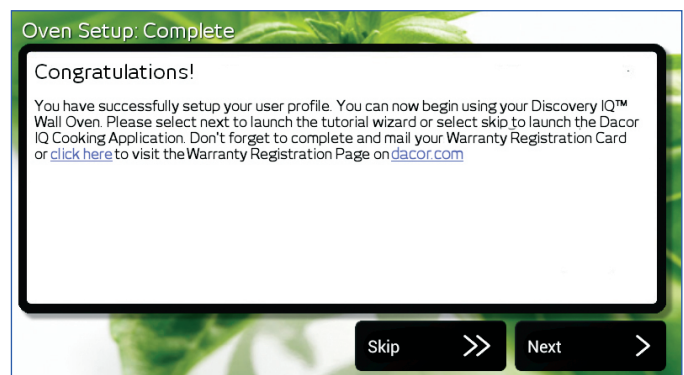

Congratulations Screen - Go to step 5.

Quick Start Guide

STEP 3 On the *Privacy Policy* screen, touch the check box at the bottom left. Touch **Next**.

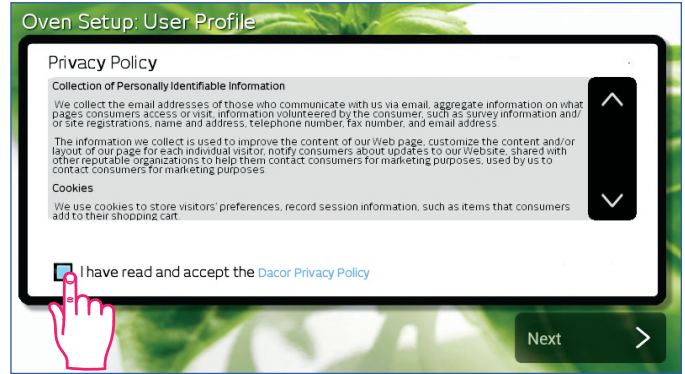

STEP 4 On the *End User License Agreement* screen, touch the check box at the bottom left. Touch **Next**.

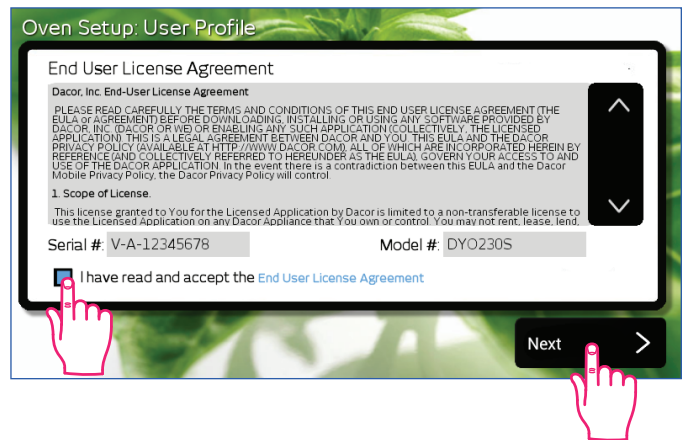

STEP 5 Touch **Skip** on all of the following screens, until the oven home screen appears on the display.

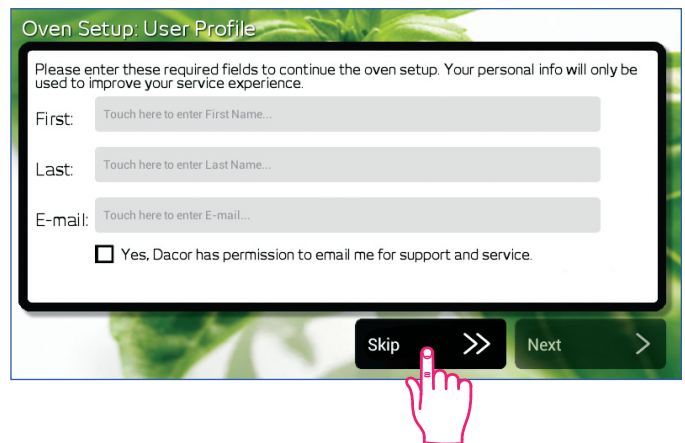

STEP 6 Touch **Oven Preferences** on the oven home screen.



**Oven Home Screen -
Double Oven shown.**

Discovery iQ Wall Oven

STEP 7 The **Oven Preferences** menu will appear. Use the down (∨) arrow until **Oven Setup** appears on the display. Touch **Oven Setup**. It may take 30 to 60 seconds for all of the available wireless networks to appear on the display.

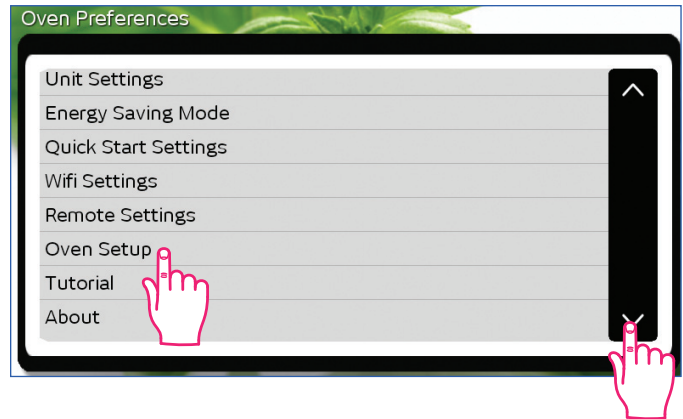

STEP 8 Touch to select your wireless network, then touch **Next**. If you do not have a wireless network, touch **Skip**.

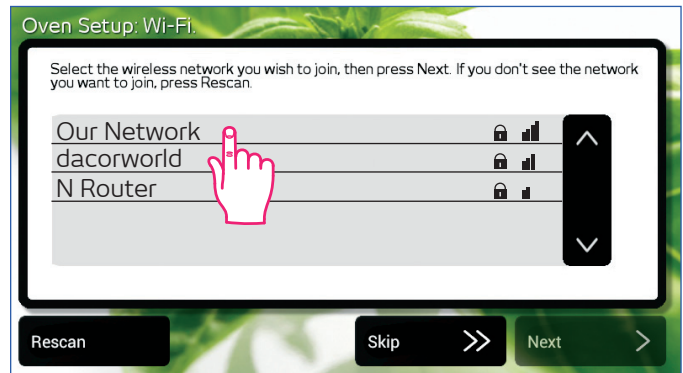

STEP 9 If the wireless network selected has a password, a keyboard will appear on the display. Touch the keys on the display to enter the password, then touch **Join**.

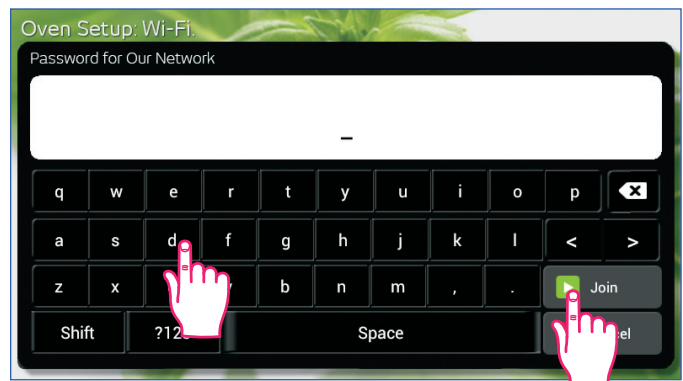

STEP 10 The oven will check for updates to the system software. If the "Would you like to update now?" prompt appears on the display, touch **Yes** and wait for the software to update. Follow the prompts on the display. After the update is completed, the display will return to the Wifi setup display (shown in step 8).

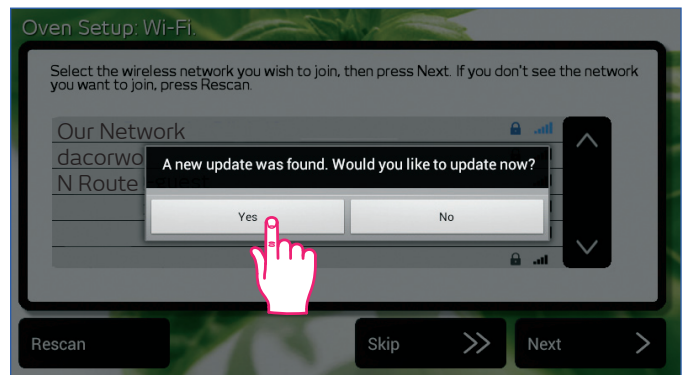

STEP 11 Touch **Next**.

Quick Start Guide

STEP 12 Read the *Privacy Policy* screen, then touch the check box at the bottom left, then touch **Next**.

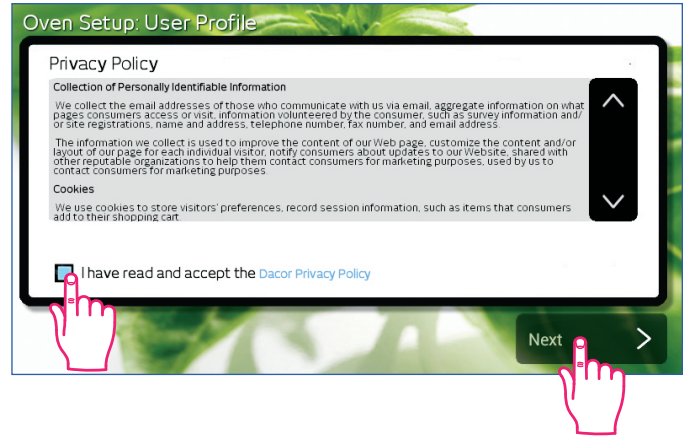

STEP 13 Read the *End User License Agreement* screen, then touch the check box at the bottom left, then touch **Next**.

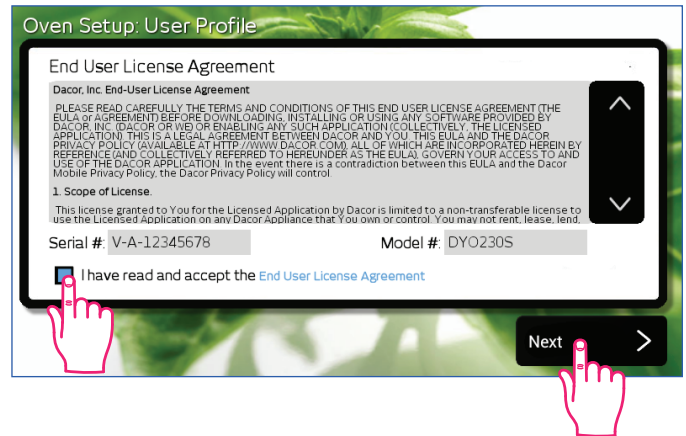

STEP 14 Touch the gray area next to **First** on the name screen.

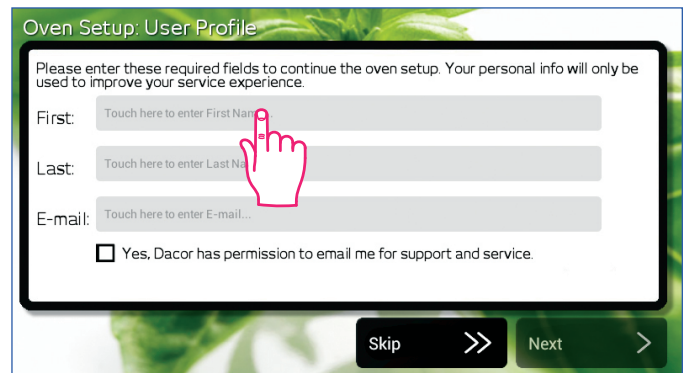

STEP 15 The keyboard screen will appear. Enter your first name using the keys on the screen, then touch **Save**.

STEP 16 Repeat steps 14 and 15 for your last name and E-mail sections on the name screen, then touch **Next**. Note: E-mail address is optional.

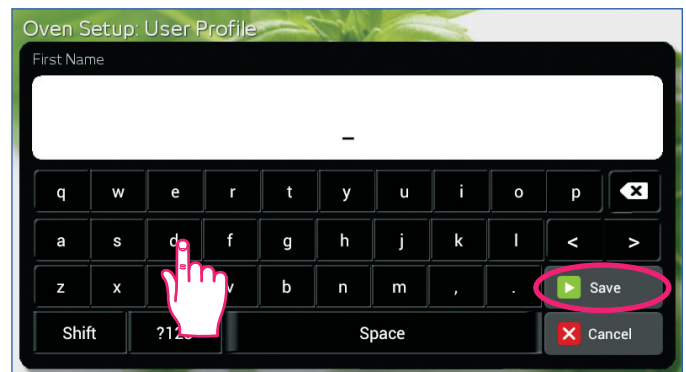

Discovery iQ Wall Oven

STEP 17 Touch the gray area next to **Address** on the address screen.

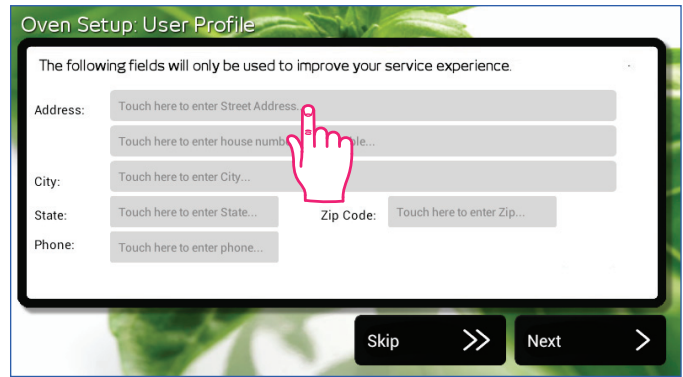

STEP 18 Enter your address using the keys on the keyboard screen, then touch **Save**.

STEP 19 Repeat steps 17 and 18 for your remaining sections on the address screen, then touch **Next**.

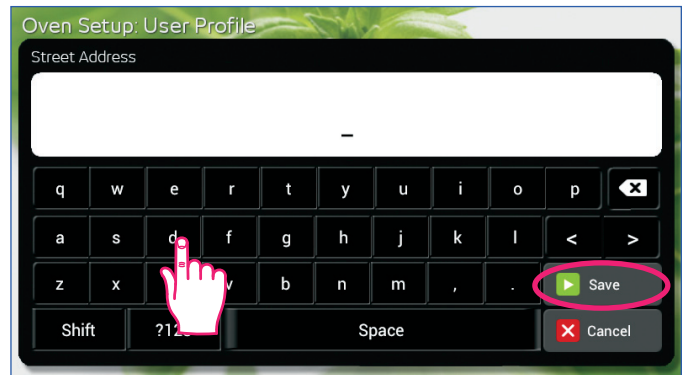

STEP 20 When the Congratulations screen appears, Dacor recommends that you touch **Click here** to register the warranty for your oven.

STEP 21 Touch **Next**. Oven setup is complete.

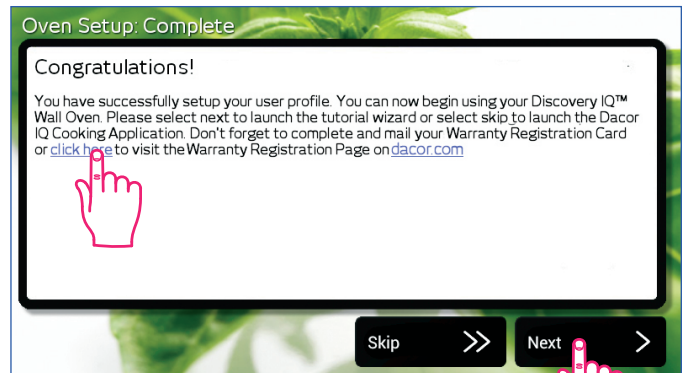



Dacor.com