

30" 5.0 Cubic Foot Double True European Convection Oven

HCW3285AES



Product image does not represent final photography.

Signature Features

Stainless Steel Finish

Features a clean, modern aesthetic that elevates any kitchen

Upper Oven with True European Convection

Upper oven includes a rear fan and a third 2,500-watt heating element to distribute hot air throughout the oven for faster, more even baking

Sabbath Mode

Designed to disable functions in accordance with Shabbat observing practices

2,000W Concealed Bake Element

Sits beneath a smooth surface for easier cleanup

Available Q3 2016

Unit Specifications

Width	29 7/8 "
Depth	23 1/2"
Height	51 3/16"
Weight	269 lb.
UPC	688057374413

More Easy-To-Use Features

- Halogen Interior Lighting
- Seven Cooking Modes
 - Bake, Broil, Warm, Proof, Convection
 - Bake, Convection Broil, Convection Roast
- Convection Recipe Conversion
- TFT Display
- Bread Proofing
- Glass-Touch Electronic Controls
- Two Racks with Four Possible Positions Per Oven
- Enameled Grill Set Included

Warranty

- 2 Year Warranty (Parts and Labor)

Available Finishes



Stainless Steel

Letter	Cutout Dimension (in.)	In Cabinet
A	Width	28 5/8"
B	Height	50 1/4"
C	Depth	24"
D	Top of Cutout to Bottom of Upper Cabinet Door	11/2"
E	Bottom of Cutout to Floor (recommended)*	14 3/4" *
F	Bottom of Cutout to Top of Cabinet Door	11/2"
G	Overlap of Oven with Sides of Cutout	11/16"

Overall Packaging Details

Packaging	lb./in.
Gross Weight	284 lb.
Dimensions	W 33 5/8" D 30 1/2" H 33 5/8"

Power Requirements

Electrical Rating	208/240V, 60Hz
-------------------	----------------

Product Technical Illustration

Double Oven - Installed in Cabinet

Electrical Junction Box Location
NOTE: Junction box may be located in adjacent cabinet

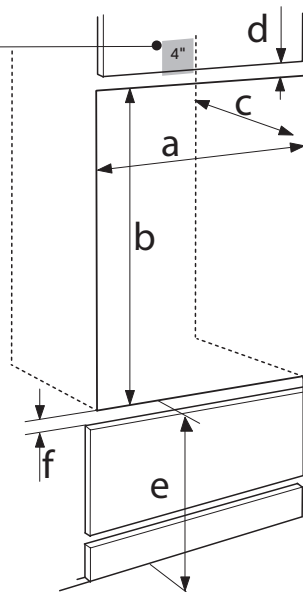

*Bottom of Cutout to Floor (acceptable) 4" to 14 3/4"

General Appliance Information

Please read all installation details and instructions before use.

Contact Us

For questions regarding this product please refer to our website at haieramerica.com or call our customer service center at 877-337-3639.

