

FF73

43.0" x 19.0" x 22.5" (H x W x D)

ENERGY STAR qualified two-door refrigerator-freezer with automatic defrost in ADA compliant height

Highlights:

- ENERGY STAR qualified performance ensures annual savings
- Two-door design for convenience and efficiency in compact size
- Adjustable glass shelves and door racks offer storage convenience
- 43.5" height for select ADA compliant applications



ENERGY STAR qualified	Rated by the DOE to perform with more efficiency than federal standards require, saving your unit energy and you on higher utility costs
Reversible doors	Keep your options flexible with reversible doors that are easy to switch when your arrangement changes
Adjustable glass shelves	Rearrange your refrigerator space to accommodate all shapes and sizes or remove shelves for a simple clean-up
Door storage	Two half racks include one designed to store a tall 2-liter bottle
Can dispenser	Unique door rack lets you store cans securely for easy access
Clear crisper	Get the longest life and best taste out of produce by storing greens in a convenient slide drawer
Full freezer shelf	Wire shelf with two position options
Adjustable thermostat	Manage the interior temperature with ease and accuracy
Automatic defrost	No-frost operation for minimum user maintenance
ADA compliant	Unique 43.5" height offers added accessibility

FF73 Specifications:

Height	43.0"
Width	19.0"
Depth	22.5"
Capacity	4.3 cu.ft.
Interior Height 1	24.75"
Interior Width 1	15.25"
Interior Depth 1	17.5"
Interior Height 2	10.0"
Interior Width 2	15.25"
Interior Depth 2	12.5"
Comp Step Height	7.75"
Comp Step Width	15.25"
Comp Step Depth	6.0"
Shipping Weight	100.0 lbs.
Weight	75.0 lbs.
Canadian Electrical Safety	ETL-C
US Electrical Safety	ETL
Voltage/Frequency	115 V AC/60 Hz
Energy Usage/Year	359.0 kWh/year
Amps	1.5
Reversible	Yes
Door Swing	RHD
Crisper Quantity	1
Shelf Quantity	2
Adjustable Shelf	true
Shelf Type	Glass
Crisper Cover Type	Glass
Crisper Finish	Transparent
Full Door Shelf Quantity	1
Half Door Shelf Quantity	2
Can Storage	true
Defrost Type	Automatic
Depth with door at 90°	39.25"
Height to Hinge Cap	43.38"
Fan Type	Interior
Thermostat Type	Dial
Refrigerant Type	R600a
Low Side PSI	120.0
Freon Oz	1.66
Level Legs Quantity	2
High Side PSI	300.0
Parts/Labor Warranty	1 Year
Compressor Warranty	5 Years

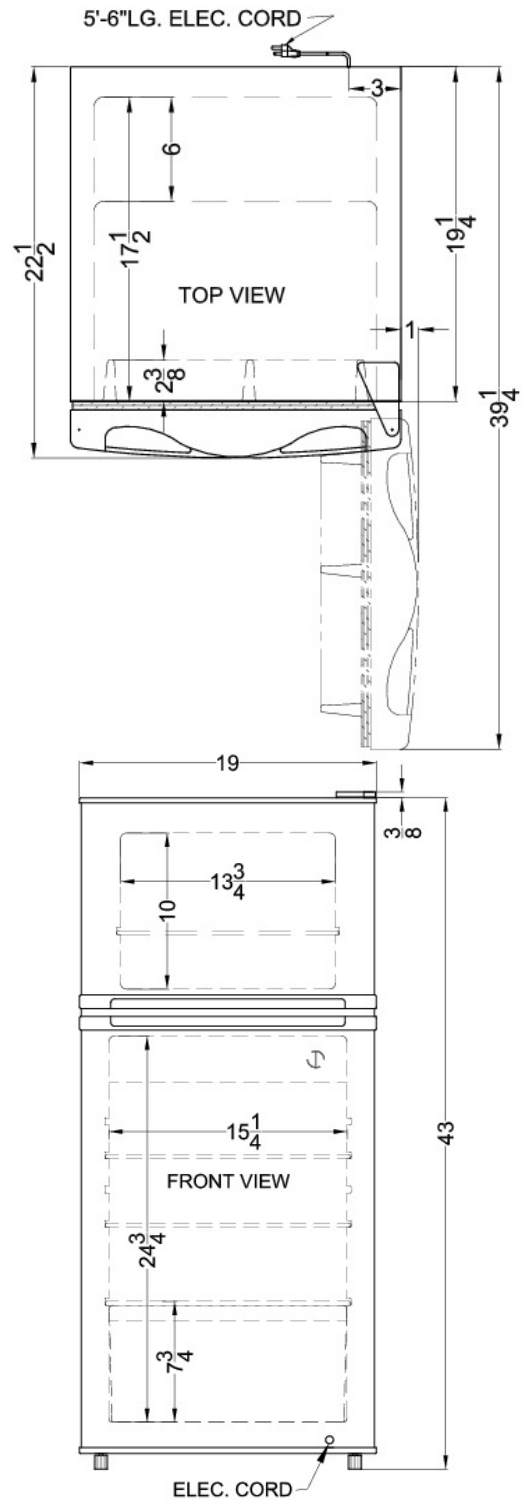

Summit Appliance Division, Felix Storch, Inc.
 770 Garrison Ave • Bronx, NY 10474
 Phone: 718-893-3900 • Fax: 718-842-3093
 Email: info@summitappliance.com