

PRELIMINARY



FRIEDRICH

1883

DUCTLESS SPLIT SYSTEMS

**ALL NEW LINE
FOR 2014**



THE EXPERTS IN ROOM AIR CONDITIONING

NEW, High Efficiency Line of Ductless Systems

Three indoor unit types.



WALL-MOUNTED
Cool only and heat pump models



CEILING CASSETTE
Heat pumps



CONCEALED DUCT
Heat pumps

All of the advantages of ductless systems and Friedrich quality.

ENERGY STAR® qualified models

All Friedrich ductless models exceed the federal 13.0 SEER requirements. And 60% of our models have ratings ranging from 19.0 to 25.0 SEER. Nine models are ENERGY STAR® qualified with EERs up to 14.0.

Inverter variable capacity advantages

Inverter technology allows each system to adjust capacity and cooling output to provide only the amount of cooling needed at a given time. For example, an 18000 Btu system will operate even more efficiently at 15500 Btu or less if that's all that's needed, reducing energy consumption and improving comfort.

Ultra quiet cross-flow fan

The cross-flow design of the indoor fan creates an ultra quiet, yet powerful air flow into the room.

Optimized airflow

The indoor unit's 4-way air swing quickly disperses cool air to all four corners of the room to provide comfort throughout the room within a few minutes. The 'Air Burst' feature moves air at an even higher speed for rapid cooling.

Low vibration, twin rotary compressors

Friedrich's twin rotary compressors have a unique design that reduces vibration for reduced sound levels outdoors.

Zero duct loss

The DOE reports that ducted systems lose an average of 25-40% in performance due to leaks, cracks or disconnections in ductwork. No ductwork means that ductless systems do not experience duct loss, saving energy and money.

Zone cooling flexibility

Independently condition up to (4) separate zones using only a single outdoor unit. Achieve the ultimate in comfort and energy control by cooling or heating only the zones that are in use. And, because each zone is independent of the others, comfort settings can vary.

No dirty air ducts*

Now there's no need to clean dirty air ducts that can harbor dust, germs and allergens that are eventually blown into your home or office.

Inverter technology lets you reach the desired temperature faster, maintain temperature and humidity levels more accurately, and reduce energy costs.

Inverter technology varies the compressor, the outdoor and the indoor fan speeds, eliminating constant compressor start-ups/shut-downs that traditional systems require to maintain the set temperature.

This is especially beneficial in multizone systems where room temperature set points vary and some indoor units may be turned off in unoccupied rooms.

Each system can adjust capacity and cooling output to provide only the amount of cooling needed at a given time.

The result is optimal comfort with low energy costs.

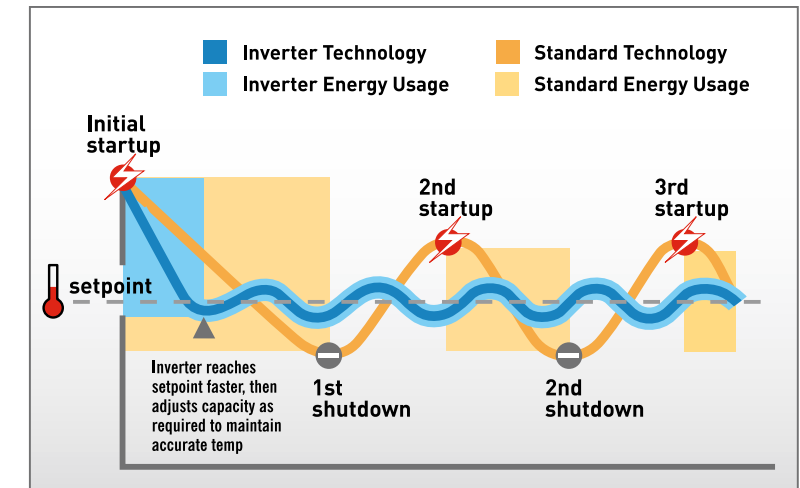

The Advantages of Friedrich Inverter Systems

TRADITIONAL SYSTEM	INVERTER SYSTEM
At initial start up, fixed capacity system slowly reaches the set temperature.	At initial start up, utilizes variable capacity to quickly reach the set temperature.
Complete shutdown once set temperature is achieved.	Reduces capacity as set temperature is achieved.
Temperature within the space rises until 2nd system start up.	Variable capacity maintains set temperature keeping space comfortable with reduced energy consumption.
System works at full capacity to again reach set temperature.	
System cycles on and off continually to maintain the set temperature.	

*Ductless wall-mounted and ceiling cassette models



Friedrich's highest energy efficiencies ever.

Up to 25.0 SEER

DIAMONDGOLD
Advanced Corrosion Protection™

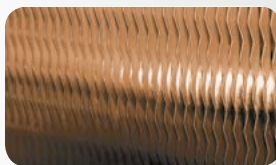

Protects the outdoor coil against deterioration and extends the life of the unit especially in harsh coastal environments.



Attractive and high efficiency options for cooling and heating residential and light commercial spaces.



Wall-mounted models mount high on the wall.

The attractive, neutral finish blends well with just about any decor.



Indoor units can be used individually or as part of a multizone system to condition multiple spaces or a large area.

131

MULTIZONE COMBINATIONS

Residential Applications

- Room additions/renovations
- Homes without ductwork
- Bedrooms and family rooms
- Garage workshops
- Sunrooms
- Guest quarters
- Wine cellars

Commercial Applications

- Hotels and other lodging
- Computer rooms/server rooms
- Restaurant kitchen and prep areas
- Offices in warehouse spaces
- Storage facilities
- Buildings where security concerns prevent the use of window units
- Internal areas without exterior wall access

Zone Cooling and Heating

Occupants have the ability to set the temperature to their preferred comfort level. And, you can turn off units in unoccupied rooms.

That's the beauty- and efficiency of a Friedrich multizone system.



Enjoy the flexibility to mix and match wall-mounted, ceiling cassette and concealed duct systems to fit your application.

Features you'll find with Friedrich Ductless Systems:

System Type	Wall-mounted Single Zone	Wall-mounted Multizone	Cassette Single Zone	Cassette Multizone	Concealed Duct Single Zone	Concealed Duct Multizone
Installation	Wall	Wall	Ceiling	Ceiling	Ceiling	Ceiling
Cool only	Y	N	N	N	N	N
Heat pump	Y	Y	Y	Y	Y	Y
115 volt models	Y	N	N	N	N	N
Inverter compressor	Y	Y	Y	Y	Y	Y
SEER	Up to 25.0	Up to 21.7	Up to 19	Up to 16.5	Up to 17.6	Up to 16.5
Auto changeover	Y	N	Y	N	Y	N
Low ambient operation*	Y	Y	Y	Y	Y	Y
Programmable timer	24-hr.	24-hr.	24-hr.	24-hr.	24-hr.	N
Remote control	Y	Y	Y	Y	N	N
Wall controller option	Y	Y	Y	Y	Y	Y
Auto restart when power is interrupted	Y	Y	Y	Y	Y	Y
Continuous 'Air Sweep'	Y	Y	Y	Y	N	N
Washable, antimicrobial air filters	Y	Y	Y	Y	Y	Y
Auto shut flaps when unit is off	Y	Y	Y	Y	N	N
Louver Position (Fan/Cool/Heat)	6 / 6 / 6	6 / 6 / 6	4 / 5 / 4	4 / 5 / 4	N	N

EASE OF INSTALLATION

New ductless line with convenient installation features that will get your ductless running in no time.

UNIQUE MOUNTING BRACKET

16" on Center

The hanging bracket comes with a set of holes that are placed 16" apart from each other to help you attach the bracket securely to "16 on center" wall studs.



Level-Line Ledges

Incorporated "Level-Line Ledges" ensure a straight wall mount and frees both hands for an easy single-person installation.

Tape Measure Assist

The integrated "blade grip" securely keeps measuring tape in place. The "blade grip" gives you a helping hand when installing the bracket to the wall.

Powerful airflow for faster heating and cooling.

Optimum air flow

Air is directed downward in heating mode and angled upward during cooling mode so the room feels more comfortable, faster.

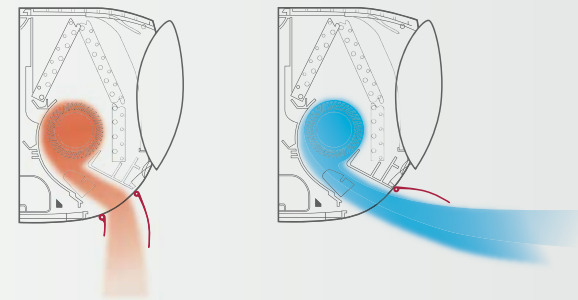

Large fans

Powerful fans move the air across the room—up to 39 feet away. That means faster cooling and heating and you feel comfortable sooner no matter where you are in the room.

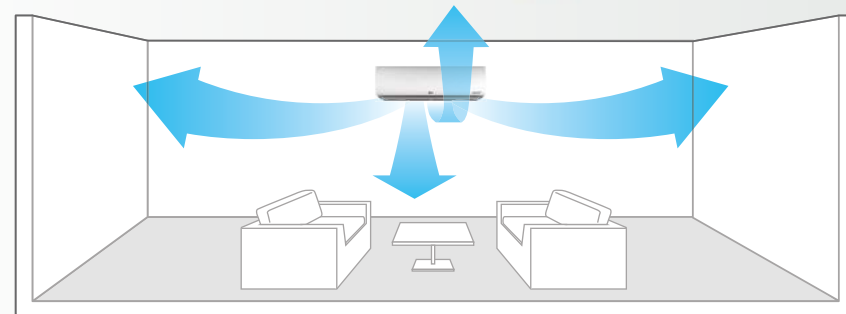

Wall Standoff Bracket

The clip keeps sufficient space between the unit and the wall creating more room for installation.

Spacious Tubing Area

Ample space was created to facilitate tubing installation and placement.

Low Installation Access Panel

By lowering the access panel to eye-level we have created a hassle-free access to electrical connections.

Secure Grip Screws

"Grip Screws" firmly secure wall-mounted unit to wall bracket providing a stable setup.



Single Zone

WALL-MOUNTED COOL ONLY

9000-24000 Btu. Cool only models with features for convenient operation, care-free comfort and years of dependability.

Features

- Inverter technology (variable speed compressor)
- High efficiency for low operating cost
- DiamonGold Advanced Corrosion Protection™
- Auto dry indoor coil
- Cooling/Heating/Fan mode
- Surge cool
- Natural air flow
- 4-Way auto swing
- Ultra quiet operation
- Sleep mode
- Dehumidifying mode
- Auto restart
- Built-in low ambient standard, down to 14°F (Cooling Mode)
- 24-hour on-off timer
- Condensate sensor connection
- Multiple ease of installation features (see p.7)



MW09C1J, MW12C1J



MW18C3J, MW24C3J



MR09C1J, MR12C1J



MR18C3J



MR24C3J



PRELIMINARY SPECIFICATIONS

PERFORMANCE RATINGS	Single Wall Mounted - Cool Inv				
	9k	12k	18k	24k	
SYSTEM MODEL NO.	M09CJ	M12CJ	M18CJ	M24CJ	
INDOOR MODEL	MW09C1J	MW12C1J	MW18C3J	MW24C3J	
OUTDOOR MODEL	MR09C1J	MR12C1J	MR18C3J	MR24C3J	
SPECIFICATIONS					
CAPACITY COOLING (RATED)	Btu	9,000	11,200	17,000	22,000
CAPACITY COOLING (MIN-MAX)	Btu	3,070-12,120	3,070-13,660	3,070-20,470	3,070-26,270
CAPACITY HEATING (RATED)	Btu	N/A	N/A	N/A	N/A
CAPACITY HEATING (MIN-MAX)	Btu	N/A	N/A	N/A	N/A
COOLING AMPS		6	8.4	7	8.7
HEATING AMPS		N/A	N/A	N/A	N/A
SENSIBLE HEAT RATIO		.89	.83	.79	.81
SEER		21.5	21.5	18.0	20.0
EER		13.3	12.5	12.0	10.8
HSPF		N/A	N/A	N/A	N/A
ENERGY STAR		YES(Most Efficient)	YES(Most Efficient)	YES	No
MOISTURE REMOVAL	Pts/h	2.6	3.0	5.3	6.0
AIRFLOW (QUIET, LOW, MED, HIGH)	CFM	124/212/272/335	124/212/272/335	300/399/509/622	300/424/629/742
SOUND RATING - INDOOR	dB-A	19 / 24 / 33 / 38	19 / 24 / 33 / 39	29 / 35 / 40 / 45	29 / 35 / 40 / 46
SOUND RATING - OUTDOOR	dB-A	45	45	53	54
OPERATING RANGE (COOLING)(WIND BAFFLE)	°F	14.0(0)-118.4	14.0(0)-118.4	14.0(0)-118.4	14.0(0)-118.4
OPERATING RANGE (HEATING)	°F	N/A	N/A	N/A	N/A
EST. YEARLY OPERATING COST	\$	61	81	127	183
ELECTRICAL DATA					
POWER SOURCE		115-60-1	115-60-1	230/208-60-1	230/208-60-1
MINIMUM AMPACITY	A	10	10	19	19
COOLING WATTS	W	677	896	1416	2037
MAX. TD FUSE/BREAKER	A	15	15	25	25
POWER AND COMMUNICATION CABLE	No. x AWG	4 x 18	4 x 18	4 x 18	4 x 18
REFRIGERATION SYSTEM					
REFRIGERANT		R410A	R410A	R410A	R410A
COMPRESSOR TYPE		Inverter	Inverter	Inverter	Inverter
CONNECTIONS		Flare	Flare	Flare	Flare
LIQUID LINE O.D.	in	1/4	1/4	1/4	3/8
SUCTION LINE O.D.	in	3/8	3/8	1/2	5/8
FACTORY PRECHARGE	ft	35.5	35.3	47.6	63.5
MAX. LINE LENGTH	ft	66'	66'	66'	98'
MAX. HEIGHT DIFFERENCE	ft	33'	33'	33'	49'
DIMENSIONS & WEIGHT					
INDOOR UNIT					
W X H X D	in	35-1/4x 11-1/4x 8-5/16	35-1/4x 11-1/4x 8-5/16	40-5/8x 12-7/8x 9-5/8	40-5/8x 12-7/8x 9-5/8
NET WEIGHT	lbs	23	23	31	32
SHIPPING WEIGHT	lbs	27	27	35	37
OUTDOOR UNIT					
W X H X D	in	30-5/16x 21-5/16x 11-5/16	30-5/16x 21-5/16x 11-5/16	34-5/16x 25-7/8x 12-5/8	34-5/16 x 31-1/2 x 12-5/8
NET WEIGHT	lbs	75	75	108	122
SHIPPING WEIGHT	lbs	79	79	115	130
TOTAL NET WEIGHT	lbs	97	97	139	154
TOTAL SHIPPING WEIGHT	lbs	106	106	150	167

NOTE: All R410 models have 1/2" UNF 20 thread per inch charging and vacuuming ports. An adapter must be used for 1/4" gauges.

Adapter part number 67270018 is available through Friedrich parts distributors.

Your operating costs will depend on your utility rates and use. The estimated operating cost is based on a electricity cost of \$.115 per kWh.

For more information, visit www.ftc.gov/energy.

Due to continuing research in new energy-saving technology, specifications are subject to change without notice.



Single Zone

25.0 SEER WALL-MOUNTED HEAT PUMP

12000 Btu. Our most efficient unit ever! Features for comfort and convenience year 'round. In heating mode, unit efficiently heats by using approximately 1/4 of the energy required by electric heat.

Features

- Inverter technology (variable speed compressor)
- High efficiency for low operating cost
- DiamonGold Advanced Corrosion Protection™
- Auto dry indoor coil
- Surge cool/heat
- Natural air flow
- Ultra quiet operation
- Sleep mode
- Auto restart
- Auto changeover
- BLDC Motor
- Low ambient operation down to 14°F (Cooling Mode)
- 24-hour on-off timer
- ENERGY STAR® qualified model
- Hidden display (only visible during operation)
- Multiple ease of installation features (see p.7)



MWH12Y3J



MRH12YCJ



PRELIMINARY SPECIFICATIONS

PERFORMANCE RATINGS		Single Wall Mounted - H/P Inv (High SEER)
		12k
SYSTEM MODEL NO.		HM12YJ
INDOOR MODEL		MWH12Y3J
OUTDOOR MODEL		MRH12Y3J
SPECIFICATIONS		
CAPACITY COOLING	Btu	12,000
CAPACITY COOLING (MIN-MAX)	Btu	Pending
CAPACITY HEATING	Btu	13,600
CAPACITY HEATING (MIN-MAX)	Btu	Pending
COOLING AMPS		3.8
HEATING AMPS		4.3
SENSIBLE HEAT RATIO		.84
SEER		25.0
EER		14.0
HSPF		11.0
ENERGY STAR		Yes
MOISTURE REMOVAL	Pts/h	1.7
AIRFLOW (QUIET, LOW, MED, HIGH)	CFM	177 / 283 / 417 / 494
SOUND RATING - INDOOR	dB-A	42 / 36 / 25 / 17
SOUND RATING - OUTDOOR	dB-A	51
OPERATING RANGE (COOLING)	°F	14.0(0)-118.4
OPERATING RANGE (HEATING)	°F	14-75.2
EST. YEARLY OPERATING COST	\$	77
ELECTRICAL DATA		
POWER SOURCE	V	208/230
MINIMUM AMPACITY	A	10
COOLING WATTS	W	857
HEATING WATTS	W	960
MAX. TD FUSE/BREAKER	A	15
POWER AND COMMUNICATION CABLE	No. x AWG	4 x 18
REFRIGERATION SYSTEM		
REFRIGERANT		R410A
COMPRESSOR TYPE		Twin Rotary
CONNECTIONS		Flare
LIQUID LINE O.D.	in	1/4
SUCTION LINE O.D.	in	3/8
FACTORY PRECHARGE	ft	44.1
MAX. LINE LENGTH	ft	49.2
MAX. HEIGHT DIFFERENCE	ft	23
DIMENSIONS & WEIGHT		
INDOOR UNIT		
W X H X D	in	34-7/16 x 11-5/8 x 9-1/4
NET WEIGHT	lbs	25
SHIPPING WEIGHT	lbs	29
OUTDOOR UNIT		
W X H X D	in	34-5/16 x 25-7/8 x 12-5/8
NET WEIGHT	lbs	95
SHIPPING WEIGHT	lbs	100
TOTAL NET WEIGHT	lbs	119
TOTAL SHIPPING WEIGHT	lbs	128

NOTE: All R410 models have 1/2" UNF 20 thread per inch charging and vacuuming ports. An adapter must be used for 1/4" gauges. Adapter part number 67270018 is available through Friedrich parts distributors.

Your operating costs will depend on your utility rates and use. The estimated operating cost is based on a electricity cost of \$.115 per kWh. For more information, visit www.ftc.gov/energy.

Due to continuing research in new energy-saving technology, specifications are subject to change without notice.



Single Zone

WALL-MOUNTED HEAT PUMPS

9000-18000 Btu. Features for comfort and convenience year 'round. In heating mode, units efficiently heat by using approximately 1/4 of the energy required by electric heat.

Features

- Inverter technology (variable speed compressor)
- High efficiency for low operating cost
- DiamonGold Advanced Corrosion Protection™
- Auto dry indoor coil
- Cooling/Heating/Fan mode
- Surge cool/heat
- Natural air flow
- 4-Way auto swing
- Ultra quiet operation
- Sleep mode
- Dehumidifying mode
- Auto restart
- Auto changeover
- Built-in low ambient standard, down to 14°F (Cooling Mode)
- 24-hour on-off timer
- Condensate sensor connection
- Multiple ease of installation features (see p.7)



MW09Y3J, MW12Y3J



MW18Y3J



MR09Y3J, MR12Y3J



MR18Y3J



PRELIMINARY SPECIFICATIONS

PERFORMANCE RATINGS	Single Wall Mounted - H/P Inv			
	9k	12k	18k	
SYSTEM MODEL NO.	M09YJ	M12YJ	M18YJ	
INDOOR MODEL	MW09Y3J	MW12Y3J	MW18Y3J	
OUTDOOR MODEL	MR09Y3J	MR12Y3J	MR18Y3J	
SPECIFICATIONS				
CAPACITY COOLING (RATED)	Btu	9,000	11,200	17,000
CAPACITY COOLING (MIN-MAX)	Btu	3,070-12,620	3,070-14,660	3,070-20,470
CAPACITY HEATING (RATED)	Btu	10,800	13,300	20,200
CAPACITY HEATING (MIN-MAX)	Btu	3,070-17,060	3,070-20,470	3,070-30,700
COOLING AMPS		3	4.2	7
HEATING AMPS		3.7	4.9	7.8
SENSIBLE HEAT RATIO		.88	.81	.78
SEER		21.5	21.5	18.0
EER		13.3	12.5	12.0
HSPF		11.0	11.0	9.7
ENERGY STAR		YES(Most Efficient)	YES(Most Efficient)	YES
MOISTURE REMOVAL	Pts/h	2.6	3.0	5.3
AIRFLOW (QUIET, LOW, MED, HIGH)	CFM	124/212/272/335	124/212/272/335	300/399/509/622
SOUND RATING - INDOOR	dB-A	19 / 24 / 33 / 38	19 / 24 / 33 / 39	29 / 35 / 40 / 45
SOUND RATING - OUTDOOR	dB-A	45	45	53
OPERATING RANGE (COOLING)(WIND BAFFLE)	°F	14.0(0)-118.4	14.0(0)-118.4	14.0(0)-118.4
OPERATING RANGE (HEATING)	°F	-4.0-75.2	-4.0-75.2	-4.0-75.2
EST. YEARLY OPERATING COST	\$	61	81	127
ELECTRICAL DATA				
POWER SOURCE		230/208	230/208	230/208
MINIMUM AMPACITY	A	10	10	19
COOLING WATTS	W	677	896	1416
MAX. TD FUSE/BREAKER	A	15	15	20
POWER AND COMMUNICATION CABLE	No. x AWG	4 x 18	4 x 18	4 x 18
REFRIGERATION SYSTEM				
REFRIGERANT		R410A	R410A	R410A
COMPRESSOR TYPE		Inverter	Inverter	Inverter
CONNECTIONS		Flare	Flare	Flare
LIQUID LINE O.D.	in	1/4	1/4	1/4
SUCTION LINE O.D.	in	3/8	3/8	1/2
FACTORY PRECHARGE	ft	35.3	35.3	47.6
MAX. LINE LENGTH	ft	66'	66'	66'
MAX. HEIGHT DIFFERENCE	ft	33'	33'	33'
DIMENSIONS & WEIGHT				
INDOOR UNIT				
W X H X D	in	35-1/4 x 11-1/4 x 8-1/4	35-1/4 x 11-1/4 x 8-1/4	40-5/8 x 12-7/8 x 9-5/8
NET WEIGHT	lbs	23	23	31
SHIPPING WEIGHT	lbs	27	27	36
OUTDOOR UNIT				
W X H X D	in	30-5/16x21-5/16x11-5/16	30-5/16x21-5/16x11-5/16	34-5/16x25-7/8x12-5/8
NET WEIGHT	lbs	75	75	108
SHIPPING WEIGHT	lbs	79	79	115
TOTAL NET WEIGHT	lbs	98	98	139
TOTAL SHIPPING WEIGHT	lbs	107	107	150

NOTE: All R410 models have 1/2" UNF 20 thread per inch charging and vacuuming ports. An adapter must be used for 1/4" gauges.

Adapter part number 67270018 is available through Friedrich parts distributors.

Your operating costs will depend on your utility rates and use. The estimated operating cost is based on a electricity cost of \$.115 per kWh. For more information, visit www.ftc.gov/energy.

Due to continuing research in new energy-saving technology, specifications are subject to change without notice.



Single Zone

WALL-MOUNTED HEAT PUMPS

24000-36000Btu. Extensive features for comfort and convenience year 'round. In heating mode, units efficiently heat by using approximately 1/4 of the energy required by electric heat.

Features

- Inverter technology (variable speed compressor)
- High efficiency for low operating cost
- DiamonGold Advanced Corrosion Protection™
- Self-cleaning indoor coil
- Cooling/Heating/Fan mode
- Air burst for fast cooling
- Natural air flow
- 4-Way auto swing
- Ultra quiet operation
- Sleep mode
- Dehumidifying mode
- Auto restart
- Auto changeover
- Built-in low ambient standard, down to 14°F (Cooling Mode)
- 24-hour on-off timer
- Condensate sensor connection
- Multiple ease of installation features (see p.7)



MW24Y3J



MW30Y3J, MW36Y3J



MR24Y3J, MR30Y3J, MR36Y3J



PRELIMINARY SPECIFICATIONS

PERFORMANCE RATINGS	Single Wall Mounted - H/P Inv			
	24k	30k	36k	
SYSTEM MODEL NO.	M24YJ	M30YJ	M36YJ	
INDOOR MODEL	MW24Y3J	MW30Y3J	MW36Y3J	
OUTDOOR MODEL	MR24Y3J	MR30Y3J	MR36Y3J	
SPECIFICATIONS				
CAPACITY COOLING (RATED)	Btu	22,000	30,000	33,000
CAPACITY COOLING (MIN-MAX)	Btu	3,070-30,030	3,070-34,000	3,070-34,000
CAPACITY HEATING (RATED)	Btu	27,600	32,000	35,200
CAPACITY HEATING (MIN-MAX)	Btu	3,070-38,898	3,070-38,900	3,070-38,900
COOLING AMPS		7.9	13.4	17.0
HEATING AMPS		10.7	13.9	16.2
SENSIBLE HEAT RATIO		.66	.61	.67
SEER		21.0	18.5	16.5
EER		12.5	10.0	8.2
HSPF		11.0	10.0	10.0
ENERGY STAR		YES (Most Efficient)	No	No
MOISTURE REMOVAL	Pts/h	6.8	10.7	10.7
AIRFLOW (QUIET, LOW, MED, HIGH)	CFM	300/389/512/600	459/530/706/848	459/530/706/484
SOUND RATING - INDOOR	dB-A	33 / 39 / 43 / 46	33 / 39 / 44 / 49	37 / 40 / 44 / 49
SOUND RATING - OUTDOOR	dB-A	54	55	55
OPERATING RANGE (COOLING)(WIND BAFFLE)	°F	14.0(0)~118.4	14.0(0)~118.4	14.0(0)~118.4
OPERATING RANGE (HEATING)	°F	-4.0~75.2	-4.0~75.2	-4.0~75.2
EST. YEARLY OPERATING COST	\$	158	270	395
ELECTRICAL DATA				
POWER SOURCE		230/208	230/208	230/208
MINIMUM AMPACITY	A	19	19	19
COOLING WATTS	W	1760	3000	4024
MAX. TD FUSE/BREAKER	A	25	25	25
POWER AND COMMUNICATION CABLE	No. x AWG	4 x 18	4 x 18	4 x 18
REFRIGERATION SYSTEM				
REFRIGERANT		R410A	R410A	R410A
COMPRESSOR TYPE		Inverter	Inverter	Inverter
CONNECTIONS		Flare	Flare	Flare
LIQUID LINE O.D.	in	3/8	3/8	3/8
SUCTION LINE O.D.	in	5/8	5/8	5/8
FACTORY PRECHARGE	ft	77.6	77.6	77.6
MAX. LINE LENGTH	ft	164'	164'	164'
MAX. HEIGHT DIFFERENCE	ft	98.4'	98.4'	98.4'
DIMENSIONS & WEIGHT				
INDOOR UNIT				
W X H X D	in	46-7/8 x 13-5/8 x 10-7/16	46-7/8 x 13-5/8 x 10-3/8	46-7/8 x 13-5/8 x 10-3/8
NET WEIGHT	lbs	40	40	40
SHIPPING WEIGHT	lbs	46	46	46
OUTDOOR UNIT				
W X H X D	in	34-5/16 x 31-1/5 x 12-5/8	345/16 x 31-1/2 x 12-5/8	345/16 x 31-1/2 x 12-5/8
NET WEIGHT	lbs	108	108	108
SHIPPING WEIGHT	lbs	115	115	115
TOTAL NET WEIGHT	lbs	148	148	148
TOTAL SHIPPING WEIGHT	lbs	160	160	160

NOTE: All R410 models have 1/2" UNF 20 thread per inch charging and vacuuming ports. An adapter must be used for 1/4" gauges.

Adapter part number 67270018 is available through Friedrich parts distributors.

Your operating costs will depend on your utility rates and use. The estimated operating cost is based on a electricity cost of \$.115 per kWh. For more information, visit www.ftc.gov/energy.

Due to continuing research in new energy-saving technology, specifications are subject to change without notice.



Single Zone

CEILING CASSETTE HEAT PUMPS

24000 and 36000 Btu. Ceiling cassette models install nearly flush with a drop ceiling for a clean and efficient installation.

Features

- Inverter technology (variable speed compressor)
- Internal condensate pump included
- Natural air flow
- 4-Way cooling
- Surge cool/heat
- Cooling mode
- Dehumidifying mode
- Night Quiet Operation
- Built-in low ambient standard, down to 14°F (Cooling mode)
- Fan mode
- Independent vane control
- 5 Fan speeds
- Evaporator frost control
- 24-hour on-off timer
- Auto restart
- Auto changeover
- Temperature display on remote
- Ultra-quiet turbo fan
- DiamonGold Advanced Corrosion Protection™
- Clean, modern look
- Flexible installation
- ENERGY STAR® qualified models
- Precise air distribution

Low profile indoor unit is recessed into the ceiling for a clean look and greater clearance.



PRELIMINARY SPECIFICATIONS

PERFORMANCE RATINGS		Single Zone Cassette H/P	
		24k	36k
SYSTEM MODEL NO.		C24YJ	C36YJ
INDOOR MODEL		MC24Y3J	MC36Y3J
OUTDOOR MODEL		MR24UY3J	MR36UY3J
SPECIFICATIONS			
CAPACITY COOLING (RATED)	Btu	24,000	36,000
CAPACITY COOLING (MIN-MAX)	Btu	9,700-26,700	14,000-42,000
CAPACITY HEATING (RATED)	Btu	27,000	40,000
CAPACITY HEATING (MIN-MAX)	Btu	10,900-30,000	14,500-45,000
COOLING AMPS		Pending	Pending
HEATING AMPS		Pending	Pending
SENSIBLE HEAT RATIO		.77	.76
SEER		17.0	19.0
EER		12.5	13.5
HSPF		9.7	9.5
ENERGY STAR		No	No
MOISTURE REMOVAL	Pts/h	5.1	7.7
AIRFLOW (HIGH, MED, LOW)	CFM	600 / 530 / 459	1,060 / 989 / 918
SOUND RATING - INDOOR	dB(A)	57	65
SOUND RATING - OUTDOOR	dB(A)	62	67
OPERATING RANGE (COOLING)	°F	5.0(0)-118.4	5.0(0)-118.4
OPERATING RANGE (HEATING)	°F	-4.0-64.4	-4.0-64.4
EST. YEARLY OPERATING COST	\$	172	240
ELECTRICAL DATA			
POWER SOURCE	V	230/208	230/208
MINIMUM AMPACITY	A	18.1	24.5
COOLING WATTS	W	Pending	Pending
MAX. TD FUSE/BREAKER	A	30	40
REFRIGERATION SYSTEM			
REFRIGERANT		R410A	R410A
COMPRESSOR TYPE		Twin Rotary	Twin Rotary
CONNECTIONS		Flare	Flare
LIQUID LINE O.D.	in	3/8	3/8
SUCTION LINE O.D.	in	5/8	5/8
FACTORY PRECHARGE	ft	70.5	119.9
MAX. LINE LENGTH	ft	164'	164'
MAX. HEIGHT DIFFERENCE	ft	98.4	98.4
POWER AND COMMUNICATION CABLE	No. x AWG	4 x 18	4 x 18
DIMENSIONS & WEIGHT			
INDOOR UNIT			
W X H X D	in	33-1/16 x 8-1/16 x 33-1/16	33-1/16 x 11-3/8 x 33-1/16
NET WEIGHT	lbs	45	54
INDOOR UNIT GRILLE* NET WEIGHT	lbs	11	20
SHIPPING WEIGHT	lbs	58	65
OUTDOOR UNIT			
W X H X D	in	37-7/16 x 32-7/8 x 13	37-13/32 x 54-3/8 x 13
NET WEIGHT	lbs	132	203
SHIPPING WEIGHT	lbs	146	227
TOTAL NET WEIGHT	lbs	178	257
TOTAL SHIPPING WEIGHT	lbs	203	293

NOTE: All R410 models have 1/2" UNF 20 thread per inch charging and vacuuming ports. An adapter must be used for 1/4" gauges. Adapter part number 67270018 is available through Friedrich parts distributors.

Your operating costs will depend on your utility rates and use. The estimated operating cost is based on a electricity cost of \$.115 per kWh. For more information, visit www.ftc.gov/energy.

*The included indoor unit grille ships in separate carton.

Due to continuing research in new energy-saving technology, specifications are subject to change without notice.



Single Zone

CONCEALED DUCT HEAT PUMP

24000 and 36000 Btu. Indoor unit is installed in the ceiling or furr down for unobtrusive installation.

Features

- Inverter technology (variable speed compressor)
- Internal condensate pump included
- Cooling mode
- Dehumidifying mode
- 3 Fan speeds+
- 24-hour on-off timer
- Auto restart
- Auto changeover
- Sleep mode
- Control lock function
- External Static Pressure Range(ESP)
 - 24,000 (0.1 - 0.78) WC
 - 36,000 (0.15 - 0.6) WC



MD24Y3J, MD36Y3J



MRD24Y3J



MRD36Y3J

PRELIMINARY SPECIFICATIONS

PERFORMANCE RATINGS	Single Zone Concealed Ducted H/P		
	24k	36k	
SYSTEM MODEL NO.	D24YJ	D36YJ	
INDOOR MODEL	MD24Y3J	MD36Y3J	
OUTDOOR MODEL	MR24UY3J	MR36UY3J	
SPECIFICATIONS			
CAPACITY COOLING (RATED)	Btu	24,000	36,000
CAPACITY COOLING (MIN-MAX)	Btu	9,700~26,700	16,000~41,400
CAPACITY HEATING (RATED)	Btu	27,000	40,000
CAPACITY HEATING (MIN-MAX)	Btu	10,900~30,000	17,500~48,000
COOLING AMPS		Pending	Pending
HEATING AMPS		Pending	Pending
SENSIBLE HEAT RATIO		.68	.67
SEER		17.0	17.6
EER		12.0	12.1
HSPF		10.0	9.2
ENERGY STAR		No	No
MOISTURE REMOVAL	Pts/h	7.0	10.6
AIRFLOW (HIGH, MED, LOW)	CFM	19.5 / 17.5 / 15.0	32.0 / 27.0 / 20.0
SOUND RATING - INDOOR	dB(A)	56	56
SOUND RATING - OUTDOOR	dB(A)	62	67
OPERATING RANGE (COOLING)	°F	5.0~118.4	5.0~118.4
OPERATING RANGE (HEATING)	°F	-4.0~64.4	-4.0~64.4
EST. YEARLY OPERATING COST	\$	180	268
ELECTRICAL DATA			
POWER SOURCE		230/208	230/208
MINIMUM AMPACITY	A	Pending	Pending
COOLING WATTS	W	Pending	Pending
MAX. TD FUSE/BREAKER	A	30	40
REFRIGERATION SYSTEM			
REFRIGERANT		R410A	R410A
COMPRESSOR TYPE		Twin Rotary	Twin Rotary
CONNECTIONS		Flare	Flare
LIQUID LINE O.D.	in	3/8	3/8
SUCTION LINE O.D.	in	5/8	5/8
FACTORY PRECHARGE	ft	70.5	119.9
MAX. LINE LENGTH	ft	164'	246.1'
MAX. HEIGHT DIFFERENCE	ft	98.4	98.4
POWER AND COMMUNICATION CABLE	No. x AWG	4 x 18	4 x 18
DIMENSIONS & WEIGHT			
INDOOR UNIT			
W X H X D	in	46-9/16 x 11-3/4 x 17-3/4	48-1/2 x 14-1 x 23-1/4
NET WEIGHT	lbs	73	125
SHIPPING WEIGHT	lbs	95	139
OUTDOOR UNIT			
W X H X D	in	37-7/16 x 32-7/8 x 13	37-7/16 x 54-3/8 x 13
NET WEIGHT	lbs	132	203
SHIPPING WEIGHT	lbs	146	227
TOTAL NET WEIGHT	lbs	205	327
TOTAL SHIPPING WEIGHT	lbs	240	366

NOTE: All R410 models have 1/2" UNF 20 thread per inch charging and vacuuming ports. An adapter must be used for 1/4" gauges.

Adapter part number 67270018 is available through Friedrich parts distributors.

Your operating costs will depend on your utility rates and use. The estimated operating cost is based on a electricity cost of \$.115 per kWh. For more information, visit www.ftc.gov/energy.

Due to continuing research in new energy-saving technology, specifications are subject to change without notice.



Multizone

WALL-MOUNTED HEAT PUMPS

High efficiency heat pumps with features for comfort and convenience year 'round. In heating mode, units efficiently heat by using approximately 1/4 of the energy required by electric heat.

Features

- Inverter technology (variable speed compressor)
- High efficiency for low operating cost
- DiamonGold Advanced Corrosion Protection™
- Self-cleaning indoor coil
- Cooling/Heating/Fan mode
- Air burst for fast cooling
- Natural air flow
- 4-Way auto swing
- Ultra quiet operation
- Sleep mode
- Dehumidifying mode
- Auto restart
- Auto changeover
- Built-in low ambient standard, down to 14°F (Cooling Mode)
- 24-hour on-off timer
- Condensate sensor connection
- Built-in kick stand



MW09Y3J, MW12Y3J



MW18Y3J



MR24DY3JM



MR36TQY3JM



PRELIMINARY SPECIFICATIONS

PERFORMANCE RATINGS	Multi Zone Wall Mounted			
	9k	12k	18k	
INDOOR MODEL	MW09Y3J	MW12Y3J	MW18Y3J	
SPECIFICATIONS				
CAPACITY COOLING (RATED)	Btu	9,000	11,200	17,000
MOISTURE REMOVAL	Pts/h	2.6	3.0	5.3
AIRFLOW (QUIET, LOW, MED, HIGH)	CFM	124/212/272/335	124/212/272/335	300/399/509/622
SOUND RATING - INDOOR	dB-A	19 / 24 / 33 / 38	19 / 24 / 33 / 39	29 / 35 / 40 / 45
ELECTRICAL DATA				
POWER SOURCE	V, Ø, Hz	230/208-60-1	230/208-60-1	230/208-60-1
REFRIGERATION SYSTEM				
CONNECTIONS		Flare	Flare	Flare
LIQUID LINE O.D.	in	1/4	1/4	1/4
SUCTION LINE O.D.	in	3/8	3/8	1/2
DIMENSIONS & WEIGHT				
W X H X D	in	35-1/4 x 11-1/4 x 8-1/4	35-1/4 x 11-1/4 x 8-1/4	40-5/8 x 12-7/8 x 9-5/8
NET WEIGHT	lbs	23	23	31
SHIPPING WEIGHT	lbs	27	27	35

PERFORMANCE RATINGS	Multi Outdoor		
	24k	36k	
OUTDOOR MODEL	MR24DY3JM	MR36TQY3JM	
SPECIFICATIONS			
POWER INPUT COOLING MIN.-RATED-MAX.	Btu	1,330-4,879-10,543	2,627-9,281-13,375
POWER INPUT HEATING MIN.-RATED-MAX.	Btu	1,433-7,540-10,577	3,821-12,215-13,989
POWER SUPPLY	V, Ø, Hz	208/230, 1, 60	208/230, 1, 60
EST. YEARLY OPERATING COST	\$	122-125	170-245
RUNNING CURRENT COOLING MIN.-RATED-MAX.	A	2.8-6.6-14.0	3.3-11.8-17.0
RUNNING CURRENT HEATING MIN.-RATED-MAX.	A	3.0-10.2-14.1	4.9-15.5-17.8
RUNNING CURRENT COOLING MIN.-RATED-MAX.	W	390-1430-3090	770-2720-3920
RUNNING CURRENT HEATING MIN.-RATED-MAX.	W	420-2210-3100	1120-3580-4100
POWER AND COMMUNICATION CABLE	No. x AWG	4 X 18	4 X 18
DIMENSIONS W X H X D	inch	34-1/4 x 31-7/8 x 12-5/8	35-7/16 x 45-7/8 x 14-5/8
NET WEIGHT	lbs	130	209
REFRIGERATION SYSTEM			
REFRIGERANT		R410A	R410A
FACTORY PRECHARGE	ft	74.1	123.5
LIQUID LINE O.D.	in	1/4	1/4
SUCTION LINE O.D.	in	3/8	3/8
MAX. LINE LENGTH	ft	246.1	246.1
MAX. HEIGHT DIFFERENCE	ft	49.2	49.2
SOUND PRESSURE LEVEL COOLING	A	51	57
SOUND PRESSURE LEVEL HEATING	A	51	57
OPERATING RANGE COOLING MIN. ~ MAX.	°F DB	14.0 ~ 114.8	14.0 ~ 114.8
OPERATING RANGE HEATING MIN. ~ MAX.	°F WB	5.0 ~ 64.4	5.0 ~ 64.4
MINIMUM AMPACITY	A	15	17
MAX. TD FUSE/BREAKER	A	25	25

NOTE: All R410 models have 1/2" UNF 20 thread per inch charging and vacuuming ports. An adapter must be used for 1/4" gauges. Adapter part number 67270018 is available through Friedrich parts distributors.

Your operating costs will depend on your utility rates and use. The estimated operating cost is based on a electricity cost of \$.115 per kWh. For more information, visit www.ftc.gov/energy.

Due to continuing research in new energy-saving technology, specifications are subject to change without notice.



Multizone

CEILING CASSETTE HEAT PUMPS

Ceiling cassette models install nearly flush with a drop ceiling for a clean and efficient installation.

Features

- Inverter technology (variable speed compressor)
- Internal condensate pump included
- Natural air flow
- 4-Way cooling
- Surge Cool/Heat
- Cooling mode
- Dehumidifying mode
- Night Quiet Operation
- Built-in low ambient standard, down to 14°F (Cooling mode)
- Fan mode
- Independent vane control
- 5 Fan speeds
- Evaporator frost control
- 24-hour on-off timer
- Auto restart
- Auto changeover
- Temperature display on remote
- Ultra-quiet turbo fan
- DiamonGold Advanced Corrosion Protection™
- Clean, modern look
- Flexible installation
- ENERGY STAR® qualified models
- Precise air distribution



MC12Y3JM, MC18Y3JM



MR24DY3JM



MR36TQY3JM



PRELIMINARY SPECIFICATIONS

PERFORMANCE RATINGS	Multi Zone Cassette		
	MC12Y3JM	MC18Y3JM	
INDOOR MODEL	MC12Y3JM	MC18Y3JM	
SPECIFICATIONS			
CAPACITY COOLING (RATED)	Btu	12,000	18,000
MOISTURE REMOVAL	Pts/h	4.2	4.2
AIRFLOW (LOW, MED, HIGH)	CFM	335 / 283 / 247	459 / 424 / 388
SOUND RATING - INDOOR	dB-A	32/35/38	34/37/38
ELECTRICAL DATA			
POWER SOURCE	V, Ø, Hz	208/230, 1, 60	208/230, 1, 60
REFRIGERATION SYSTEM			
CONNECTIONS		Flare	Flare
LIQUID LINE O.D.	in	1/4	1/4
SUCTION LINE O.D.	in	3/8	1/2
POWER AND COMMUNICATION CABLE	No. x AWG	4C x 18	4C x 18
DIMENSIONS & WEIGHT			
W X H X D	in	22-7/16 x 8-7/16 x 22-7/16	22-7/16 x 10-3/32 x 22-7/16
NET WEIGHT	lbs	31	33
SHIPPING WEIGHT	lbs	36	42

PERFORMANCE RATINGS	Multi Outdoor		
	24k	36k	
OUTDOOR MODEL	MR24DY3JM	MR36TQY3JM	
SPECIFICATIONS			
POWER INPUT COOLING MIN.-RATED-MAX.	Btu	1,330~4,879~10,543	2,627~9,281~13,375
POWER INPUT HEATING MIN.-RATED-MAX.	Btu	1,433~7,540~10,577	3,821~12,215~13,989
POWER SUPPLY	V, Ø, Hz	208/230, 1, 60	208/230, 1, 60
EST. YEARLY OPERATING COST	\$	122-125	170-245
RUNNING CURRENT COOLING MIN.-RATED-MAX.	A	2.8~6.6~14.0	3.3~11.8~17.0
RUNNING CURRENT HEATING MIN.-RATED-MAX.	A	3.0~10.2~14.1	4.9~15.5~17.8
RUNNING CURRENT COOLING MIN.-RATED-MAX.	W	390~1430~3090	770~2720~3920
RUNNING CURRENT HEATING MIN.-RATED-MAX.	W	420~2210~3100	1120~3580~4100
POWER AND COMMUNICATION CABLE	No. x AWG	4 X 18	4 X 18
DIMENSIONS W X H X D	inch	34-1/4 x 31-7/8 x 12-5/8	35-7/16 x 45-7/8 x 14-5/8
NET WEIGHT	lbs	130	209
REFRIGERATION SYSTEM			
REFRIGERANT		R410A	R410A
FACTORY PRECHARGE	ft	74.1	123.5
LIQUID LINE O.D.	in	1/4	1/4
SUCTION LINE O.D.	in	3/8	3/8
MAX. LINE LENGTH	ft	246.1	246.1
MAX. HEIGHT DIFFERENCE	ft	49.2	49.2
SOUND PRESSURE LEVEL COOLING	A	51	57
SOUND PRESSURE LEVEL HEATING	A	51	57
OPERATING RANGE COOLING MIN. ~ MAX.	°F DB	14.0 ~ 114.8	14.0 ~ 114.8
OPERATING RANGE HEATING MIN. ~ MAX.	°F WB	5.0 ~ 64.4	5.0 ~ 64.4
MINIMUM AMPACITY	A	15.4	16.8
MAX. TD FUSE/BREAKER	A	25	25

NOTE: All R410 models have 1/2" UNF 20 thread per inch charging and vacuuming ports. An adapter must be used for 1/4" gauges. Adapter part number 67270018 is available through Friedrich parts distributors.

Your operating costs will depend on your utility rates and use. The estimated operating cost is based on a electricity cost of \$.115 per kWh. For more information, visit www.ftc.gov/energy.

Due to continuing research in new energy-saving technology, specifications are subject to change without notice.



Multizone

CONCEALED DUCT HEAT PUMPS

Indoor unit is installed in the ceiling or furr down for unobtrusive installation.

Features

- Inverter technology (variable speed compressor)
- Internal condensate pump included
- Cooling mode
- Dehumidifying mode
- 3 Fan speeds+
- 24-hour on-off timer
- Auto restart
- Auto changeover
- Sleep mode
- Control lock function
- External Static Pressure Range(ESP)
 - 12,000 (0.0 - 0.16) WC
 - 18,000 (0.0 - 0.16) WC

Fresh air can be easily introduced to the conditioned space whenever required.



MD12Y3JM, MD18Y3JM



MR24DY3JM



MR36TQY3JM

PRELIMINARY SPECIFICATIONS

PERFORMANCE RATINGS	Multi Zone Concealed Ducted		
	MD12Y3JM	MD18Y3JM	
SPECIFICATIONS			
CAPACITY COOLING (RATED)	Btu	12,000	18,000
MOISTURE REMOVAL	Pts/h	2.5	4.2
AIRFLOW (LOW, MED, HIGH)	CFM	335 / 300 / 265	530 / 477 / 406
SOUND RATING - INDOOR	dB-A	26/31/33	29/31/34
ELECTRICAL DATA			
POWER SOURCE		208/230, 1, 60	208/230, 1, 60
REFRIGERATION SYSTEM			
CONNECTIONS		Flare	Flare
LIQUID LINE O.D.	in	1/4	1/4
SUCTION LINE O.D.	in	3/8	1/2
POWER AND COMMUNICATION CABLE	No. x AWG	4C x 18	4C x 18
DIMENSIONS & WEIGHT			
W X H X D	in	32-9/32 x 7-15/32 x 22-5/8	43-5/16 x 7-15/32 x 22-5/8
NET WEIGHT	lbs	45	58
SHIPPING WEIGHT	lbs	51	65

PERFORMANCE RATINGS	Multi Outdoor		
	24k	36k	
SPECIFICATIONS			
OUTDOOR MODEL	MR24DY3JM	MR36TQY3JM	
POWER INPUT COOLING MIN.-RATED-MAX.	Btu	1,330~4,879~10,543	2,627~9,281~13,375
POWER INPUT HEATING MIN.-RATED-MAX.	Btu	1,433~7,540~10,577	3,821~12,215~13,989
POWER SUPPLY	V, Ø, Hz	208/230, 1, 60	208/230, 1, 60
EST. YEARLY OPERATING COST	\$	122-125	170-245
RUNNING CURRENT COOLING MIN.-RATED-MAX.	A	2.8~6.6~14.0	3.3~11.8~17.0
RUNNING CURRENT HEATING MIN.-RATED-MAX.	A	3.0~10.2~14.1	4.9~15.5~17.8
RUNNING CURRENT COOLING MIN.-RATED-MAX.	W	390~1430~3090	770~2720~3920
RUNNING CURRENT HEATING MIN.-RATED-MAX.	W	420~2210~3100	1120~3580~4100
POWER AND COMMUNICATION CABLE	No. x AWG	4 X 18	4 X 18
DIMENSIONS W X H X D	inch	34-1/4 x 31-7/8 x 12-5/8	35-7/16 x 45-7/8 x 14-5/8
NET WEIGHT	lbs	130	209
REFRIGERATION SYSTEM			
REFRIGERANT		R410A	R410A
FACTORY PRECHARGE	ft	74.1	123.5
LIQUID LINE O.D.	in	1/4	1/4
SUCTION LINE O.D.	in	3/8	3/8
MAX. LINE LENGTH	ft	246.1	246.1
MAX. HEIGHT DIFFERENCE	ft	49.2	49.2
SOUND PRESSURE LEVEL COOLING	A	51	57
SOUND PRESSURE LEVEL HEATING	A	51	57
OPERATING RANGE COOLING MIN. ~ MAX.	°F DB	14.0 ~ 114.8	14.0 ~ 114.8
OPERATINGRANGE HEATING MIN. ~ MAX.	°F WB	5.0 ~ 64.4	5.0 ~ 64.4
MINIMUM AMPACITY	A	15.4	16.8
MAX. TD FUSE/BREAKER	A	25	25

NOTE: All R410 models have 1/2" UNF 20 thread per inch charging and vacuuming ports. An adapter must be used for 1/4" gauges. Adapter part number 67270018 is available through Friedrich parts distributors.

Your operating costs will depend on your utility rates and use. The estimated operating cost is based on a electricity cost of \$.115 per kWh. For more information, visit www.ftc.gov/energy.

Due to continuing research in new energy-saving technology, specifications are subject to change without notice.



Remote Controls

Wired and wireless controllers.

Wired Controllers

Wall control thermostat with infrared sensor that enables communication between the remote control and the thermostat.



Concealed Ducted
D24YJ, D26YJ
MD12Y3JM, MD18Y3JM

Wireless Controllers



Cassette
C24YJ, C36YJ,
MC12Y3JM,
MC18Y3JM



All Wall-mounted
Models



DWC1- Optional
All Ductless Models

Multizone

Mix and match wall-mounted, concealed duct and ceiling cassette models.



131

MULTIZONE
COMBINATIONS

Enjoy the flexibility to mix and match systems to fit your application.

DIAMOND GOLD
Advanced Corrosion Protection™



5YR.
PARTS
WARRANTY

7YR.
COMPRESSOR
WARRANTY

INVERTER

PRELIMINARY SPECIFICATIONS

24K		Combination of Indoor Units (kBtu/h Class)														
	Wall Mounted			Ducted		Cassette		Capacity			Efficiency					
	9K	12K	18K	12K	18K	12K	18K	Min	Nominal	Max	SEER	EER	HSPF	COP	E-STAR	
2 Indoor Units	••							10798	17000	19800	19	12.6	7.7	3.0	Y	
	•	•						11100	17700	23100	19	12.8	7.7	3.1	Y	
	•		•					11400	19200	27500	19	13.1	8.2	3.3	Y	
	•			•				10798	18600	23100	16.7	12.1	7.8	3.1	Y	
	•				•			10798	18600	27500	16.7	12.3	8.2	3.3	Y	
	•					•		10798	18600	23100	19.0	12.8	7.7	3.1	Y	
	•						•	10798	18600	27500	19.0	13.1	8.2	3.3	Y	
		••							11400	19200	25500	19	13.1	8.2	3.3	Y
		•	•						11400	19200	27500	19	13.1	8.2	3.3	Y
		•		•					11400	18600	25500	16.7	12.3	8.2	3.3	N
		•			•				11400	18600	27500	16.7	12.3	8.2	3.3	N
		•				•			11400	18600	25500	19	13.1	8.2	3.3	Y
		•					•		11400	18600	27500	19	13.1	8.2	3.3	Y
			•	•					11400	18600	25500	16.7	12.3	8.2	3.3	N
	3 Indoor Units						••		12300	18000	25500	14.4	11.5	8.1	3.3	N
							••		12300	18000	25500	19	13.1	8.2	3.3	Y
•••								11700	19200	28800	21.7	13.4	9.4	3.5	Y	
••		•						11700	19200	28800	21.7	13.4	9.4	3.5	Y	
••				•				11700	18600	28800	19.5	12.6	9.0	3.5	N	
••						•		11700	18600	28800	21.7	13.4	9.4	3.5	Y	
•		••						11700	19200	28800	21.7	13.4	9.4	3.5	Y	
•				••				11700	18600	28800	19.05	12.6	9.0	3.5	N	
•						••		11700	18600	28800	21.7	13.4	9.4	3.5	Y	
•		•		•				11700	18600	28800	19.05	12.6	9.0	3.5	N	
•	•				•		11700	18600	28800	21.7	13.4	9.4	3.5	Y		

PRELIMINARY SPECIFICATIONS

36K		Combination of Indoor Units (kBtu/h Class)														
	Wall Mounted			Ducted		Cassette		Capacity			Efficiency					
	9K	12K	18K	12K	18K	12K	18K	Min	Nominal	Max	SEER	EER	HSPF	COP	E-STAR	
2 Indoor Units			•			•		19796	34000	36300	16.4	11.5	10.0	3.1	Y	
			•				•	19796	34000	36300	17.1	11.5	10.1	3.2	Y	
				••				14397	24000	26400	13.9	9.9	9.0	3.0	N	
				•	•			17996	30000	33000	15.5	11.1	9.0	3.0	N	
				•		•		14397	24000	26400	14.3	10.1	9.5	3.1	N	
				•			•	17996	30000	33000	16.0	11.3	9.5	3.1	N	
					••			19796	33000	36300	15.4	11.0	9.0	3.0	N	
					•	•		19796	33000	36300	16.0	11.3	9.5	3.1	N	
					•		•	19796	33000	36300	15.8	11.2	9.6	3.1	N	
						••		14397	24000	26400	14.7	10.3	10.0	3.1	Y	
						•	•	17996	17996	17996	16.4	11.5	10.0	3.1	Y	
							••	19796	33000	36300	17.1	11.5	10.1	3.2	Y	
	3 Indoor Units	•••							16197	27000	29700	15.8	11.2	10.0	3.1	Y
		••	•						17996	30000	33000	16.4	11.5	10.0	3.1	Y
		••		•					20396	34000	37400	17.5	12.5	10.5	3.4	Y
		••			•				10798	34000	37400	16	11.3	9.5	3.1	N
		••					•		10798	34000	37400	17	12.3	10.0	3.3	N
		••						•	10798	34000	37400	16.4	11.5	10.0	3.1	Y
		••						•	10798	34000	37400	17.5	12.5	10.5	3.4	Y
		•	••						20396	34000	37400	17.1	12.0	10.4	3.3	Y
		•	•	•					20396	34000	37400	17.5	12.5	10.4	3.4	Y
		•	•		•				10798	34000	37400	16.7	11.8	9.8	3.2	N
		•	•				•		10798	34000	37400	17.0	12.3	10.0	3.3	N
		•	•					•	10798	34000	37400	17.1	12.0	10.4	3.3	Y
•		•						•	10798	34000	37400	17.5	12.5	10.5	3.4	Y
•			••					20396	34000	37400	17.5	12.5	10.5	3.4	Y	
•			•	•				10798	34000	37400	17.0	12.3	10.0	3.3	N	
•			•					•	10798	34000	37400	17	12.3	10.0	3.3	N
•			•					•	10798	34000	37400	17.5	12.5	10.5	3.4	Y
•							••	10798	34000	37400	17.5	12.5	10.5	3.4	Y	
•								•	10798	34000	37400	17.5	12.5	10.5	3.4	Y
•								•••	20396	34000	37400	17.5	12.5	10.5	3.4	Y
•			••	•					20396	34000	37400	17.5	12.5	10.5	3.4	Y
•			••		•				20396	34000	37400	17	12.3	10	3.3	N
•			••				•		20396	34000	37400	17	12.3	10	3.3	N
•			••					•	20396	34000	37400	17	12.3	10	3.3	N
•		••						20396	34000	37400	17.5	12.5	10.5	3.4	Y	
•		••						20396	34000	37400	17.5	12.5	10.5	3.4	Y	
•		•	••					20396	34000	37400	17.5	12.5	10.5	3.4	Y	
•		•	•					20396	34000	37400	17.0	12.3	10.0	3.3	N	
•		•	•	•				20396	34000	37400	17.0	12.3	10.0	3.3	N	

PRELIMINARY SPECIFICATIONS

36K	Combination of Indoor Units (kBtu/h Class)															
	Wall Mounted			Ducted		Cassette		Capacity			Efficiency					
	9K	12K	18K	12K	18K	12K	18K	Min	Nominal	Max	SEER	EER	HSPF	COP	E-STAR	
4 Indoor Units		•	•			•		20396	34000	37400	17.5	12.5	10.5	3.4	Y	
		•	•				•	20396	34000	37400	17.5	12.5	10.5	3.4	Y	
		•		•	•			20396	34000	37400	17	12.3	10	3.3	N	
		•		•		•		20396	34000	37400	17	12.3	10	3.3	N	
		•				•	•	20396	34000	37400	17.5	12.5	10.5	3.4	Y	
		•					••	20396	34000	37400	17.5	12.5	10.5	3.4	Y	
			••	•				20396	34000	37400	17	12.3	10	3.3	N	
			••				•	20396	34000	37400	17.5	12.5	10.5	3.4	Y	
			•	•			•	20396	34000	37400	17	12.3	10	3.3	N	
			•	•				•	20396	34000	37400	17	12.3	10	3.3	N
			•		•		•		20396	34000	37400	17	12.3	10	3.3	N
				•••					20396	34000	37400	16.5	12	9.5	3.2	N
				••	•				20396	34000	37400	16.5	12	9.5	3.2	N
				••			•		20396	34000	37400	17	12.3	10	3.3	N
				••				•	20396	34000	37400	17	12.3	10	3.3	N
				•	••				20396	34000	37400	16.5	12	9.5	3.2	N
				•			••		20396	34000	37400	17	12.3	10	3.3	N
					••	•			20396	34000	37400	17	12.3	10	3.3	N
							•••		20396	34000	37400	17.5	12.5	10.4	3.4	Y
							••	•	20396	34000	37400	17.5	12.5	10.4	3.4	Y
							•	••	20396	34000	37400	17.5	12.5	10.4	3.4	Y
		••••							20396	34000	37400	17.5	12.5	10.4	3.4	Y
		•••	•						20396	34000	37400	17.5	12.5	10.4	3.4	Y
		•••		•					20396	34000	37400	17.5	12.5	10.4	3.4	Y
		•••			•				10798	34000	37400	17	12.3	10	3.3	N
		•••				•			10798	34000	37400	17	12.3	10	3.3	N
		•••					•		10798	34000	37400	17.5	12.5	10.4	3.4	Y
		•••						•	10798	34000	37400	17.5	12.5	10.4	3.4	Y
		••	••						20396	34000	37400	17.5	12.5	10.4	3.4	Y
		••			••				10798	34000	37400	17	12.3	10	3.3	N
		••					••		10798	34000	37400	17.5	12.5	10.4	3.4	Y
		••	•		•				10798	34000	37400	17	12.3	10	3.3	N
		••	•				•		10798	34000	37400	17.5	12.5	10.4	3.4	Y
		•	•••						20396	34000	37400	17.5	12.5	10.4	3.4	Y
		•			•••				10798	34000	37400	17	12.3	10	3.3	N
		•					•••		10798	34000	37400	17.5	12.5	10.4	3.4	Y
			••••						20396	34000	37400	16.5	12.0	9.5	3.2	Y
			••		••				20396	34000	37400	17	12.3	10	3.3	N
			••				••		20396	34000	37400	17.5	12.5	10.4	3.4	Y
					••••				20396	34000	37400	17	12.3	10	3.3	N
				••		••		20396	34000	37400	17	12.3	10	3.3	N	
						••••		20396	34000	37400	17.5	12.5	10.4	3.4	Y	

OPTIONAL ACCESSORIES

Refrigeration Line Sets

USED WITH	Length Ft.	Liquid	Suction	Kit#
9000 and 12000 BTU indoor units	15'	1/4"	3/8"	T32150
	35'	1/4"	3/8"	T32350
18000 BTU indoor units	15'	1/4"	1/2"	T42150
	35'	1/4"	1/2"	T42350
24000,30000 and 36000 BTU indoor units	15'	3/8"	5/8"	T53150
	35'	3/8"	5/8"	T53350

Low Ambient Wind Baffle Kit

Wind baffle allows operation down to zero
(Available for Wall-Mounted Single Zone)

WIND BAFFLE	USED WITH
DLAWB1	9000 - 12000 Btu wall-mounted single zone models
DLAWB2	18000 - 36000 Btu wall-mounted single zone models

Thermostat

DWC1-Wired Wall Thermostat (Available for all models)



Low Voltage Condensate Pump
24V Condensate Pumps available from Aspen Pumps by calling 732-248-8066



AquaGuard Condensate Sensor

PRELIMINARY



Friedrich Air Conditioning Co. | 10001 Reunion Place, Suite 500 | San Antonio, TX 78216 | 877.599.5665
www.friedrich.com