

IN SINK ERATOR®

Division of Emerson Electric Co.
Racine, Wisconsin 53406, U.S.A. 

AnswerLine™
1-800-558-5700

Food Waste Disposer Installation, Care & Use Manual

TOOLS AND MATERIALS YOU WILL NEED:

Slotted Screwdriver, Adjustable Pliers,
Plumber's Putty, Electrical Tape

TOOLS, MATERIALS, AND ACCESSORIES YOU MAY NEED:

Phillips Screwdriver, Drain Auger, 3/8" Electrical
Clamp Connector, Wire Nuts (2), Second 1 1/2" Drain
Trap, Hammer, Hacksaw, Water Hose Clamp, Pipe
Wrench, Copper Ground Wire, Dishwasher Drain
Connection Kit, Air Gap, Electrical On/Off Switch,
Drain Tube Extension

Read through the entire Installation, Care & Use
manual before installing the disposer. Determine which of the
tools, materials, and accessories you will need before you begin.
Make sure you have all necessary disposer parts before installing
the disposer. Read through the entire Installation, Care & Use
manual before installing the disposer. Determine which of the
tools, materials, and accessories you will need before you begin.
Make sure you have all necessary disposer parts before installing
the disposer.

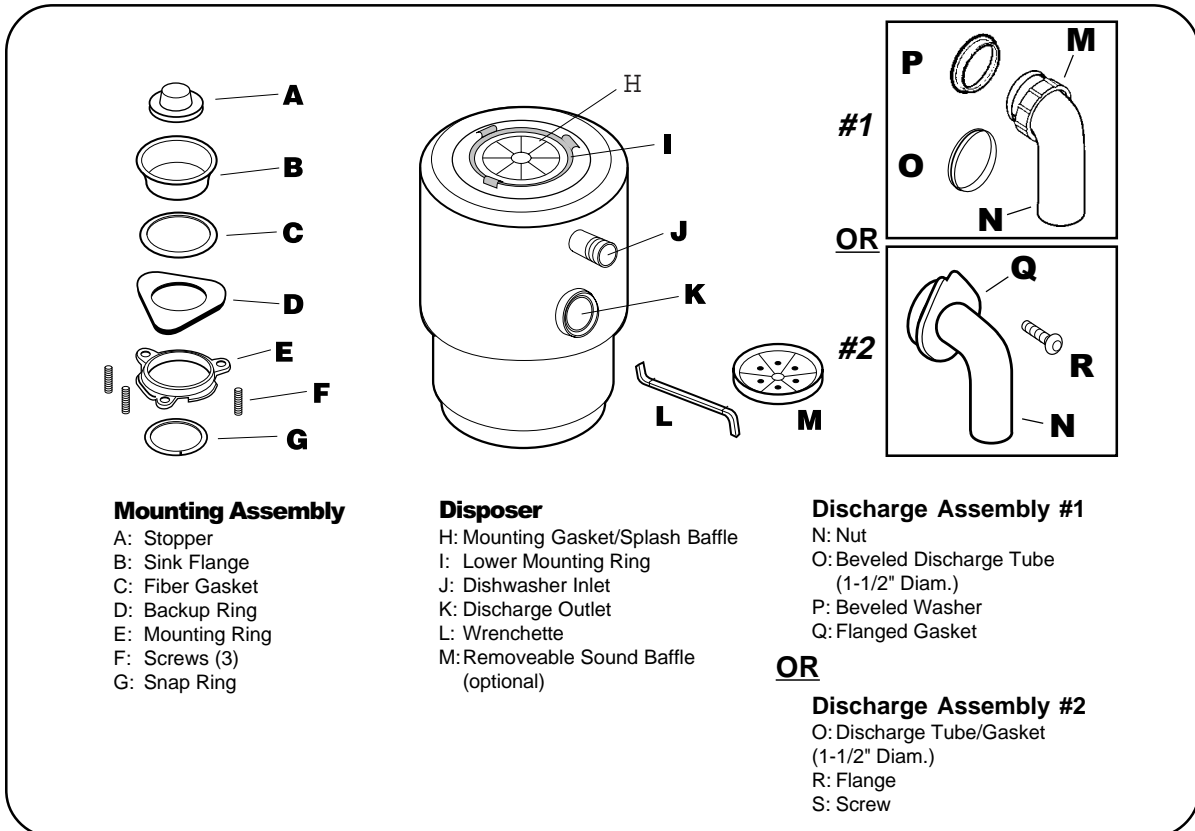

SAFETY SYMBOLS

⚠ WARNING The warning symbol alerts you to potential hazards or unsafe practices which could result in serious personal injury or death.

⚠ CAUTION The caution symbol alerts you to hazards or unsafe practices which may result in minor personal injury or property damage.

1 CHECK INSTALLATION DIMENSIONS

- A: Disposer Height
 B: Distance from bottom of sink bowl to centerline of discharge outlet. (Add 1/2" when stainless steel sink is used.)
 C: Distance from centerline of the discharge outlet to end of discharge tube.
 D: Disposer Width
 E: Distance from disposer vertical centerline to centerline of P-trap connection.
 F: Centerline of disposer discharge to centerline at waste pipe entering wall. (Dimension "F" must be greater than 1/4" to prevent standing water in disposer.)

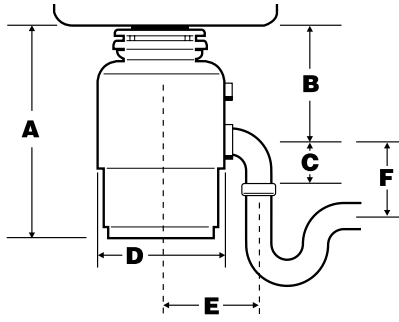

If replacing an existing disposer, skip ahead to Instruction 6.
 If this is a first time installation, continue with Instruction 2.

2 DISCONNECT SINK DRAIN

- Loosen nut (A) at top of "P-trap" with pipe wrench (see Figure 2-1).
- Loosen nut (B) at top of extension pipe. Remove extension pipe.
- Loosen nut (C) at base of sink flange.
 (If nut is corroded or too tight, apply penetrating lubricant.)
- Push sink flange up through sink hole and remove it (see Figure 2-2).
- Clean sink flange area of any putty or other debris.

3 DISASSEMBLE NEW DISPOSER MOUNTING ASSEMBLY

- Insert wrenchette (or screwdriver) into one mounting lug and hold lower mounting ring securely with one hand (see Figure 3-1). With your other hand, turn mounting assembly counterclockwise to remove mounting assembly from lower mounting ring.
- Turn mounting assembly over (see Figure 3-2) and loosen three mounting screws (A) until you can access snap ring (B).
- Use screwdriver to pry snap ring off of sink flange. Mounting assembly will now come apart.

4 INSTALL FLANGE IN SINK HOLE

- Roll 1/4 pound (4 oz.) of non-hardening plumber's putty to make 3/4" thick rope to seal around sink flange.
- Apply putty evenly around sink hole in indentation left by sink flange (see Figure 4-1).
- Align flange so text is readable, and press sink flange slowly but firmly into sink drain hole to seat evenly on putty (see Figure 4-2). Use screwdriver or putty knife to scrape all putty from edge of sink hole.

5 ATTACH UPPER MOUNTING ASSEMBLY TO SINK FLANGE

You may wish to place a weighted object in the sink to hold the sink flange in place. (Place a towel under object in sink to prevent scratching.) Reference Figure 5-1 for part identification.

- Working from under sink, slip fiber gasket and metal backup ring (flat side up) over sink flange.
- Holding fiber gasket and backup ring in place, slip mounting ring over sink flange so it seats against backup ring.
- With the fiber gasket, backup ring, and mounting ring tight to sink bottom. Slide snap ring onto sink flange until it pops into groove on flange*.
- Tighten three mounting screws up to sink until mounting assembly is seated tightly and evenly against sink.

* Placing a thick, wide rubber band around the sink flange (above the snap ring groove) may help hold parts in place while installing snap ring. (Remember to remove rubber band after snap ring is installed.)

If you are replacing an existing disposer, go to Instruction 6.
 If this is a first time installation, skip ahead to Instruction 7.

Model	A	B	C	D	E
*17	15 7/8"	9 7/16"	4"	7 1/2"	5 3/4"
777SS	12 3/4"	6 11/16"	4"	8 1/2"	5 3/4"
77	13 7/16"	6 13/16"	4"	8 1/2"	5 3/4"
555SS	12 3/4"	6 11/16"	4"	8 1/2"	5 3/4"
444	12 5/8"	6"	4"	7 1/4"	5"
333SS	12 3/4"	6 11/16"	4"	7 3/16"	5 3/4"
333	12 3/4"	6 11/16"	4"	7 1/4"	5 3/4"
Bader 5 Plus	12 5/8"	6"	4"	6 3/4"	5"
Badger 5	11 3/8"	6"	4"	6 5/16"	5"
Badger 1	11 3/8"	6"	4"	6 5/16"	5"

* Indicates batch feed model

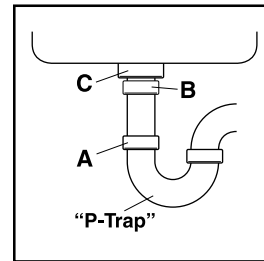

2-1

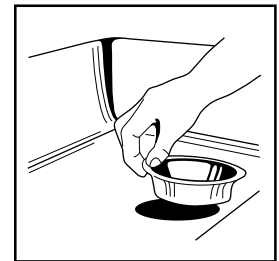

2-2

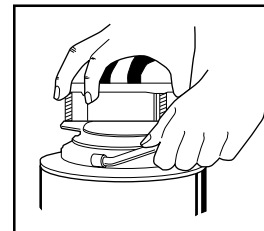

3-1

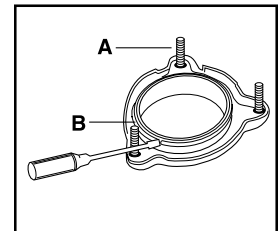

3-2

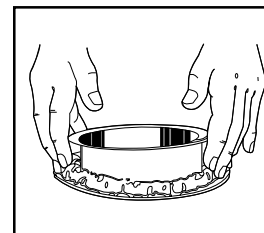

4-1

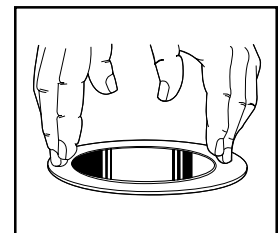

4-2

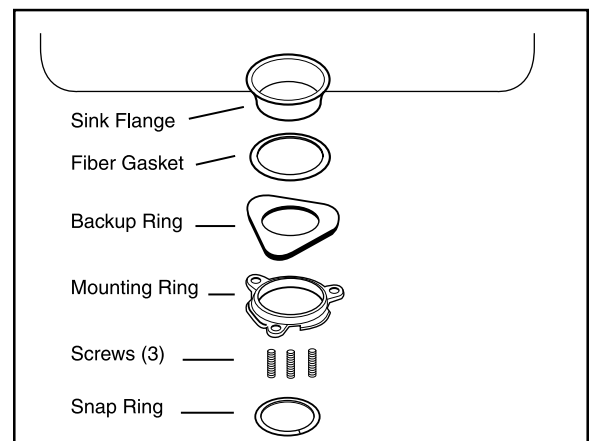

5-1

6 REMOVE EXISTING DISPOSER

1. Turn off electrical power at fuse box or circuit breaker.

⚠ WARNING

Electric Shock

- Turn off electrical power at fuse box or circuit breaker before removing electrical cover plate.
- Disposer must be grounded. Improper connection can result in electric shock.

Personal Injury

- Do not position your head or body under disposer; unit could fall during removal or installation.

2. Disconnect drain trap from disposer waste discharge tube with adjustable pliers (see Figure 6-1). (Also disconnect dishwasher drain connection, if applicable.)
3. Support disposer with one hand and insert end of wrenchette or screwdriver into right side of one mounting lug on lower mounting ring (see Figure 6-2). Lift disposer slightly and loosen lower mounting ring by pushing or pulling wrenchette or screwdriver to left until disposer is free from mounting assembly. (Disposer may be heavy - provide support.)
4. With electrical supply turned off, turn disposer upside down and remove electrical cover plate (see Figure 6-3). Loosen green ground screw and remove wire nuts (see Figure 6-4). Disconnect disposer wires from electrical supply wires. Loosen screw(s) on electrical clamp connector and remove wires from disposer.

- If the new disposer mounting is the same as old one, remove mounting assembly from disposer (Instruction 6) and go to Instruction 7.
- If the new disposer mounting is different from the old one (or you wish to replace the old sink flange) you must complete Steps 5 - 6 (below), and Instructions 2 - 5 (in previous column), then continue with Instruction 7.

5. Loosen three mounting screws, pry snap ring off with screwdriver, and remove old mounting assembly (see Figure 6-5). (Some mounting assembly removal requires additional tools.)
6. Push old sink flange up through sink hole (see Figure 6-6). Use screwdriver or putty knife to scrape all old putty from edge of sink hole.

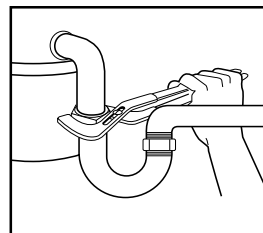

6-1

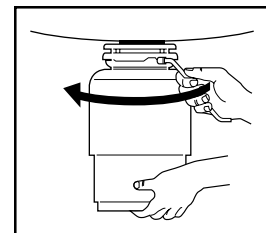

6-2

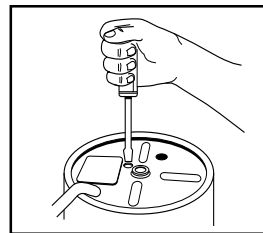

6-3

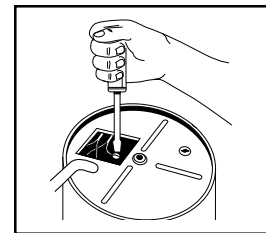

6-4

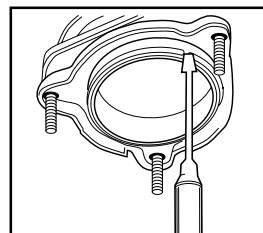

6-5



6-6

7 CLEAN SINK DRAIN LINE

Failure to clean sink drain line may result in drain line blockage.

1. Remove P-trap.
2. With drain auger, clear away all hardened waste material in horizontal drain line.

If you are not connecting a dishwasher to disposer, go to Instruction 9.

8 PREPARE DISHWASHER DRAIN CONNECTION (IF APPLICABLE)

The knockout drain plug should only be removed if you are connecting a built-in dishwasher to the disposer. NOTE --If the dishwasher connection is made without removing the plug, the dishwasher may overflow. (Connections must comply with local plumbing codes.)

Remove Knockout Plug

1. Lay disposer on its side and insert screwdriver into dishwasher inlet so tip rests on outer edge of knockout plug.
2. Tap end of screwdriver handle with hammer until molded plug breaks loose (see Figure 8-1).
3. REMOVE LOOSE KNOCKOUT PLUG FROM INSIDE DISPOSER.

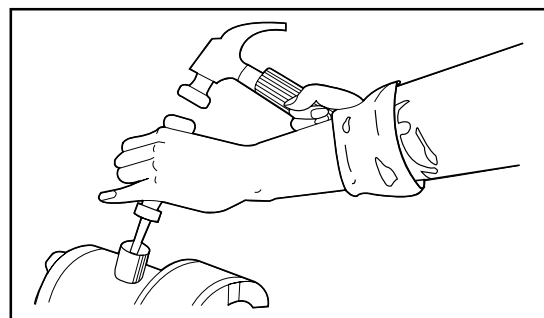

8-1

Attach Dishwasher Drain Connector

If your dishwasher drain hose is 7/8" diameter, go to Instruction 9.

If your dishwasher drain hose is not 7/8" diameter, you must attach a dishwasher drain connector to the dishwasher drain inlet. Follow the installation instructions with the connection kit. (You will connect the dishwasher drain hose to the connector in Instruction 12.)

9 CONNECT DISPOSER TO ELECTRICAL SUPPLY

⚠ WARNING

Electric Shock

- If you are not thoroughly familiar with electric power, contact a qualified electrician to connect disposer to electrical circuit.
- Disconnect power before installing or servicing disposer.
- If three-prong, grounded plug is used, plug must be inserted into three-hole, grounded receptacle.
- Do not modify plug provided with unit (if applicable).
- Improper connection of equipment grounding conductor can result in shock.
- All wiring must comply with local electrical codes.
- Do not attach ground wire to gas supply pipe.
- Disposer must be connected to grounded, permanent wiring system, or circuit conductors must be accompanied by equipment-grounding conductor and connected to equipment grounding terminal or lead on disposer.
- Do not reconnect electrical current at main service panel until proper grounds are installed.

Disposer Circuit Requirements

Ensure the following electrical requirements are met before connecting disposer to switch (see Figure 9-1 for typical direct wired electrical circuit diagram):

- Remove fuse (or open the circuit breaker) before connecting disposer to circuit.
- If junction box is used, connect the junction box to the switch on a separate 15 or 20 Amp, 115 Volt circuit with the appropriate cable. (Use 14 gauge wire with 15 Amp circuit, and 12 gauge wire with 20 Amp circuit).
- Batch feed disposers do not require a separate wall switch - switch is built into disposer and disposer is wired directly into circuit.
- If you install a double receptacle to handle other small kitchen appliances, include a wall switch in disposer receptacle circuit and wire other receptacle directly to power source.
- This disposer requires a switch with a marked "Off" position (wired to disconnect all ungrounded supply conductors) installed within sight of the disposer sink opening (1 HP minimum rating).

Connect Disposer to Electrical Supply/Ground Disposer

Follow these instructions to direct wire the disposer. (If adding a cord and plug, follow the directions included with the cord and plug).

1. Remove electrical cover plate from bottom of disposer and pull out black and white wires (see Figure 9-1). **DO NOT REMOVE CARDBOARD INSULATION SHIELD.**
2. Run electrical cable through access hole (A) on bottom of disposer (with 1/2" conduit or 3/8" flex and secure with clamp connector).
3. Strip wires back approximately 1/2 inch. Connect white (neutral) electrical wire to white disposer wire, and black (hot) electrical wire to black disposer wire with wire nuts (see Figure 9-1). Insulate wire connections with electrical tape, and push connections into disposer housing without displacing cardboard insulation shield. Do not reinstall electrical plate until disposer is properly grounded.

If the circuit you are using **is** grounded at the service panel, attach the ground wire to the green ground screw (B) in the electrical cover plate opening and secure the electrical plate (C) (see Figure 9-1).

If the circuit you are using **is not** grounded at the service panel, complete steps 4 and 5 (below).

4. Attach length of copper wire at least as thick as supply wire to green ground screw (B) and run wire out through electrical plate opening. Secure electrical cover plate (C).
5. If cold water pipe is continuous metal from sink to ground, attach free end of ground wire to your cold water pipe (use UL listed ground clamp). (If a nonmetal pipe is used in your home water connections or water supply pipe, a qualified electrician must install proper ground.)

Grounding Instructions for Cord Connected Units

This appliance must be grounded. In the event of a malfunction or breakdown, grounding provides a path of least resistance for electric current to reduce the risk of electric shock. If this appliance is equipped with a cord having an equipment-grounding conductor and a grounding plug, the plug must be plugged into an appropriate outlet that is properly installed and grounded in accordance with all local codes and ordinances.

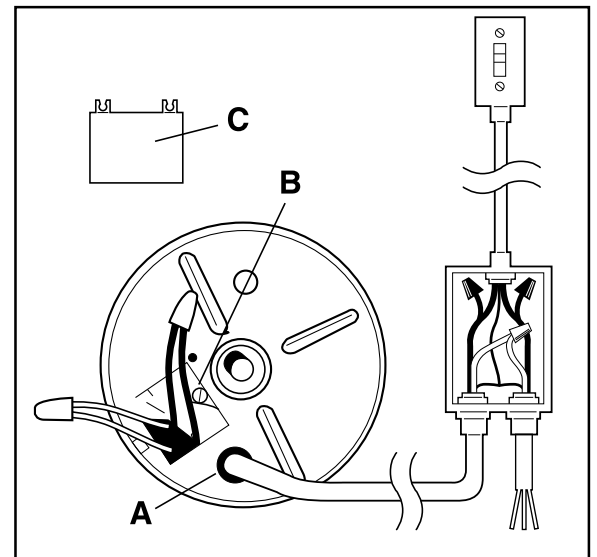

9-1

⚠ WARNING

Improper connection of the equipment-grounding conductor can result in a risk of electric shock. Check with a qualified electrician or serviceman if you are in doubt as to whether the appliance is properly grounded. If plug is provided with the appliance, do not modify it - if it will not fit the outlet, a proper outlet must be installed by a qualified electrician.

10 CONNECT DISPOSER TO MOUNTING ASSEMBLY

Clear any objects from inside the disposer grind chamber before mounting the disposer to the sink.

1. Position disposer with three mounting tabs (A) aligned in position to slide over mounting tracks (B) (see Figure 10-1).
2. Lift disposer, insert top end (mounting gasket) into mounting assembly, and turn lower mounting ring to right (with wrenchette or screwdriver) until mounting tabs lock over ridges (C) on mounting ring tracks (see Figure 10-2). (MAKE SURE ALL THREE MOUNTING TABS ARE LOCKED OVER RIDGES.)

Disposer will now hang by itself. (NOTE: If a removable sound baffle is included with disposer, push baffle into sink opening with "cupped" side upward.)

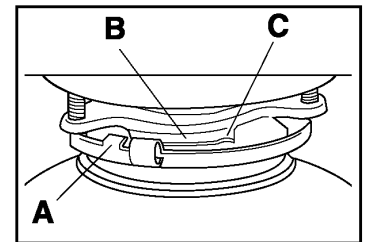

10-1

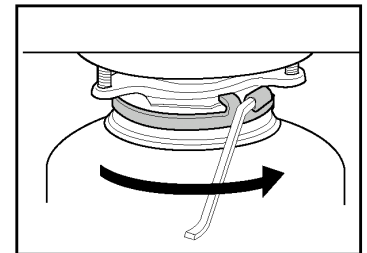

10-2

11 ATTACH DISCHARGE TUBE TO WASTE DRAIN LINE

Determine the appropriate installation based upon previous installation or plumbing configuration: Threaded Discharge or Bolted Discharge.

Threaded Discharge Tube Installation

If replacing existing disposer, remove and discard existing discharge tube. (Unit will not seal properly with old discharge tube.)

1. Slide nut (A) over discharge tube (B), pushing nut over elbow into position (see Figure 11-1). The supplied discharge tube has a beveled end to match the discharge outlet. **Do not use supplied washer or gasket for this installation.**
2. Screw nut onto threaded outlet and tighten with adjustable pliers. **DO NOT OVERTIGHTEN.**
3. Rotate disposer so that discharge tube is aligned with drain trap. (To prevent leaks, do not pull or bend discharge tube to drain trap.) If discharge tube is too long, cut off as much of tube as necessary with hacksaw (make sure cut is straight and clean.) If discharge tube is too short, you can purchase an extension from a hardware store. (Disposer must remain in vertical position to prevent vibration.)
4. Place P-trap nut, then beveled washer (not supplied) on bottom of discharge tube and tighten on drain trap. (If you have a double sink, use separate drain traps for both sides.)
5. Ensure lower mounting ring is securely locked over ridges on mounting flange.

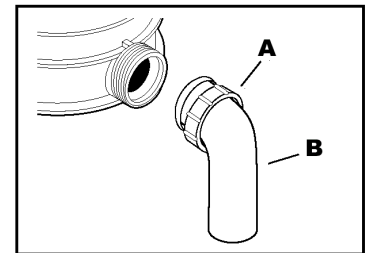

11-1

Threaded Straight Discharge Installation

Although the Discharge Tube installation is preferred, if a straight discharge tube is to be connected to the disposer, follow the steps below. **NOTE:** If existing straight discharge tube lines up with discharge outlet, you may use the nut (A) and the flanged gasket (B) to make the connection, rather than cutting the end of tube as described below (see Figure 11-2).

1. With a hacksaw, cut off flanged end of straight tube, removing as little as poss.
2. With tapered side of beveled washer toward disposer, slide nut (A) and beveled washer (C) over straight tube (see Figure 11-3).
3. Rotate disposer, allowing straight tube to slide into discharge outlet a minimum of 1/2" past edge of outlet. (Disposer must remain in vertical position to prevent vibration.)
4. Tighten nut with adjustable pliers to secure discharge tube. **DO NOT OVERTIGHTEN.**
5. Ensure lower mounting ring is still locked on mounting flange.

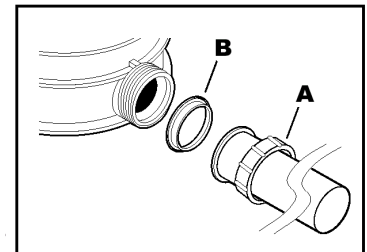

11-2

Bolted Discharge Installation

1. Place metal flange (D) over discharge tube (see Figure 11-4).
2. Secure metal flange and discharge tube to disposer with screw.
3. Complete **Steps 3 - 5** from **Threaded Discharge Tube Installation**, above.

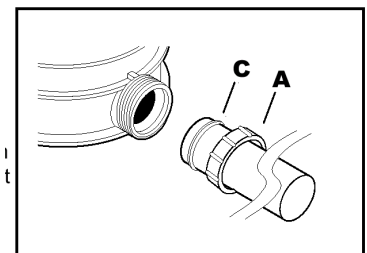

11-3

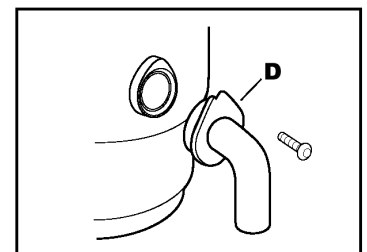

11-4

12 CONNECT DISHWASHER DRAIN (IF APPLICABLE)

Connect the dishwasher to the disposer through an air gap (A) (see Figure 12-1). (Most dishwasher manufacturers recommend that the discharge water runs through an air gap to prevent backflow and/or dishwasher contamination. Ensure knockout plug is removed (see Instruction 8). Plumbing connections must comply with local codes.

- A. If you have a 7/8" diameter dishwasher drain hose, use a hose clamp to attach the drain hose to the dishwasher inlet. (Verify that hose you are using is rated for dishwasher use.)
- B. If you have already attached a dishwasher drain connector to your dishwasher drain hose (for drain hose other than 7/8" diameter), use a hose clamp to attach the drain hose/connector to the dishwasher inlet on the disposer.

13 ATTACH SPECIFICATION DECAL

The disposer specification decal has a removable portion to place on the front side of the installed disposer, containing important information you will need to know in the event service is required.

1. Detach perforated portion of specification decal from lower portion of disposer.
2. Apply decal to the disposer where it can be easily read.

The disposer installation is complete. Run water through the disposer and check under sink for leaks. Read **ALL SAFETY INSTRUCTIONS** on following page

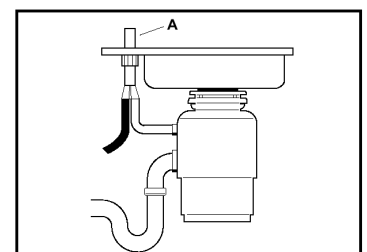

12-1

IMPORTANT SAFETY INSTRUCTIONS

⚠ WARNING

Bodily Injury

- This product is designed to dispose of normal household food waste; inserting materials other than food waste into disposer could cause personal injury and/or property damage. To reduce the risk of injury, do not use the sink containing the disposer for purposes other than food preparation [such as baby bathing or washing hair].
- To reduce risk of injury, supervise operation in presence of children.
- When attempting to loosen a jam in the food waste disposer, use a self service wrenchette as described below. Use long-handled tongs or pliers to remove objects from disposer.
- To reduce risk of injury from material that may be expelled from disposer during use, place stopper in sink opening as shown in Figure A. Do not put following into disposer: drain cleaner, glass, china, plastic or plastic wrap, large bones, metal objects, whole cornhusks, hot grease or hot liquids, clam or oyster shells.
- Do not dispose of the following in the disposer: paints, solvents, household cleaners and chemicals, or automotive fluids.
- Replace anti-splash baffle when worn to help prevent entry or ejection of material and water.
- When not using disposer, leave stopper in place to reduce risk of objects falling into disposer.
- Before pressing reset button, attempting to clear jam, or removing objects from inside disposer, make sure disposer power switch is turned off.
- Do not insert hands or fingers into disposer.
- FIRE HAZARD: Do not store flammable items such as rags, paper, or aerosol cans near disposer. Do not store or use gasoline or other flammable vapors and liquids in vicinity of disposer.

OPERATING INSTRUCTIONS

CONTINUOUS FEED DISPOSERS

1. Remove stopper from sink opening and run strong flow of cold water.
2. Turn on wall switch to start disposer.
3. Slowly insert food waste into disposer and position stopper to minimize possible ejection of material while grinding (see Figure A).
4. After grinding is complete, turn disposer off and run water for at least 15 seconds to flush drain line.

BATCH FEED DISPOSERS

Batch feed disposer differ from continuous feed models in that the batch feed on/off switch is built into the disposer and activated by the stopper.

1. Read important safety instructions contained in the Installation, Care & Use manual.
2. Remove stopper from sink opening and place food waste into disposer grind chamber. Don not pack chamber with waste. Place stopper back in sink opening. Run a strong flow of cold water.
3. Turn on disposer by lifting stopper slightly and turning to left to right until disposer starts. (See Figure B; Seal - Completely in, Drain - Lift 1/4 inch and turn, Start - Turn fully left or right.)
4. After grinding is complete, turn disposer off by removing the stopper and allow water to run for at least 15 seconds to flush drain line.

CLEANING DISPOSER

Over time, food particles may accumulate in the grind chamber and baffle, and an odor from the disposer is usually a sign of grease and food buildup. This buildup can be caused by insufficient water flow during and after disposer use. To clean the disposer:

1. Turn off disposer and disconnect power supply.
2. Reach through sink opening and clean underside of splash baffle and inside upper lip of grind chamber with scouring pad.
3. Place stopper in sink opening and fill sink halfway with warm water.
4. Mix 1/4 cup baking soda with water. Turn disposer on and remove stopper from sink at same time to wash away loose particles.

RELEASING DISPOSER JAM

If the motor stops while the disposer is operating, the disposer may be jammed. To release jam:

1. Turn off the disposer and water.
2. Insert one end of the self-service wrenchette into the center hole on the bottom of the disposer (see Figure C). Work the wrenchette back and forth until it turns one full revolution. Remove wrenchette.
3. Reach into the disposer with tongs and remove object(s). Allow the disposer motor to cool for 3 - 5 minutes and lightly push red reset button on the disposer bottom (see Figure C). (If the motor remains inoperative, check the service panel for tripped circuit breakers or blown fuses.)

DO...

- Grind food waste with strong flow of cold water.
- Grind hard material such as small bones and fruit pits to clean grind chamber.
- Grind citrus and other melon rinds.
- Dispose of small amounts of fats and greases in your disposer.
- Run water for at least 15 seconds after grinding to flush drain line.

DON'T...

- Don't use hot water when grinding food waste (although hot water can be drained into disposer between grinding periods).
- Don't turn off water or disposer until grinding is completed and only sound of motor and water running is heard.
- Don't grind extremely fibrous materials such as corn husks or artichokes (they will plug drain).

SAVE THESE INSTRUCTIONS

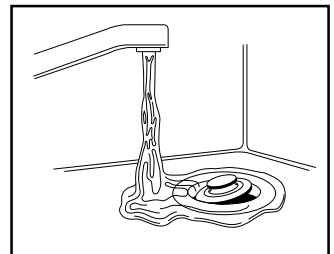

Figure A

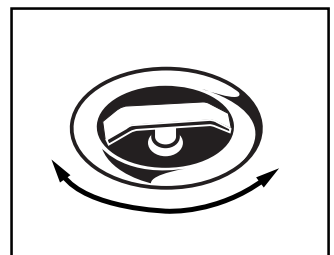

Figure B

⚠ CAUTION

Regularly inspect disposer and plumbing fittings for water leaks, as water leaks can cause property damage. Manufacturer cannot be held responsible for property damage as a result of water leaks.

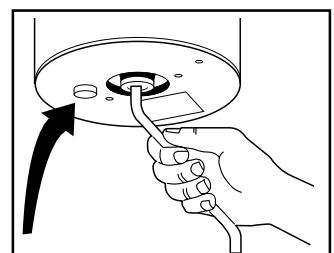

Figure C

IN-SINK-ERATOR® DISPOSER IN-HOME FULL SERVICE WARRANTY

This warranty covers all replacement parts and repair labor to correct defects in disposer material and workmanship for the full warranty period from the date of installation in your home. If warranty service is required during the warranty period, contact an authorized In-Sink-Erator® service center to replace or repair the unit in your home at no cost to you. If you have questions concerning your disposer or determining when service is needed, please call the toll free In-Sink-Erator® Answer-Line™ to obtain the name of the authorized service center nearest you.

The toll free number is 1 (800) 558-5700.

This warranty gives you specific legal rights and you may also have other rights which vary from state to state. If the manufacture determines the unit should be replaced rather than repaired, the warranty on the replacement unit will be limited to the unexpired term of the original warranty. No other express warranty, written or oral, applies.

17 - Seven Year Warranty

777SS - Seven Year Warranty

555SS - Five Year Warranty

444 - Four Year Warranty

Badger 5 Plus - Three Year Warranty

Badger 5 - Two Year Warranty

Badger 1 - One Year Warranty

If your disposer does not operate, follow these steps in order:

1. Check the things you can do yourself. Be sure the disposer is connected to the electric power and the fuses or circuit breakers are in working order. Re-read the instruction book to ensure that you are operating the disposer correctly.

2. Call In-Sink-Erator for information or for the

location of the authorized service center nearest you. (The toll free In-Sink-Erator® AnswerLine™ number is listed above.)

3. Write to us if a satisfactory solution is not reached in steps 1 and 2. Our address is:

In-Sink-Erator

Service Department

4700 21st Street

Racine, Wisconsin 53406 USA

When writing or calling, supply the following information: date, your name, your address, and your phone number. Describe the product by model number, serial number, date purchased, place purchased, and service history (including name and address of service agent). Clearly describe the problem and service required.

NOTE: No separate registration card is enclosed. Warranty is determined by unit serial number and date of installation. Purchase or installation receipt may be required to verify warranty status.