

HTN16ABX

Hotpoint® ENERGY STAR® 15.6 Cu. Ft. Top-Freezer Refrigerator

Dimensions and Installation Information (in inches)

Overall Dimensions	Height to top of hinge (in.) A	61-3/4
	Height to top of case (in.) B	61-1/4
	Case depth without door (in.) C	25-7/8
	Case depth less door handle (in.) D	29-1/8
	Case depth with door handle (in.) E	29-1/8
	Depth with fresh food door open 90° (in.) F	54-7/8
	Width (in.) G	28
	Width with door open 90° inc. door handle (in.) H	28-5/8
Air Clearances	Each side (in.)	3/4
	Top (in.)	1
	Back (in.)	1

Front View

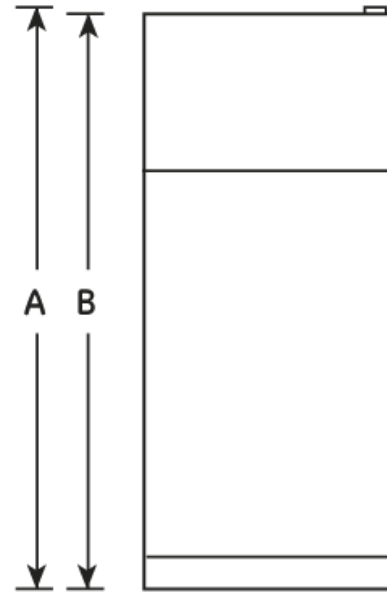

Top View

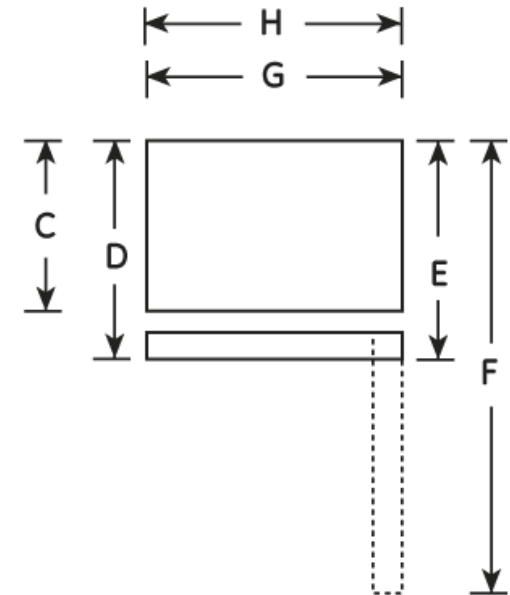

For answers to your Monogram®, GE Profile™ or GE® appliance questions, visit our website at geappliances.com or call GE Answer Center® service, 800.626.2000.



Total volume and shelf area are calculated by the Association of Home Appliance Manufacturers' standards.



Listed by Underwriters Laboratories



As an ENERGY STAR® partner, GE has determined that this product meets the ENERGY STAR guidelines for energy efficiency.



imagination at work

HTN16ABX

Hotpoint® ENERGY STAR® 15.6 Cu. Ft. Top-Freezer Refrigerator

Features and Benefits

- Upfront temperature controls - A simple knob turn regulates interior temperatures with ease
- Recessed handles - Recessed handles make opening and closing the doors simple
- Adjustable wire shelves - Flexible shelving options can be arranged to handle a variety of foods
- Fixed gallon door shelves - Provides the ideal space for storing gallon containers in the door
- One full-width crisper drawer - Maintain fresh tastes with a full-width, humidity-controlled drawer
- Equipped for optional icemaker - Comes complete with the necessary components to include an icemaker
- NeverClean™ condenser - Sealed compartment keeps coils clean and simplifies maintenance
- Model HTN16ABXWW - White

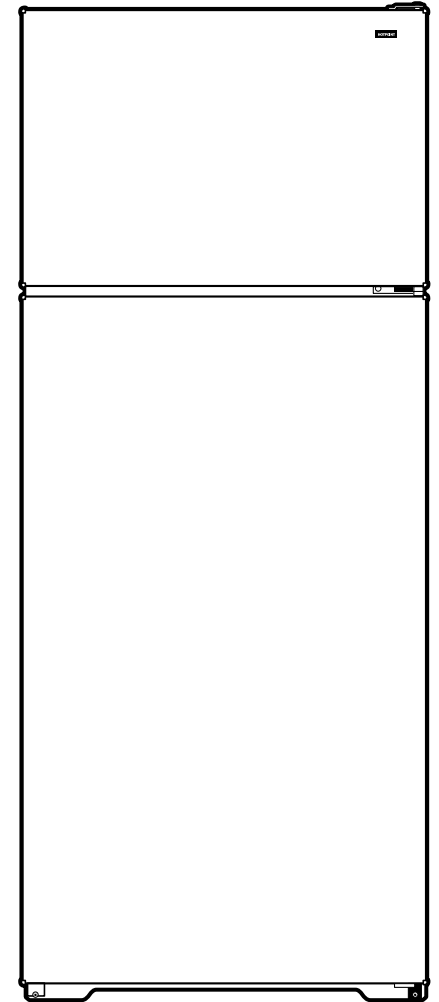

As an ENERGY STAR® partner, GE has determined that this product meets the ENERGY STAR guidelines for energy efficiency.



imagination at work