

## CP171W

79.0" x 23.63" x 23.75" (H x W x D)

Thin-line refrigerator with a bottom freezer, cycle defrost, and deluxe interior

### Highlights:

A bottom freezer makes storage more convenient

Dual compressor design for independent cooling of refrigerator and freezer

Keep ice cream frozen in a zero degree freezer

Ideal 24 inch footprint offers large capacity in slim fit



Bottom freezer	Convenient design with energy efficiency
Cycle defrost	Combines an automatic defrosting refrigerator with a manual defrost freezer to save unit energy and user maintenance
Three slide-out drawers	Unique freezer design features transparent drawers for easy organization and better cold conditions
Energy efficient	Cycle defrost and freezer design uses less energy than standard refrigerator-freezers
Large capacity	12 c.f. of storage space inside a slim 24 inch width
Adjustable glass shelves	Rearrange your refrigerator space to accommodate all shapes and sizes or remove shelves for a simple clean-up
Dual evaporator cooling	Two compressors provides independent cooling of the refrigerator and freezer
Twin crispers	Get the longest life and best taste out of produce by storing greens in two convenient slide drawers
Interior light	Automatically illuminates when you open the door
Designer handles	Modern triangular handles add style and convenience to the exterior

## Specifications:

Height	79.0"
Width	23.63"
Depth	23.75"
Capacity	12.0 cu.ft.
Ext Depth with Handle	25.5"
Interior Height 1	35.25"
Interior Width 1	19.75"
Interior Depth 1	18.5"
Interior Height 2	25.38"
Interior Width 2	17.13"
Interior Depth 2	15.5"
Shipping Weight	251.0 lbs.
Weight	190.0 lbs.
Energy Usage/Year	511.0 kWh/year
US Electrical Safety	UL
Voltage/Frequency	115 V AC/60 Hz
Reversible	Yes
Door Swing	RHD
Crisper Quantity	2
Shelf Quantity	4
Adjustable Shelf	true
Shelf Type	Glass
Crisper Finish	Transparent
Drawer Quantity	3
Wheel Quantity	2
Defrost Type	Cycle
Depth with door at 90°	46.13"
Fan Type	Interior
Light	true
Thermostat Type	Dial
Level Legs Quantity	2
Parts/Labor Warranty	1 Year
Compressor Warranty	5 Years

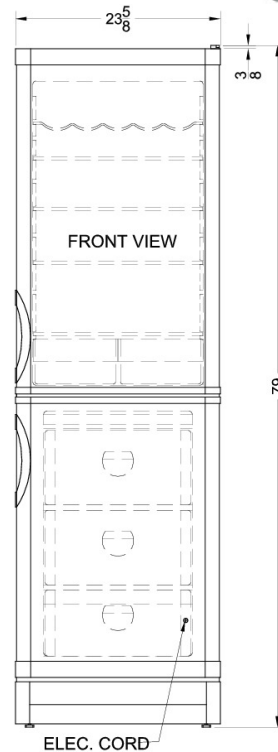
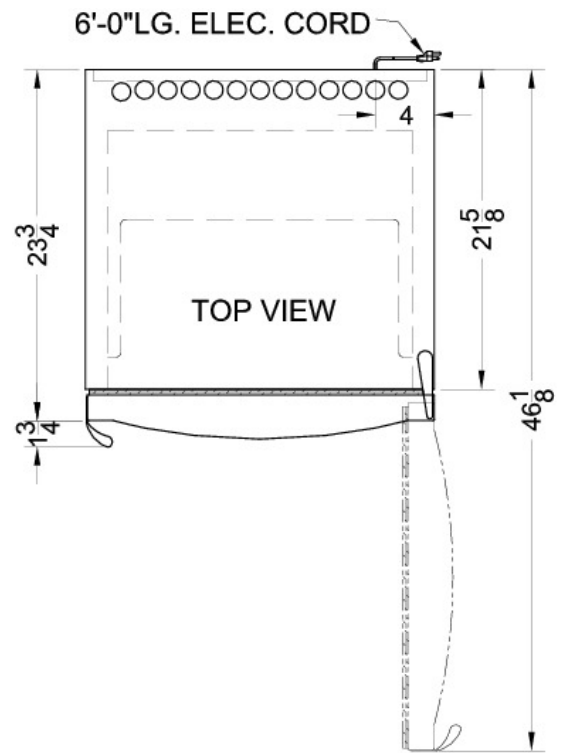

Summit Appliance Division, Felix Storch, Inc.  
 770 Garrison Ave • Bronx, NY 10474  
 Phone: 718-893-3900 • Fax: 718-842-3093  
 Email: info@summitappliance.com