

BIM70ADA

32.5" x 16.75" x 21.25" (H x W x D)

ADA compliant undercounter auto defrost icemaker for built-in or freestanding use, makes 65 lbs. of clear ice per day

Highlights:

32 1/2" height for use in ADA compliant settings

Makes up to 65 lbs. of clear ice in a day cycle

Flexible design allows built-in or freestanding use in 17" wide spaces

Versatile design is ideal for hotels, wet bars, and restaurants



ADA compliant	32 1/2" height fits under lower ADA compliant counters
Slim undercounter dimensions	Less than 17" wide for an easy fit
Built-in capable	Make the best use of space by installing your appliance under the counter
Fully finished stainless steel cabinet	Allows the unit to be used freestanding
Large capacity	Produces up to 65 lbs. of ice in a day cycle, with a 25 lb. storage bin capacity
Clear ice	Gourmet cube ice is crystal clear, measures 1 3/8" diameter by 1 1/8" height
Overfill prevention	Unit senses when bin is full and will automatically stop until cubes are removed
Sliding door	Top lid is on lift-up glides for easy access to the ice bin
Automatic defrost	No-frost system simplifies maintenance
Insulated storage bin	Ice stays frozen longer inside this cold-protected bin

Specifications:

Height	32.5"
Width	16.75"
Depth	21.25"
Weight	91.0 lbs.
US Electrical Safety	UL
Canadian Electrical Safety	ULC
Voltage/Frequency	115 V AC/60 Hz
Door Swing	Sliding
Defrost Type	Automatic
Fan Type	Exterior
Thermostat Type	Dial
Freon Type	R134a
Low Side PSI	120.0
High Side PSI	320.0
Freon Oz	6.88
Parts/Labor Warranty	1 Year
Compressor Warranty	5 Years

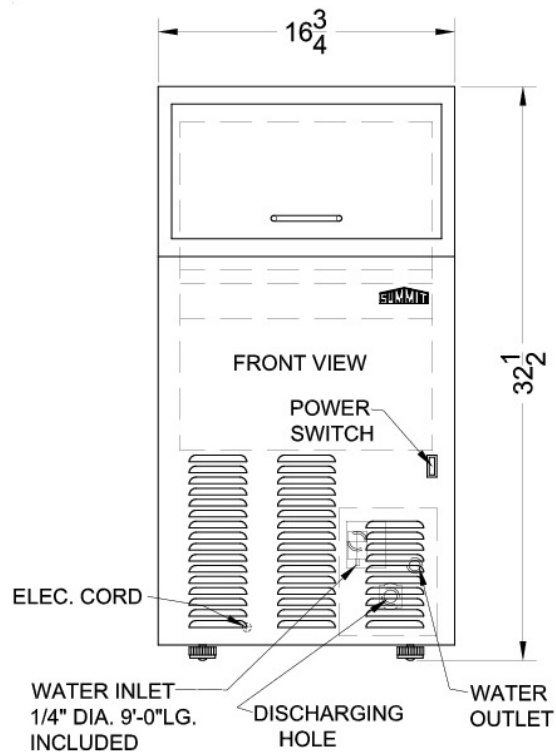
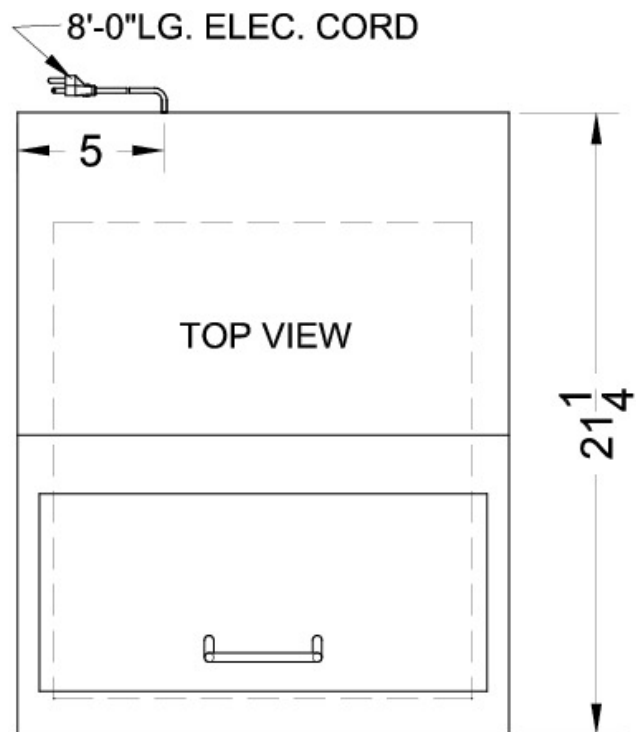

Summit Appliance Division, Felix Storch, Inc.
 770 Garrison Ave • Bronx, NY 10474
 Phone: 718-893-3900 • Fax: 718-842-3093
 Email: info@summitappliance.com