



Stainless

Overlay

## 3036RRGL

3000 SERIES

### FEATURES

#### PERFORMANCE

- U-Select™ Control: Integrated OLED display with intuitive user interface ergonomically located on top of door
- Digitally controlled dual-zone convection cooling system
- Refrigeration capacity of 7.1 cubic feet
- Capacities: 120 12-oz bottles or 254 12-oz cans
- Beverage Mode: 34° to 65°F,
- Sabbath / Black-Out mode
- UL Residential Listing

#### INTERIOR / EXTERIOR

- Six adjustable tempered glass shelves with 11 positions optimize storage space for a wide variety of options
- Black interior with LED theater lighting optimizes elegant display
- Standard commercial stainless steel handle is interchangeable with professional handle option
- LowE coated, argon gas filled thermopane glass door provides protection from harmful UV rays and added insulating energy efficiency
- Robust, concealed and covered hinges with built-in door stop and closer
- Convenient crisper drawer comes in handy to store smaller items and keep them fresh

#### INTEGRATION

- Standard commercial stainless steel handle is interchangeable with professional handle option
- Adjustable toe-kick - front to back and up and down allows for seamless installation
- Front adjustable rear leveling legs greatly eases installation
- Allow a 2-1/2" clearance on hinged side for 90° door opening when installed adjacent to a wall (for stainless steel model)
- Allow 1/4" width overall for proper installation (see backside for details)
- No additional clearance around sides, top or rear of unit is needed for ventilation



Adjustment and configuration of shelves allows for storing taller items

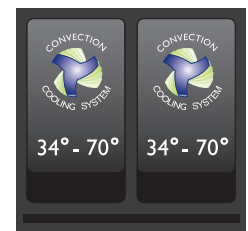

Dual Zone System featured in 3036RRGL

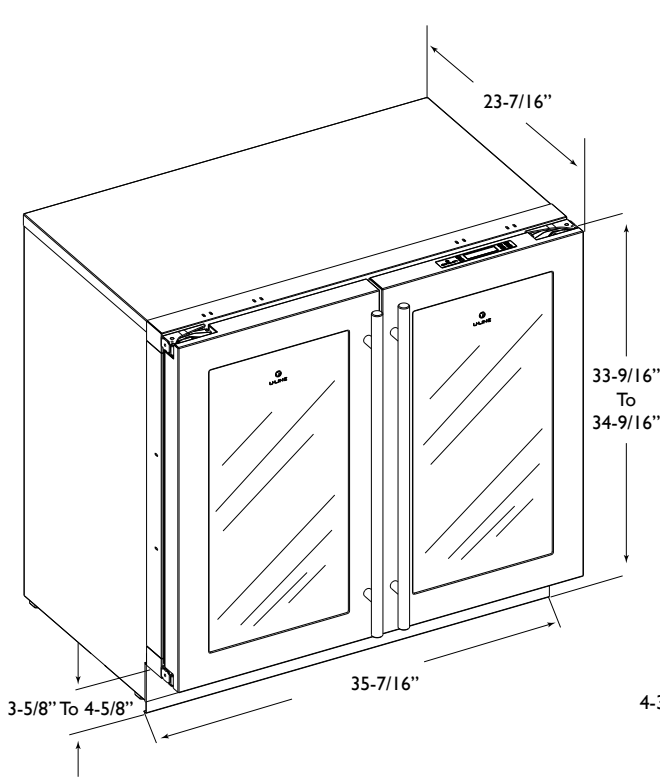

3036RRGLS Stainless Model

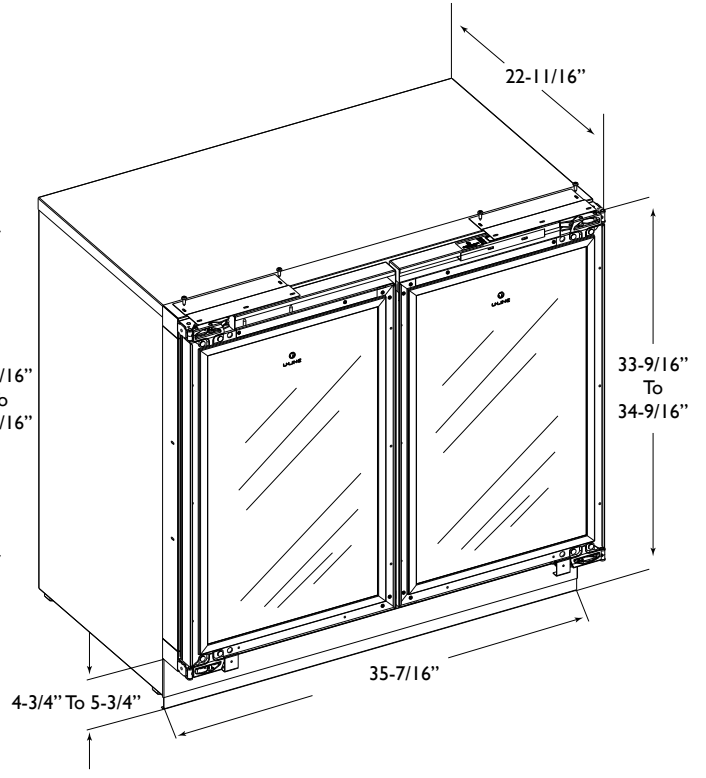

3036RRGLOL Overlay Model

**DIMENSIONS AND SPECIFICATIONS**

**OVERALL DIMENSIONS**

Height	33-9/16" (85.2)
Width	35-7/16" (90)
Depth	23-7/16" (60)
With stainless steel handle	25-5/16" (64.3)

**Shipping weight:**

Stainless model	214 lbs (97 kg)
Overlay model	204 lbs (92.5 kg)

Running amps	2.4
Amps pertain to voltage rating	110/115 Volt, 60 Hz

**Capacities:**

Refrigerator volume	7.1 Cu Ft
---------------------	-----------

3036RRGL	
Stainless	U-3036RRGLS-00
Overlay	U-3036RRGLOL-00

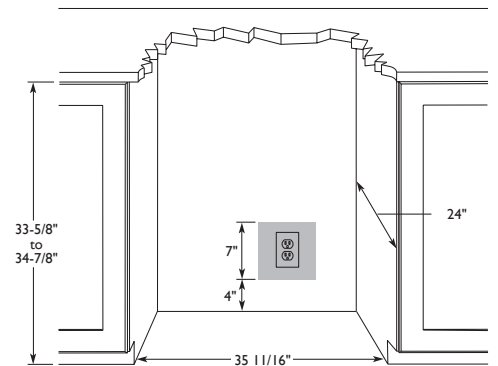

Please visit [www.u-line.com](http://www.u-line.com) for installation guide.

All specifications are subject to change without notice.