



Speed Queen®
Laundry — it's all we do.



Dryers and Stack Dryers

(Electric/Gas)

ADE4BR/ADG4BR

ADE3LR/ADG3LR

ADE4BF/ADG4BF

ADE30R/ADG30R

ASE30F/ASG30F (Stack)



Dryer and Stack Dryer Specifications

Model	Electric: Gas:	ADE4BF ADG4BF	ADE4BR ADG4BR	ADE3LR ADG3LR	ADE30R ADG30R	ASE30F ASG30F
Appearance						
Color: White		✓	✓	✓	✓	✓
Front Controls		✓				✓
Rear Controls			✓	✓	✓	
Commercial Steel Cylinder		✓	✓	✓	✓	✓
Secured Lint Filter		✓	✓	✓	✓	✓
Cylinder Light		✓	✓	✓	✓	
Reversible Door		✓	✓	✓	✓	
Door Windows						✓
Galvanized Steel Cabinet		✓	✓	✓	✓	✓
Extra-Large Door Opening (2.06 sq. ft.)		✓	✓	✓	✓	✓

Technical Information						
Drum Capacity - cu. ft.	7	7	7	7	7	7 each (14 total)
Overall Dimensions - H x W x D	41 3/8" x 26 7/8" x 28"	43" x 26 7/8" x 28"	43" x 26 7/8" x 28"	43" x 26 7/8" x 28"	43" x 26 7/8" x 28"	75 1/4" x 26 7/8" x 28"
Work Surface Height - in	41 3/8"	36"	36"	36"	36"	N/A
Approximate Shipping Weight - lb	155 electric model 160 gas model	140 electric model 145 gas model	140 electric model 145 gas model	140 electric model 145 gas model	140 electric model 145 gas model	255 electric model 265 gas model
Electrical Requirements (Electric) Breaker Size	240V/60 HzAC/1 Ph 30 Amp	240V/60 HzAC/1 Ph 30 Amp	240V/60 HzAC/1 Ph 30 Amp	240V/60 HzAC/1 Ph 30 Amp	240V/60 HzAC/1 Ph 30 Amp	2 x 240V/60 HzAC/1 Ph 2 x 30 Amp
Electrical Requirements (Gas) Breaker Size	120V/60 HzAC/1 Ph 15 Amp	120V/60 HzAC/1 Ph 15 Amp	120V/60 HzAC/1 Ph 15 Amp	120V/60 HzAC/1 Ph 15 Amp	120V/60 HzAC/1 Ph 15 Amp	2 x 120V/60 HzAC/1 Ph 2 x 15 Amp
Electric Heating Wattage	5350	5350	5350	5350	5350	5350 per pocket
Gas Consumption - Btu	22,500	22,500	22,500	22,500	22,500	22,500 per pocket
Motor HP	1/3	1/3	1/3	1/3	1/3	2 x 1/3

Performance/Features						
Automatic Dry Cycles	✓	✓	✓	✓	✓	✓
Multiple Vent Options	✓	✓	✓	✓	✓	✓
Heavy-Duty 220 cfm Exhaust Fan	✓	✓	✓	✓	✓	✓
Quiet, Efficient Blower	✓	✓	✓	✓	✓	✓
Adjustable End-of-Cycle Buzzer	✓	✓	✓	✓	✓	✓
Extended Tumble	✓	✓				
ADA Compliant	✓					✓ (lower dryer)

Dry Cycles						
Cycles	4	4	3	3	3	3 (each dryer)

Optional Accessories						
Multiple Vent Kit	528P3	528P3	528P3	528P3	528P3	528P3
LP Conversion Kit	649P3	649P3	649P3	649P3	649P3	649P3
Dryer Rack	included	included	512082P	512082P	512082P	512082P
Agency Approvals	UL, CSA Star, MA Gas Board	UL, CSA Star, MA Gas Board	UL, CSA Star, MA Gas Board	UL, CSA Star, MA Gas Board	UL, CSA Star, MA Gas Board	UL, CSA Star, MA Gas Board

For the most accurate information, the installation guide should be used for all design and construction purposes. Due to continuous product improvements, design and specifications are subject to change without notice. The quality management systems of Alliance Laundry Systems' Ripon facility has been registered to ISO 9001:2000. Printed in the USA.

©Copyright 2009 Alliance Laundry Systems LLC

Speed Queen Warranty

Speed Queen brings to you the industry's best warranty on all of our washers and dryers.

3 years on parts and labor.

5 years on the motor.*

5 years on the cabinet.*

* Limited. See Speed Queen warranty bond for details.

ADE4BR/ADG4BR (Shown on front)

4 Cycles, Adjustable End-of-Cycle Buzzer, Extended Tumble, Dryer Rack, Auto Dry Cycles

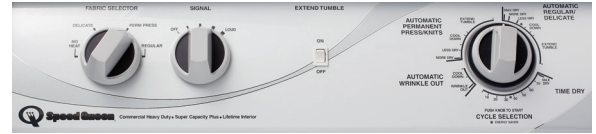

ADE3LR/ADG3LR

3 Cycles, Adjustable End-of-Cycle Buzzer, Auto Dry Cycles

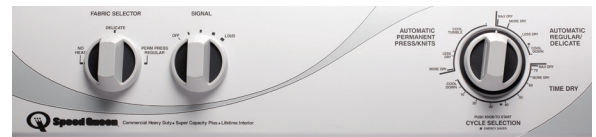

ADE30R/ADG30R

3 Cycles, Auto Dry Cycles

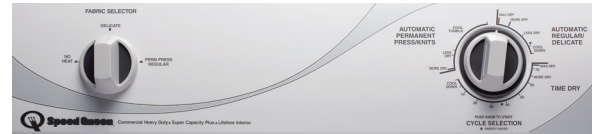

ADE4BF/ADG4BF (Front Control)

4 Cycles, Adjustable End-of-Cycle Buzzer, Extended Tumble, ADA Compliant, Dryer Rack, Auto Dry Cycles

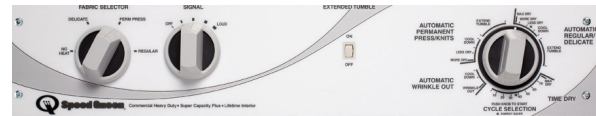

ASE30F/ASG30F (Stack Dryer/Dryer)

3 Cycles, ADA Compliant (lower dryer), Auto Dry Cycles

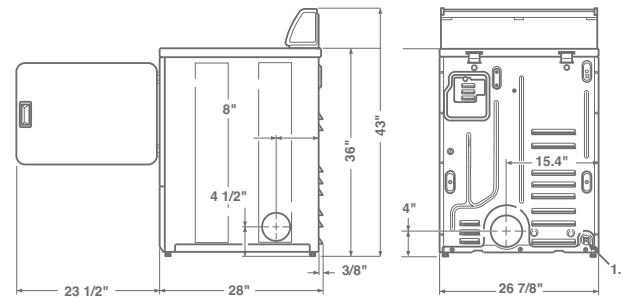
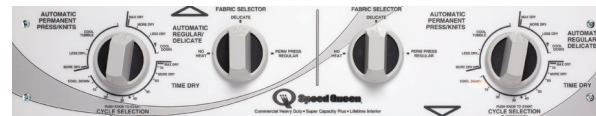

Rear control only

1 3/8" NPT Gas Connection DRY2003N 07761

