



Side-by-Side Refrigerator

FPUS2686L F

26 Cu. Ft. Standard-Depth



Product Dimensions

| | |
|-------------------------------------|---------|
| Height (Including Hinges & Rollers) | 69-3/8" |
| Width | 36" |
| Depth (Including Door) | 33" |

More Easy-To-Use Features

PowerPlus™ Ice³

PowerPlus™ Ice delivers up to 37 percent more ice.

PowerPlus™ Freeze

Quickly freeze whatever you store to keep foods at their freshest.

PureAir Ultra™ Filters

Keeps the air cleaner and fresher.

SpillSafe® Shelves

Designed to keep spills contained, making cleanup a breeze.

Pro-Select™ Controls

Easily select options with the touch of a button.

EnergySaver™ Plus Technology⁴

Our refrigerator will automatically go into an energy-saving mode if not opened for 24 hours.

Performance Lighting

Beautiful, ramp-up lighting keeps contents clearly visible.

Signature Features



Largest Crisper Drawers¹

Store more in our largest capacity crisper drawers.



SpaceWise™ Organization System

Our SpaceWise™ organization system makes it easy to keep food organized and easy to find when you need it.



Real Stainless Steel

Real stainless steel with a protective coating that reduces fingerprints and smudges so it's easy to clean.



Best-in-Class Ice & Water Filtration²

PureSource Ultra™ Water Filtration offers best-in-class water filtration so you get cleaner, better-tasting water at your fingertips.

ENERGY STAR® Maximum Efficiency⁵
Sabbath Mode (Star-K® Certified)



Available in:



Stainless
(F)

¹As compared to other side-by-side models.

²As compared to other consumer refrigeration water filtration systems.

³In a 24-hour period.

⁴If this refrigerator door is not opened for 24 hours AND the refrigerator system is set to the 12-hour defrost cycle, then the system automatically goes to a 96-hour compressor run time defrost cycle to conserve electricity.

⁵Exceeds minimum ENERGY STAR® standard by at least 30%.

| Features | |
|---|---------------------|
| Door Design | Soft-Arc |
| Door Handle Design | Stainless Steel |
| Cabinet Finish | Grey |
| Door Stops/Door Closers | Yes/Yes |
| Door Hinge Covers | Hidden |
| Rollers - Front/Rear | Adjustable/Yes |
| EnergySaver™ Plus Technology | Yes |
| Water Filter Location | Top Right Rear |
| Sound Package | Quiet Pack |
| Dispenser | |
| Controls | Pro-Select™ |
| Dispenser Design | Tall, Single Paddle |
| Number of Dispenser Buttons | 11 |
| Crushed Ice/Cube Ice/Chilled Water | Yes/Yes/Yes |
| Ice Option | PowerPlus™ Ice |
| Freeze Option | PowerPlus™ Freeze |
| Display On/Off Option | Yes |
| Lock/Light | Yes/Yes |
| Temp/Door Ajar/Power Failure Alerts | |
| Water Filter Change Indicator Light | Yes |
| Air Filter Change Indicator Light | Yes |
| Refrigerator Features | |
| Interior Lighting | Performance |
| Water Filter Type | PureSource Ultra™ |
| Air Filter Type | PureAir Ultra™ |
| Fixed Shelves | 1 SpillSafe® |
| Sliding Shelves | 2 SpillSafe® |
| Cool Zone™ Drawer | 1 Stacked |
| Wine/Can Rack | |
| Upper Crisper/Lower Crisper | 1 Clear/1 Clear |
| Humidity Controls | 2 |
| Dairy Compartment | 1 Clear |
| Fixed Door Bins | 2 Two-Liter Clear |
| Adjustable Door Bins | 2 One-Gallon Clear |
| Non-Slip Bin Liner/Bottle Retainers | Yes/1 Clear |
| Condiment Bin | |
| Freezer Features | |
| Door Bins/Tilt-Out Wire Door Bins | 2 White/2 |
| Fixed Shelves | 1 Flip-Out/1 Wire |
| Full Extension Baskets | |
| Full Freezer Baskets | 1 Plastic/1 Wire |
| Half Freezer Baskets | |
| Ice Cream Shelf/Pizza Shelf | Yes/Yes |
| SpaceSaver™ Shelf | |
| Lighting | Yes |
| Certifications | |
| ENERGY STAR® Maximum Efficiency ¹ | Yes |
| Sabbath Mode (Star-K® Certified) | Yes |
| Specifications | |
| Total Capacity (Cu. Ft.) | 26 |
| Refrigerator Capacity (Cu. Ft.) | 16.5 |
| Freezer Capacity (Cu. Ft.) | 9.5 |
| Power Supply Connection Location | Right Bottom Rear |
| Water Inlet Connection Location | Left Bottom Rear |
| Voltage Rating | 120V/60Hz/15 or 20A |
| Connected Load (kW Rating) @ 120 Volts ² | 1.02 |
| Amps @ 120 Volts | 8.5 |
| Minimum Circuit Required (Amps) | 15 |
| Shipping Weight (Approx.) | 300 Lbs. |

¹Exceeds minimum ENERGY STAR® standard by at least 30%.

²For use on adequately wired 120V, dedicated circuit having 2-wire service with a separate ground wire. Appliance must be grounded for safe operation.

Standard Refrigerator Depth vs. Counter Depth

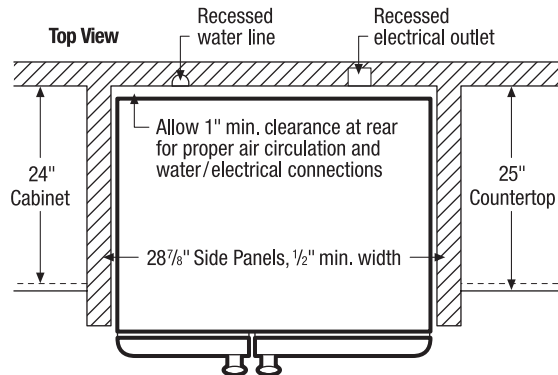
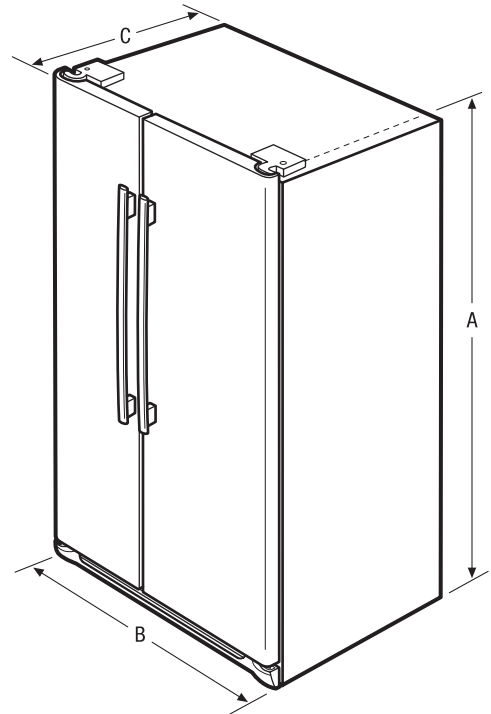
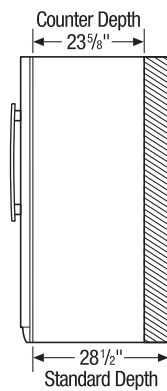

NOTE: For planning purposes only. Always consult local and national electric and plumbing codes. Refer to Product Installation Guide for detailed installation instructions on the web at frigidaire.com.



| Overall Exterior Dimensions | |
|---------------------------------------|---------|
| A - Height (Incl. Hinges and Rollers) | 69-3/8" |
| B - Width | 36" |
| C - Depth (Incl. Door) | 33" |
| Depth with Door Open 90° | 49-7/8" |

FRIGIDAIRE

USA • 10200 David Taylor Drive • Charlotte, NC 28262 • 1-800-FRIGIDAIRE • frigidaire.com
CANADA • 5855 Terry Fox Way • Mississauga, ON L5V 3E4 • 1-800-265-8352 • frigidaire.ca

FPUS2686L 08/10

© 2010 Electrolux Home Products, Inc.

Accessories information available on the web at frigidaire.com

Specifications subject to change.
Printed in the U.S.A.