

# Frigidaire

## Factory Parts Catalog

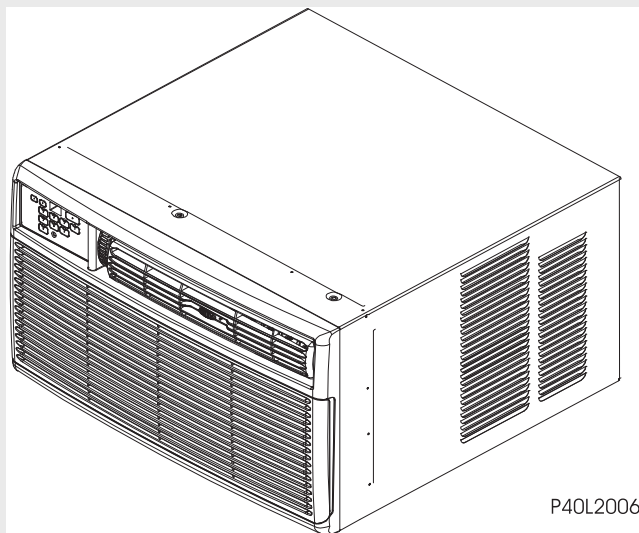

P40L2006

Product No.	FAM156R1AA	FAM156R1AB
Series	Median	Median
Color	white	white
Volts	115	115
BTU-Cooling	15,100	15,100
Owner's Guide	2020219A0576	2020219A0576
Installation Instructions	2020219A0577	2020219A0577
Market	North America	North America

 **Electrolux**

Electrolux Major Appliances  
North & Latin America  
P.O. BOX 212378  
AUGUSTA, GA 30917

Publication No.  
**5995542700**  
09/06/11  
(EN/SERVICE/WTC)  
099

**ROOM AIR  
CONDITIONER**

**Model No.  
FAM156R1**

Copyright © 2009 Electrolux Home Products, Inc.  
All rights reserved.

RECOMMENDED SPARE PARTS

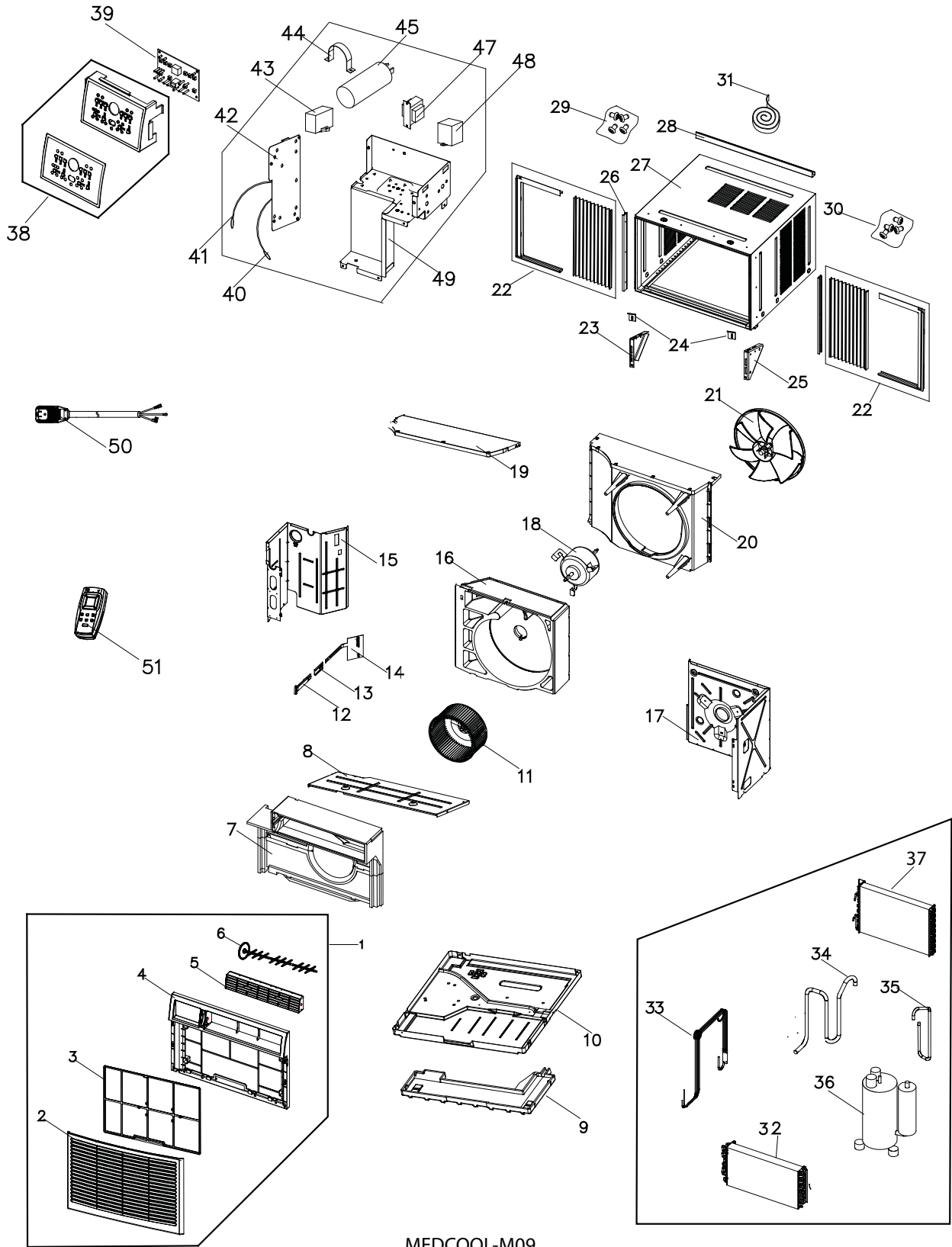

MEDCOOL-M09

**RECOMMENDED SPARE PARTS**

*Model Index:* A FAM156R1 (FAM156R1AA)  
B FAM156R1 (FAM156R1AB)

POS. NO	PART NO.		DESCRIPTION
1	5304472522	A B	Front Panel Assy., incl/2, 3, 4, 5, 6
2	5304472523	A B	Panel, front grille, tilt-out
3	5304472524	A B	Filter, air
3 #	5304471199	A B	Remote Control, transmitter
4	5304472525	A B	PANEL, FRAME, FRONT, frame, front
5	5304472526	A B	Louver, horizontal
6	5304472527	A B	Louver, vertical
7	5304472528	A B	Scroll, blower housing, front
8	5304472529	A B	Cover, blower scroll, front
9	5304472530	A B	Tray, drip pan
10	5304472531	A B	Base, unit chassis
11	5304472532	A B	Blower Wheel, centrifugal fan
12	5304472533	A B	Handle, vent control
13	5304472534	A B	Link, lever/vent door, detent
14	5304472535	A B	DOOR, VENT CONTROL, W/LEVER, vent control, with lever
15	5304472536	A B	Bulkhead, partition, front left
16	5304472537	A B	Scroll, blower housing, rear
17	5304472538	A B	Bulkhead, partition, front right
18 #	5304472539	A B	Motor, fan
19	5304472540	A B	Cover, condenser/fan, top
20	5304472541	A B	Shroud, condenser fan
21 #	5304472356	A B	Fan Blade, axial flow
22	5304472542	A B	Window Filler Kit, slider panels
23	5304472358	A B	Bracket, mounting, left, window
24	5304472360	A B	BRACKET, SILL ANGLE, sill angle
25	5304472359	A B	Bracket, mounting, right, window
26	5304472543	A B	Retainer, shutter mount, cabinet side
27	5304472544	A B	Cabinet, wrapper/sleeve
28	5304472545	A B	Rail, top
29	5304472546	A B	Screw Kit, top rail mount
30	5304472547	A B	Hardware, mounting, screws/locks
31	5304472548	A B	Seal kit, foam, top, bottom, sash
32 #	5304472549	A B	Evaporator
33 #	5304472550	A B	Tube, capillary
34 #	5304472551	A B	Tube, suction
35 #	5304472552	A B	Tube, discharge
36 #	5304472553	A B	Compressor
37 #	5304472554	A B	Condenser
38 #	5304472561	A B	Control Panel, with overlay
39 #	5304472562	A B	PC Board, input/display
40 #	5304471383	A B	Thermistor, evaporator, sensor
41 #	5304471276	A B	Thermistor, temp sensor, indoor
42 #	5304472416	A B	PC Board, main control
43 #	5304470990	A B	Capacitor, fan motor
44	5304472557	A B	Strap, capacitor mtg.
45	5304472558	A B	Capacitor
47	5304470989	A B	Transformer
48 #	5304472559	A B	Ionizer, clean air
49	5304472560	A B	Control Box
50 #	5304470995	A B	Power Cord, electric, LCDI

**WIRING DIAGRAM**

MED Electronic with Ionizer --- 202021990044

