



cook better. eat better. taste better. live better.

Aga 6WCA 115V

Installation
Operation &
Maintenance
Instructions

Welcome

Remove Packaging

Your wine chiller has been packed for shipment with all parts that could be damaged by movement securely fastened. Before using, be sure all packing materials and tape have been removed.

Important

Keep your carton packaging until your wine chiller has been thoroughly inspected and found to be in good condition. If there is damage, the packaging will be needed as proof of damage in transit.

Installing Your Refrigerated Wine Cooler

Select Location	3
Cabinet Clearance	3
Electrical Connection	3
Grounding Method	3

Operation

Set the Control	4
Loading Tips and Suggestions	4
Inserting Wine Bottles	4

Appliance Features

Adjustable Temperature Control	5
Interior Light Switch	5
Roll-out Racks	5
Single Bottle Racks	5

Cleaning and Maintaining Your Wine Cooler

Condenser	6
Cabinet	6
Interior	6
Glass Door	6
Door Gasket	6
Light Tube Replacement	6

Troubleshooting

In the Event of a Power Failure	7
Help Prevent Tragedies	7
Disposal	7
Important Safety Issue	7
If You Need Service	7

Agc Customer Care

For Your Records	8
------------------------	---

Warranty Information

Warranty	9
----------------	---

Installing Your Refrigerated Wine Cooler

Select Location

The proper location will ensure peak performance of your appliance. Choose a location where the unit will be out of direct sunlight and away from heat sources. Best performance will be maintained when installed within the following parameters:

Ideal Ambient Temperature Range	
Built-in	65° – 80°F
Free-Standing	65° – 90°F.

A gap of 24in (606mm) is recommended between units for moving the wine chiller. A clearance of 3in (76mm) is required to the side of the unit that the hinges are located on to allow for the door to open 90° degrees. Please see diagram for recommendations for built in applications.

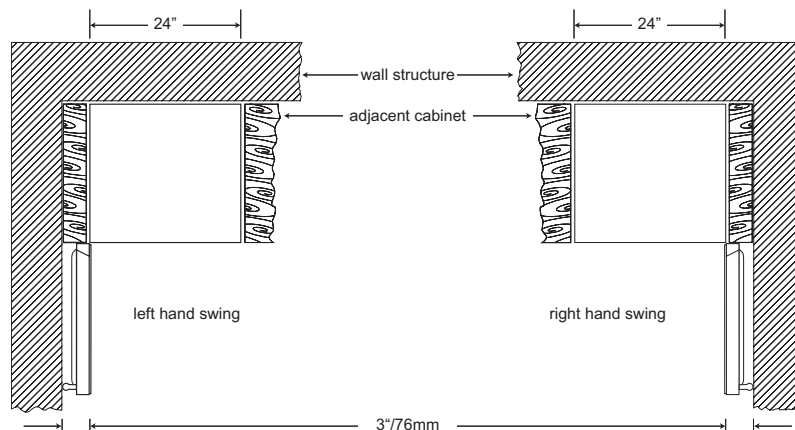

Cabinet Clearance

Adjacent cabinets and countertop can be installed on top, back and sides of the unit as long as the grille and door access remain unobstructed. Ventilation is required for the bottom front section of the unit where the grille is located. Keep this area open and clear of any obstructions.

Make certain that the leveling legs supplied with the wine cooler are installed according to the instructions. Leveling adjustments can be made by raising or lowering the glides on the bottom of the unit.



WARNING

DISCONNECT POWER SOURCE BEFORE ADJUSTING LEVELING LEGS

Electrical Connection

Use nominal 115 volt, 60 cycle AC only. DO NOT USE AN EXTENSION CORD

Grounding Method

This product is factory equipped with a power supply cord that has a three-pronged grounded plug. It must be plugged into a mating grounding type receptacle in accordance with the National Electrical Code and applicable local codes and ordinances. If the circuit does not have a grounding type receptacle, it is the responsibility and obligation of the customer to exchange the existing receptacle in accordance with the National Electrical Code and applicable local codes and ordinances. The third ground prong should not, under any circumstances, be cut or removed. All U.L. listed refrigerated products are equipped with this type of plug.



WARNING

THIS UNIT SHOULD NOT, UNDER ANY CIRCUMSTANCES, BE UNGROUNDED.

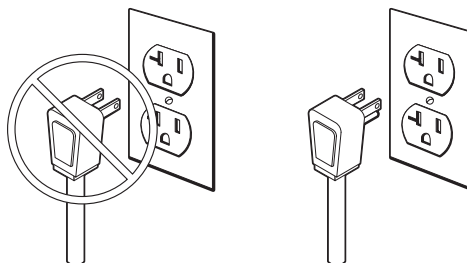

Operating Your Refrigerated Wine Chiller

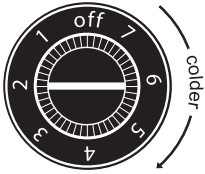

Set the Control

The total available temperature range of the unit is from 41°F to 63°F. The middle range on the control is approximately 56°F. The temperature can be lowered or raised by turning the control clockwise or counterclockwise, respectively. As with any refrigeration product, there is a slight temperature variance at different locations within the cabinet. For example, the coolest bottles will be in the middle shelves. The bottles on the top two shelves will be 3° to 5°F warmer. This is the warmest location. The bottles in the front of the shelves will be 3° to 5°F warmer than the rear of the shelves. Position your wine inventory accordingly. To start your appliance, use a screwdriver to turn the control clockwise to the middle thermostat setting. Once the bottles are loaded, allow at least 48 hours for the unit to stabilize before making any adjustments to the initial setting.

We recommend you place a small thermometer inside the wine chiller that is visible when looking through the glass door. This will help you establish the cabinet interior temperature you wish to store your wine collection at.

Loading Tips and Suggestions

Bottom rack may be removed for storing “jug” wines.

You may store magnums and other large bottles on the bottom floor rack or you may store magnums and other large bottles on any of the roll-out racks by removing the rack directly above them, except for the top rack.

Position white wines on the middle or lower racks and red wines on the upper racks.

The bottles on the top rack directly under the light will be exposed to a slightly higher temperature when the light is on. Position your wines accordingly and **REMEMBER TO TURN OFF THE LIGHT WHEN IT IS NO LONGER NEEDED.**

Keep wines that you plan to use for everyday drinking and entertaining on the front half of the racks where labels are completely visible. Place wines for aging or longer term storing in rear.

Insert Wine Bottles

The six roll-out wine racks each hold eight bottles, two deep with the necks alternating from front (rear bottles) to back (front bottles). The bottom floor rack holds six bottles that are loaded with necks facing the rear. Tall bottles should not be loaded on the bottom rack because they may prevent the door from closing.

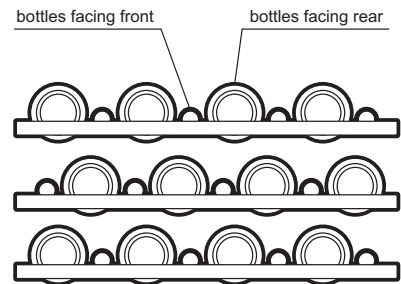

Appliance Features

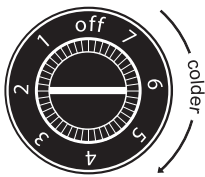

Adjustable Temperature Control

The temperature control is fully adjustable from 41-63°F. The range allows flexibility of temperature preferences and provides the ideal wine aging and storing temperatures.

Interior Light and Switch

The interior light makes it easy to view your wine labels and enhances the display of your collection. When the switch is in the "OFF" position, the light will come on when the door is opened.

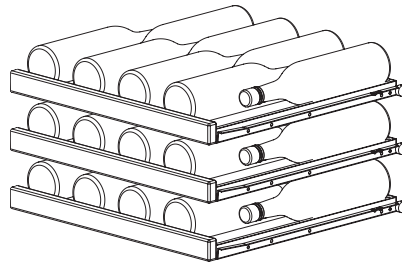
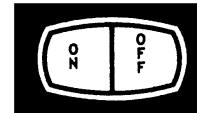

Roll-out Racks

The six-roll out wine racks may be pulled out approximately 14in (355mm) to facilitate adding or removing bottles. Do not lean on or press down heavily on the wine shelves. Doing so may damage the shelves and the wine bottles stored on them. Pull the wine racks out gently and carefully to minimize unsettling your wine collection. Avoid pulling out more than one rack at any time to maintain stability.

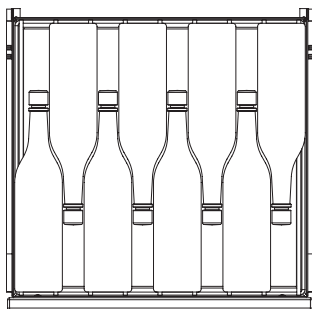

Single Bottle Racks

Because bottles are not stacked on top of each other, you can easily view and access your inventory without disturbing other bottles.

Cleaning and Maintaining Your Wine Chiller

Condenser

The condenser tubing inside the cabinet does not require frequent cleaning; however, satisfactory cooling depends on adequate ventilation over the coils. Be sure that nothing obstructs the required air flow openings in front of the cabinet. At least once or twice a year brush or vacuum lint and dirt from the grille. Also at least once or twice a year brush or vacuum lint and dirt from the condenser for efficient performance by unscrewing the grille on the bottom front of the cabinet.

Cabinet

The painted cabinet can be washed with mild soap and water and thoroughly rinsed with clear water. Never use abrasive scouring powders.

Interior

Wash interior compartment with mild soap and water. Do not use an abrasive powder, solvent, polish cleaner or undiluted detergent.

Glass Door

Use a glass cleaner or mild soap and water and soft cloth to clean the glass door model. Do not use any abrasive powders.

Door Gasket

The vinyl gasket may be cleaned with mild soap and water, a baking soda solution or a mild scouring powder.

Light Tube Replacement

WARNING! DISCONNECT THE POWER CORD BEFORE ATTEMPTING LIGHT TUBE REPLACEMENT. Failure to do so may result in an electrical shock that could severely injure you.

This product uses two, 6 watt light tubes to illuminate the interior of the wine chiller. The light tubes are very reliable electrical components, but should either or both light tubes not function properly, please call the dealer you purchased your wine chiller from for replacement light tubes. Use only original equipment light tubes from your dealer or manufacturer.

Light tube replacement consists of using a small cross head screwdriver to remove the two screws that hold a cover plate over the back section of the light tube. Set the screws and cover plate aside for re-assembly later.

Using a small flat-blade screwdriver, gently lever the front section of the light tube down to allow it to be pulled clear of the light housing.

Disconnect the two insulated electrical connectors from the cabinet's electrical cable and discard the old light tube. Reconnect the insulated electrical connector of the new light tube to the cabinet's electrical cable connectors. Make sure they are secure and fully inserted.

Carefully realign the light tube's electrical terminals back into the rear of the light enclosure channel making sure not to crimp them. Gently insert the light tube along the length of the light enclosure channel. Press the light tube gently into the light enclosure channel. Only a small part of the light tube should project below the ceiling of the wine chiller. **DO NOT USE A HAMMER TO FIT THE LIGHT TUBE.**

Place the light tube terminal cover plate back in its original position on the light enclosure's flange. Re-use the original two screws to secure it in place. Plug the wine chiller into the electrical socket. Check to see if the light tubes operate properly. Your light tube's replacement is complete.

The light tubes are not covered by your guarantee. Replacement tubes can be obtained from your service provider or from Aga Appliances.

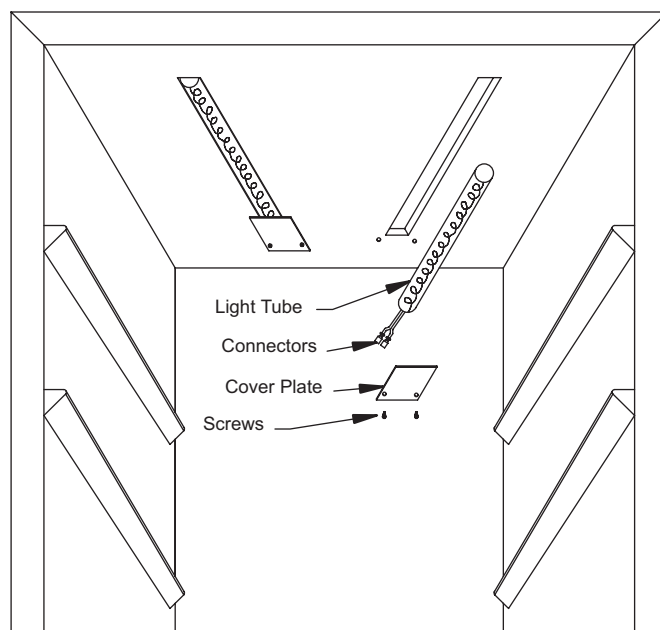

Troubleshooting

In the Event of a Power Failure

Most power failures are corrected within two hours and will not affect the unit's temperature providing you minimize the number of door openings while the power is off. A gradual rise in temperature should not have any adverse effect on your wine if power is out for a longer period. If it is extremely hot, you may want to move your wines to the coolest location you can find until power is restored.

Help Prevent Tragedies

Each year children die because they climb inside a discarded refrigeration product, get trapped inside and suffocate. Take precautions to prevent such tragedies by removing the door, taping or chaining it shut before discarding.

Disposal

When you dispose of this product, do so in a way sympathetic to the environment. For further information contact your local authority.

Important Safety Issue

In using your wine chiller only pull out one shelf at a time access your wine bottles. When you are finished using a shelf, push it gently back into the cabinet before pulling out the next shelf.

What to Do If You Need Service

Before calling for service, check the trouble shooting table. This table lists possible problems that you can remedy without difficulty to avoid an unnecessary service call.

If you do need service, contact your dealer or the manufacturer. In any correspondence, refer to the model number and serial number of your unit which is located on the lower front cabinet flange. Retain your proof of purchase. You may want to record these numbers in the space provided on page 7. Follow the procedure outlined on page 8.

<i>Problem</i>	<i>Possible Causes/Solutions</i>
Odor in cabinet	<ul style="list-style-type: none">• Interior needs cleaning
Noisy operation	<ul style="list-style-type: none">• Cabinet not level• Weak floor
Cabinet vibrates	<ul style="list-style-type: none">• Cabinet not level• Weak floor
Cabinet light not working	<ul style="list-style-type: none">• Tube burned out• No power at outlet
Appliance will not run	<ul style="list-style-type: none">• Temperature control turned to "OFF"• Line cord not plugged in• No power at electrical outlet• House fuse blown
Appliance runs too long	<ul style="list-style-type: none">• Prolonged door openings• Control set too cold• Condenser needs cleaning
Moisture collects inside	<ul style="list-style-type: none">• Too many door openings• Prolonged door openings• Hot, humid weather increases condensation
Moisture collects on outside surface	<ul style="list-style-type: none">• Hot, humid weather increases condensation. As humidity decreases, moisture will disappear.• Control improperly set.
Interior too hot/too cold	<ul style="list-style-type: none">• Control improperly set• Faulty thermometer• Relocate thermometer to center of cabinet and recheck

Aga Customer Care

Aga Customer Care

If you have difficulty, or a problem with your appliance, this leaflet will help you to resolve the matter.

Please complete the appliance details below and keep them safe for future reference - this information will enable us to accurately identify your particular appliance and help us to help you. Filling this in now will save you time and inconvenience if you later have a problem with your appliance. It may also be of benefit to keep your purchase receipt with this leaflet. You may be required to produce the receipt to validate a warranty field visit.

For Your Records

Date of Purchase		
Dealer's Name		
Dealer's Address		
Dealer's City	Dealer's State	Dealer's Zip
Appliance Serial No.		
Model No.		

Warranty Information

Household Refrigeration Products Limited Warranty

Entire Product - Limited One Year Parts and Labor Warranty. Aga Ranges warrants that it will supply all necessary parts and labor to repair or replace in the end user's home or office, any component which proves to be defective in materials or workmanship, subject to the condition and exclusions stated below, for period of one year from date of purchase by the end user.

Additional Second Through Fifth Year Limited Parts Only Warranty

During the four years following expiration of the One Year Limited Warranty, Aga Ranges will supply replacement parts for the hermetically sealed refrigeration system which consists of the compressor, condenser, drier, connecting tubing and the evaporator that are proven to be defective due to workmanship or materials subject to the conditions and exclusions below.

The above warranties do not cover:

- Shipping costs of replacement parts or returned defective parts.
- Customer education or instructions on how to use the refrigerator/freezer.
- Any content loss due to product failure. - Removal or installation.

Nor do the above warranties cover failure of this product or its components due to:

- Transportation or subsequent damages.
- Use commercially or use other than normal household or office.
- Improper installation, misuse, abuse, accident or alteration, use on wiring not conforming to electrical codes, low voltage, failure to provide necessary maintenance, or other unreasonable use.
- Parts or service not supplied or designated by Aga Ranges.

The above warranties also do not apply if:

- The original Bill of Sale, deliver date or serial number cannot be verified.
- Defective parts are not returned for inspection if so requested by Aga Ranges.
- The refrigeration equipment is not in the possession of the original end use purchaser.

THE WARRANTIES SET FORTH HEREIN ARE THE ONLY WARRANTIES EXTENDED BY AGA RANGES. ANY IMPLIED WARRANTIES, INCLUDING THE IMPLIED WARRANTY OF MERCHANTABILITY, ARE LIMITED TO THE DURATION OF THESE EXPRESS WARRANTIES. IN NO EVENT SHALL AGA RANGES BE LIABLE FOR ANY CONSEQUENTIAL OR INCIDENTAL DAMAGES OR EXPENSES RESULTING FROM BREACH OF THESE OR ANY OTHER WARRANTIES, WHETHER EXPRESSED OR IMPLIED.

Some states do not allow the exclusion or limitation of consequential damages or limitations on how long an implied warranty lasts, so the above exclusion or limitation may not apply to you. This warranty gives you specific legal rights, and you may also have other rights which may vary from state to state.

No person, firm or corporation is authorized to make any other warranty or assume any other obligation for Aga Ranges. These warranties apply only to products used in any of the fifty states of the United States and the District of Columbia.

To obtain performance of this warranty, report any defects to:

Aga Ranges/Refrigeration Products Division (Warranty Administration)

*P.O. Box 997
Richmond, Indiana
47375
USA*

1.800.243.1624

IN NO EVENT SHALL THE COMPANY BE LIABLE FOR INCIDENTAL OR CONSEQUENTIAL DAMAGES INCLUDING, BUT NOT LIMITED TO, CONTENT LOSS.

Some states do not allow limitations on length of time implied warranty may last, so the above limitations may not apply to you.

This warranty gives you specific legal rights. You may also have other rights which vary from state to state.

Notes

Aga Ranges/Refrigeration Products Division

P.O. Box 997 • Richmond, Indiana • 47375 • USA • 1.800.243.1624