

Exploded View of Wash System

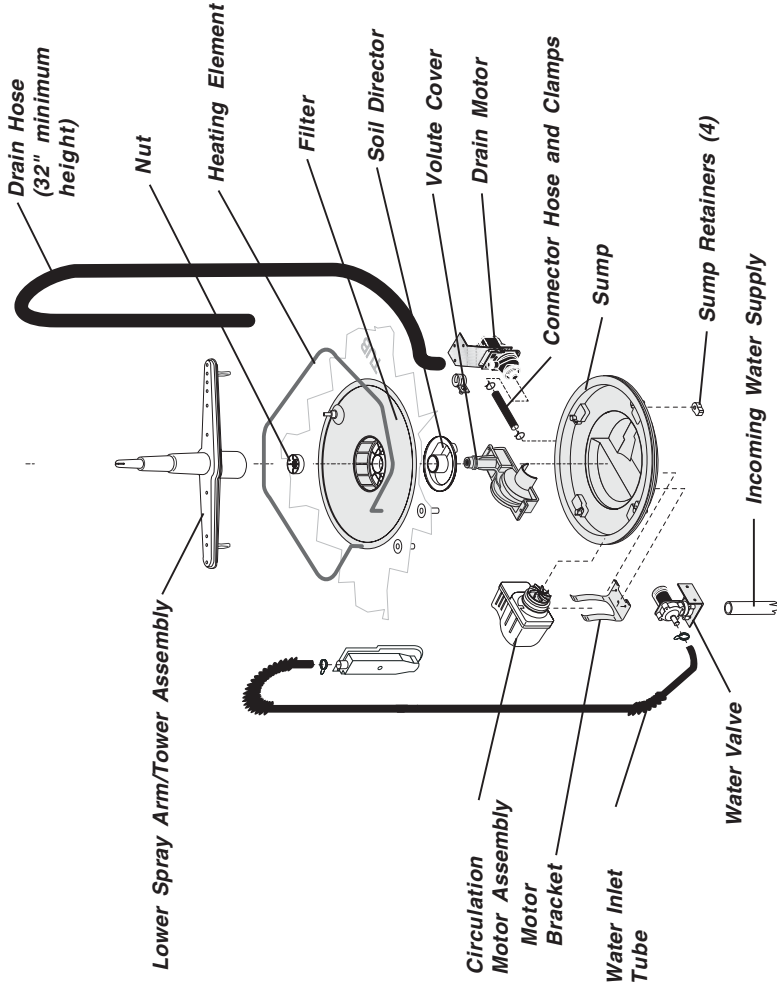

Pump Assembly

The pump assembly is driven by a synchronous motor. Rotation is in the counterclockwise direction at 3600 RPM. The motor drives a pump which supplies 100 percent filtered water at a rate to approximately 12 GPM.

Draining is accomplished by using a small separate synchronous drain pump mounted to the side of the sump. The drain pump is connected to the main pump by a small rubber hose. The drain check valve is located at the discharge end of the drain pump. The drain hose is attached by a worm gear clamp to the discharge end of the drain pump.

900 Watt Heater

Refer to the cycle chart on the reverse side to determine when the heater is on during the wash cycle.

The drain hose must have a loop at a **minimum height of 32 inches** in order to insure proper drainage.

The main pump can easily be removed by disconnecting the drain pump connector hose and the wiring harness connections made at the circulation motor and rotating the four sump retainers toward the middle of the sump.

Voltage checks of the heater should be made with the timer set in the main wash.

Tub and Door Seal

The door seal is pressed into the tub channel for an interference fit. Center the gasket (marked on back) at the tub top center and press in place without stretching or bunching. The gasket takes a short turn at the bottom of the tub channel before ending at the channel end wall.

Gasket Cross Section

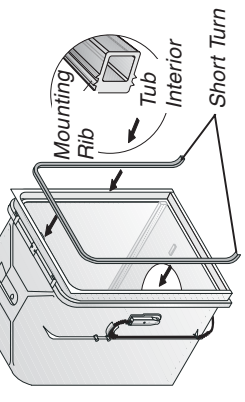

Product Specifications

Electrical	
Rating	120 Volts, 60Hz
Separate Circuit	15 amp min. - 20 amp max.
Motor (Amps)	1.1
Heater Wattage	900
Total Amps (load rated)	10.0

Water Supply

Minimum incoming water temperature	120°F (49°C)
Pressure (PSI) min./max.	20/120
Connection (NPT)	3/8"
Consumption (Normal Cycle)	7.2 gal., 6.0 imp. gal., 27.3 liters

Trouble Shooting Tips

⚠ WARNING



Electric Shock Hazard

Disconnect electrical power at the fuse box or circuit breaker box before adjusting or replacing components. Failure to follow this warning could result in death or serious injury.

Check the list below each symptom. Repair or replace defective components as encountered.

Symptom. . . Dishwasher will not operate when turned on (wait at least 90 seconds).

1. Fuse (blown or tripped).
2. 120 VAC supply wiring connection faulty.
3. Timer (contacts open or defective)
4. Motor (inoperative).
5. Door switch (open contacts).
6. Door latch not making contact with door switch.
7. Selector switch (open contacts).

Symptom. . . Motor hums but will not start or run.

1. Motor (bad bearings or locked rotor).
2. Motor stuck due to prolonged non-use.

Symptom. . . Motor trips out on internal thermal overload protector.

1. Improper voltage.
2. Motor shaft binding.
3. Motor windings shorted.
4. Glass or foreign items in pump.

Symptom. . . Dishwasher runs but will not heat.

1. Heater element (open).
2. Timer defective.
3. Wiring or terminal defective.

Symptom. . . Dishwasher will not pump out.

1. Drain restricted.
2. Timer contact defective.
3. Defective drain pump.
4. Air lock in drain hose.
5. Blocked impeller.
6. Open windings.

Symptom. . . Dishwasher will not fill with water.

1. Water supply turned off.
2. Defective water inlet fill valve.
3. Check fill valve screen for obstructions.
4. Defective float switch.
5. Timer contact defective.
6. Wiring defective.
7. Float stuck in "UP" position.

Symptom. . . Timer does not advance.

1. Timer motor (stalled or open.)
2. Check timer for power to timer motor.
3. Timer shaft binding to or knob interference with escutcheon.

Symptom. . . Dishwasher water siphons out.

1. Drain hose (high) loop too low--must be a minimum height of 32 inches.
2. Drain line connected to a floor drain not vented. (Install air gap at counter top.)

SERVICE DATA SHEET

P/N: 154441501

Models: Tower Wash Series

This information is intended for use by persons having electrical and mechanical training and a level of knowledge of these subjects generally considered acceptable in the appliance repair trade. Electrolux Home Products North America cannot be responsible, nor assume any liability, for injury or damage of any kind arising from the use of this Service Data Sheet.

Color Code

BK.....Black R.....Red
 BU.....Blue VIO.....Violet
 BU-O.....Blue/Orange W.....White
 PK.....Pink R-Y.....Red/Yellow

Timer Block

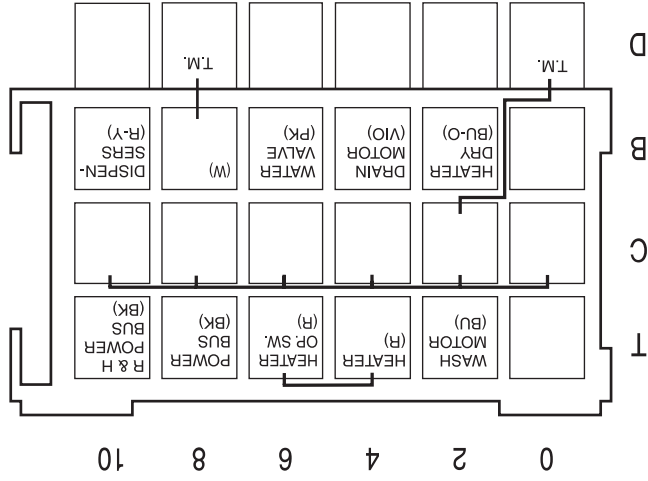

Cycle Chart

Cycle	DETECT	WASH MOTOR	VIO	4B	DRAIN MOTOR	PK	6B	FILL VALVE	R	4T	HEATER WASH	BU-O	2B	HEATER DRY	R-Y	10B	DISPENSER	8T	PWR BUSS	TIME IN MINUTES	INTERVAL SECONDS
OFF																				2	95
POTS & PANS																				3	88
NORMAL WASH																				5	100
LIGHT WASH																				7	8
																				5	100
																				3	88
																				2	95
RINSE & HOLD OFF																				10	100
																				8	200
																				5	200
																				2	100
																				102	100
																				99	100
																				97	200
																				94	200
																				91	200
																				84	100
																				82	200
																				79	200
																				76	100
																				74	2
																				74	98
																				72	100
																			71	100	
																			69	100	
																			67	88	
																			66	92	
																			64	8	
																			64	3	
																			64	97	
																			62	100	
																			61	100	
																			59	100	
																			57	100	
																			56	88	
																			54	92	
																			53	8	
																			53	3	
																			53	97	
																			51	300	
																			46	300	
																			41	300	
																			36	100	
																			34	88	
																			33	92	
																			31	8	
																			31	3	
																			31	97	
																			30	100	
																			28	100	
																			26	100	
																			25	88	
																			23	92	
																			22	8	
																			21	3	
																			21	97	
																			21	100	
																			20	100	
																			18	100	
																			18	100	
																			16	88	
																			15	92	
																			13	8	
																			13	100	
																			12	100	
																			10	88	
																			8	92	

Wiring Diagram

