

*Frigidaire*

Factory Parts Catalog

Product No.	FDK45P11	FDK45P12	FDL45P11	FDL45P12	FDL60P11	FDL60P12
Series	Dehumidifier	Dehumidifier	Dehumidifier	Dehumidifier	Dehumidifier	Dehumidifier
Color	white	white	white	white	white	white
Volts	115	115	115	115	115	115
Owner's Guide	220261d000	220261d000	220261d000	220261d000	220261d000	220261d000
Market	North America	North America	North America	North America	North America	North America



Electrolux Major Appliances  
 North & Latin America  
 P.O. BOX 212378  
 AUGUSTA, GA 30917

Publication No.  
**5995436747**  
 05/05/20  
 (EN/SERVICE/WC)  
 099

**ROOM DEHUMIDIFIER**

Model No.  
**FDK45P / FDL45P /  
 FDL60P**

Copyright © 2005 Electrolux Home Products, Inc.  
 All rights reserved.

**RECOMMENDED SPARE PARTS**

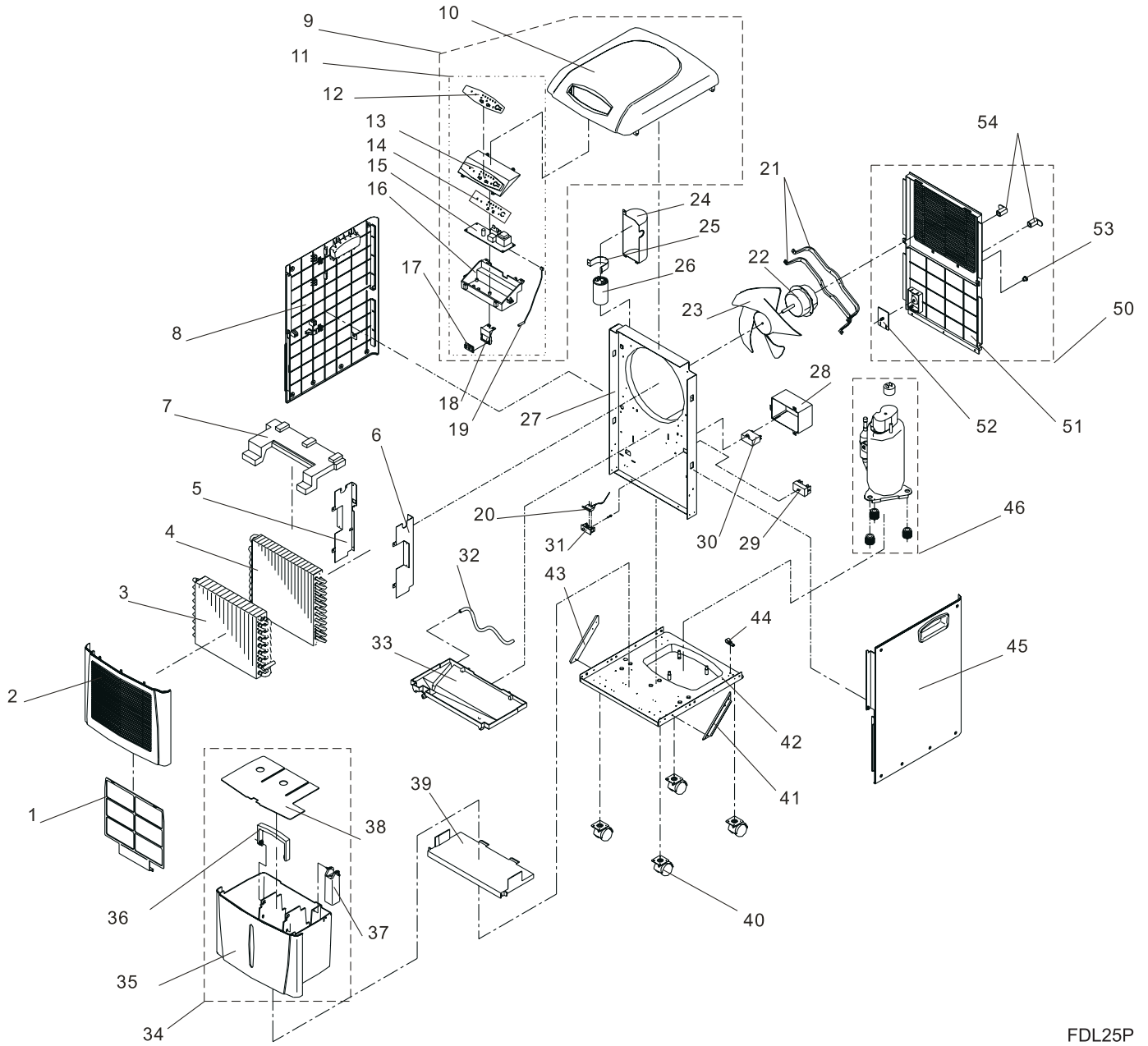

FDL25P

**RECOMMENDED SPARE PARTS**

*Model Index:* A FDK45P (FDK45P11)  
 B FDK45P (FDK45P12)  
 C FDL45P (FDL45P11)  
 D FDL45P (FDL45P12)  
 E FDL60P (FDL60P11)  
 F FDL60P (FDL60P12)

POS. NO	PART NO.						DESCRIPTION	
1	5304447105	A	B	C	D	E	F	Filter, air
2	5304447106	A	B	C	D	E	F	FRONT PANEL ASSEMBLY
3	5304447279	A	B	C	D	-	-	Evaporator
3	5304447347	-	-	-	-	E	F	Evaporator
4	5304447280	A	B	C	D	-	-	CONDENSER-AIR COOL, REC.
4	5304447348	-	-	-	-	E	F	CONDENSER-AIR COOL, REC.
5	5304447109	A	B	C	D	E	F	LEFT CONNECTION BOARD
6	5304447110	A	B	C	D	E	F	RIGHT CONNECTION BOARD
7	5304447111	A	B	C	D	E	F	SEAL, COND/EVAP COIL, FOAM
8	5304447237	A	B	C	D	E	F	Panel-left side
9	5304447238	A	B	C	D	E	F	COVER/TOP CAP ASSEMBLY
10	5304447239	A	B	C	D	E	F	COVER/TOP CAP
11	5304447240	A	B	C	D	E	F	MAIN CONTROL ASSEMBLY
12	5304447241	A	B	C	D	E	F	Overlay-control
13	5304447242	A	B	C	D	E	F	COVER-CONTROL BOX, E-PART BOX
14	5304447243	A	B	C	D	E	F	Display Board
15	5304447244	A	B	C	D	E	F	MAIN CONTROL BOARD
16	5304447245	A	B	C	D	E	F	CONTROL BOX, E-PART BOX COVER
17	5304447246	A	B	C	D	E	F	HUMIDITY SENSOR
18	5304447247	A	B	C	D	E	F	BRACKET, HUMIDITY SENSOR
19	5304447248	A	B	C	D	E	F	EVAPORATOR PIPE TEMP SENSOR
20	5304447249	A	B	C	D	E	F	WATER DEPTH SWITCH, OVERFLOW
21	5304447250	A	B	C	D	E	F	Bracket-fan motor
22	5304447251	A	-	C	-	E	-	FAN MOTOR
22	5304447278	-	B	-	D	-	F	FAN MOTOR
23	5304447252	A	B	C	D	-	-	Blade-fan
23	5304447349	-	-	-	-	E	F	Blade-fan
24	5304447281	A	B	C	D	E	F	COVER, COMPRESSOR CAPACITOR BOX
25	5304447282	A	B	C	D	E	F	STRAP, COMPR CAPACITOR CLAMP
26	5304447283	A	B	C	D	-	-	COMPRESSOR CAPACITOR
26	5304447350	-	-	-	-	E	F	COMPRESSOR CAPACITOR
27	5304447253	A	B	C	D	E	F	Shroud-condenser
28	5304447254	A	B	C	D	E	F	FAN MOTOR CAPACITOR BOX
29	5304447255	A	B	C	D	E	F	TERMINAL-ELECTRIC
30	5304447284	A	B	C	D	E	F	FAN MOTOR CAPACITOR
31	5304447257	A	B	C	D	E	F	WATER DEPTH SWITCH BRACKET
32	5304447258	A	B	C	D	E	F	DRAIN TUBE
33	5304447259	A	B	C	D	E	F	TRAY-DRIP, WATER COLLECTOR
34	5304447260	A	B	C	D	E	F	WATER TANK ASSEMBLY
35	5304447261	A	B	C	D	E	F	Water Tank
36	5304447262	A	B	C	D	E	F	TANK HANDLE
37	5304447263	A	B	C	D	E	F	FLOAT, WATER DEPTH SWITCH PIN
38	5304447264	A	B	C	D	E	F	WATER TANK COVER
39	5304447265	A	B	C	D	E	F	WATER TANK BASE
40	5304447266	A	B	C	D	E	F	Caster

**RECOMMENDED SPARE PARTS**

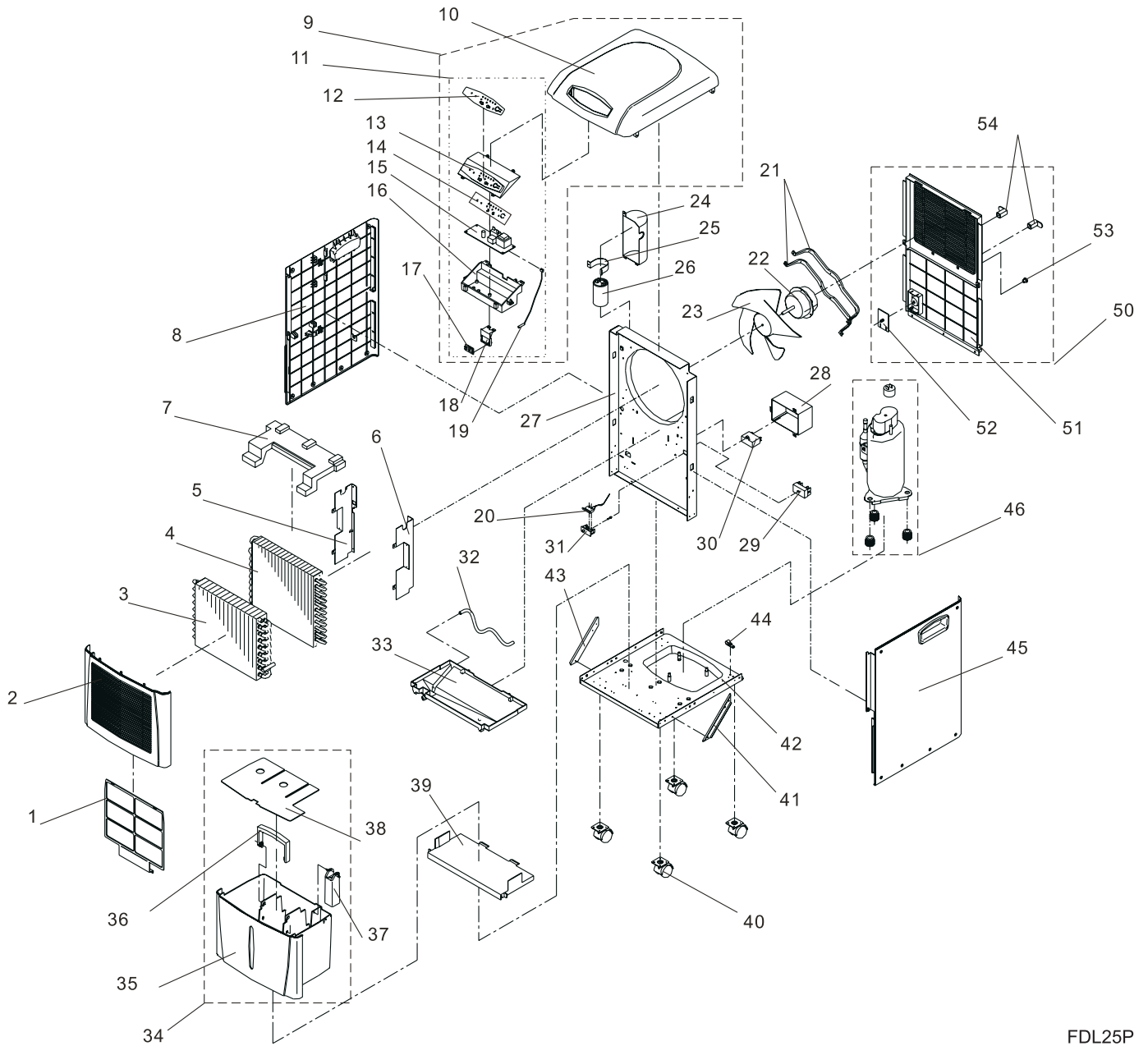

FDL25P

**RECOMMENDED SPARE PARTS**

*Model Index:* A FDK45P (FDK45P11)  
 B FDK45P (FDK45P12)  
 C FDL45P (FDL45P11)  
 D FDL45P (FDL45P12)  
 E FDL60P (FDL60P11)  
 F FDL60P (FDL60P12)

POS. NO	PART NO.							DESCRIPTION
41	5304447267	A	B	C	D	E	F	SUPPORTING BAR 1
42	5304447285	A	B	C	D	E	F	Base
43	5304447269	A	B	C	D	E	F	SUPPORTING BAR II
44	5304447270	A	B	C	D	E	F	POWER CORD CLAMP
45	5304447271	A	B	C	D	E	F	Panel-side
47	5304447286	A	B	C	D	-	-	Compressor
47	5304447351	-	-	-	-	E	F	Compressor Assembly
50	5304447273	A	B	C	D	E	F	REAR PANEL ASSEMBLY
51	5304447274	A	B	C	D	E	F	REAR PANEL
52	5304447275	A	B	C	D	E	F	WATER DRAIN BRACKET
53	5304447276	A	B	C	D	E	F	DRAIN PLUG
54	5304447277	A	B	C	D	E	F	HOLDER, POWER CORD BOBBIN
54*	5304448416	A	B	C	D	E	F	Power Cord

**WIRING DIAGRAM**

**Wiring diagram 2202619052**

